

7

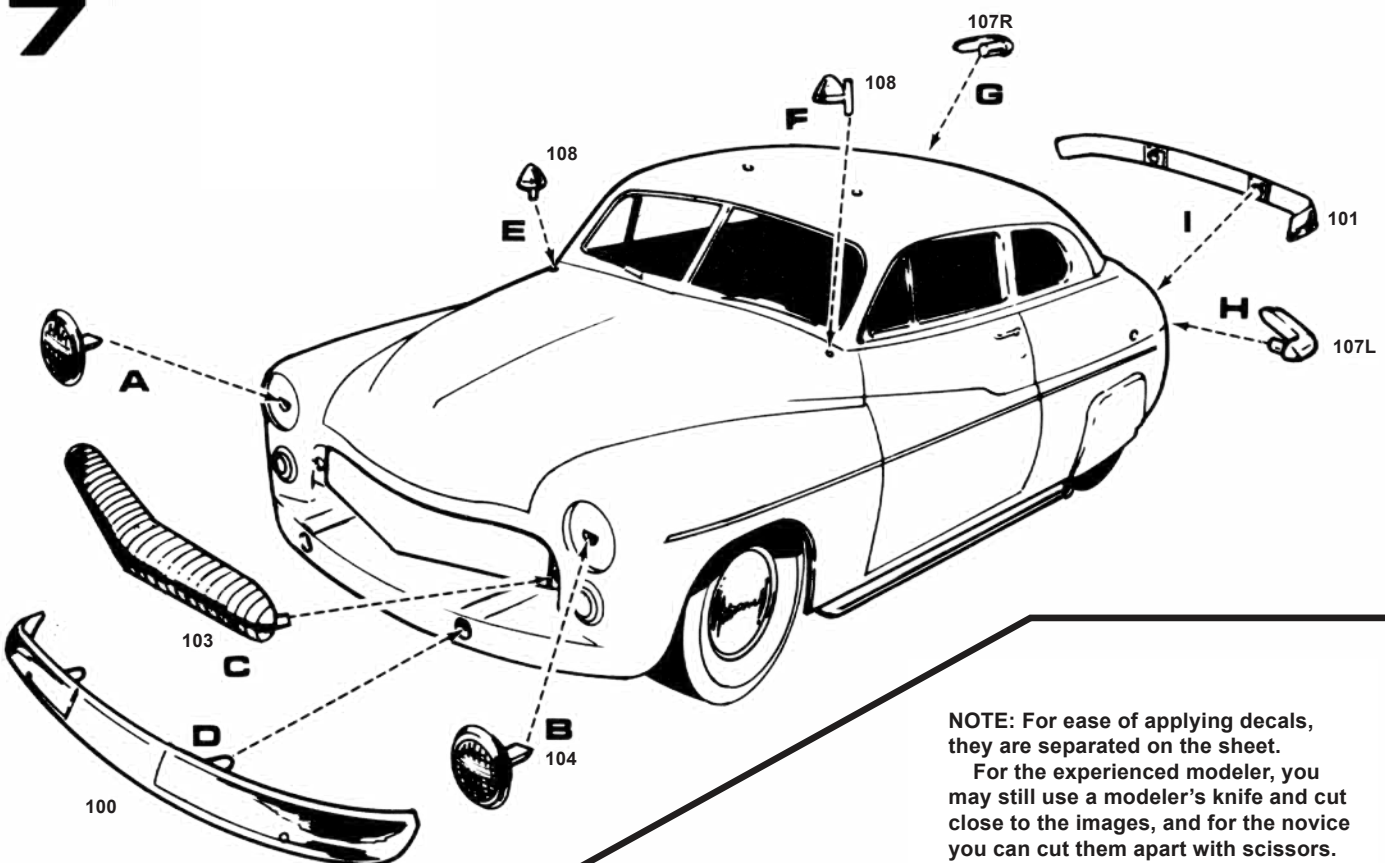

NOTE: For ease of applying decals, they are separated on the sheet.
For the experienced modeler, you may still use a modeler's knife and cut close to the images, and for the novice you can cut them apart with scissors.
When applying decals, be sure to follow the instructions exactly as written. (See back of decal sheet.)

8

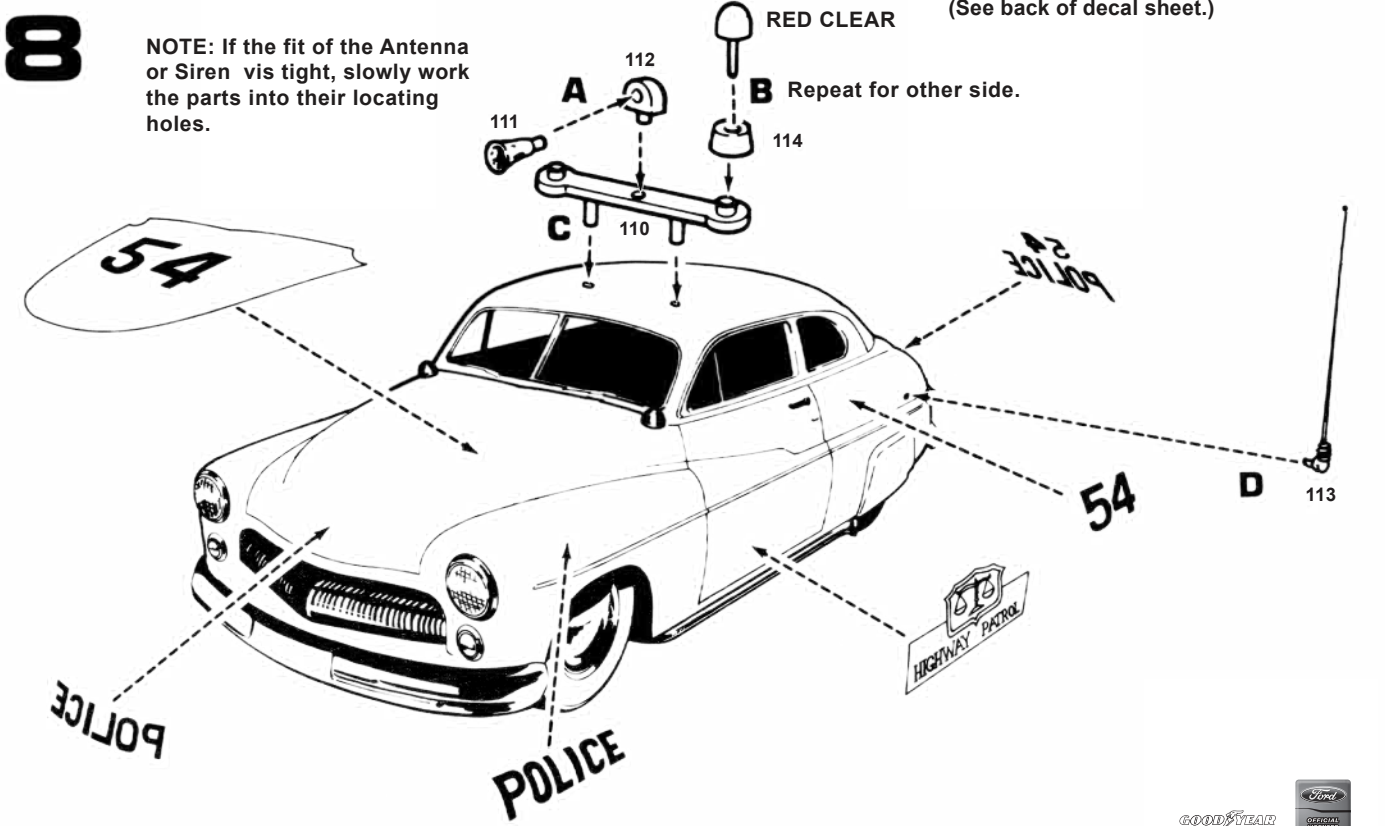

mpc SUPER SNAP

1950 MERCURY

**Snap together...
no cement needed!
Follow numbers &
assembly letters.**

Part Numbers

COLORED: 99 on down • CHROME: 100 on up



1a

front

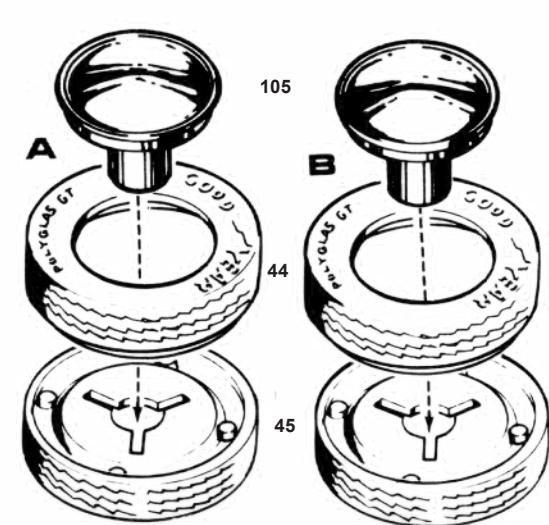

1b

rear

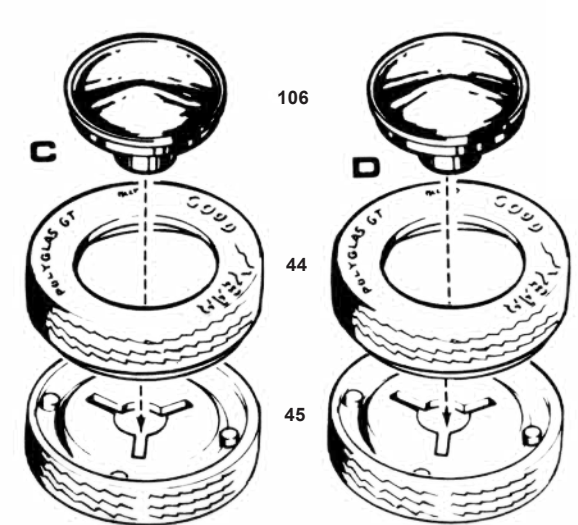

2

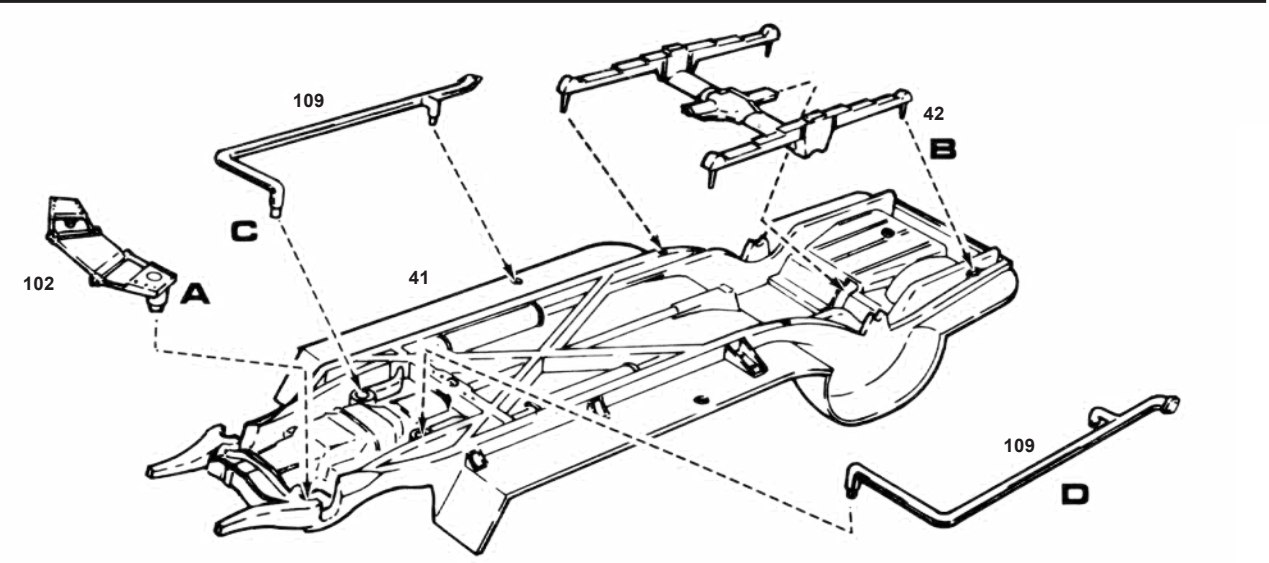

3

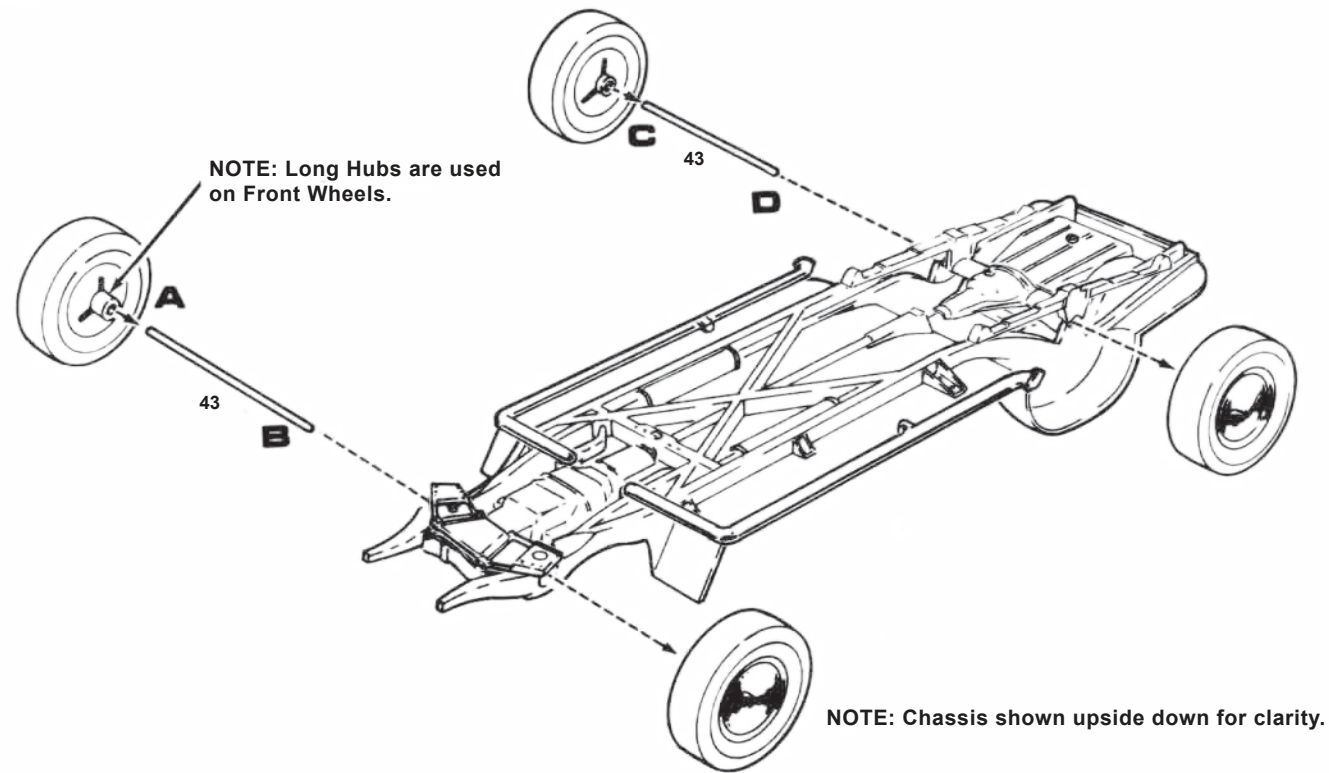

5

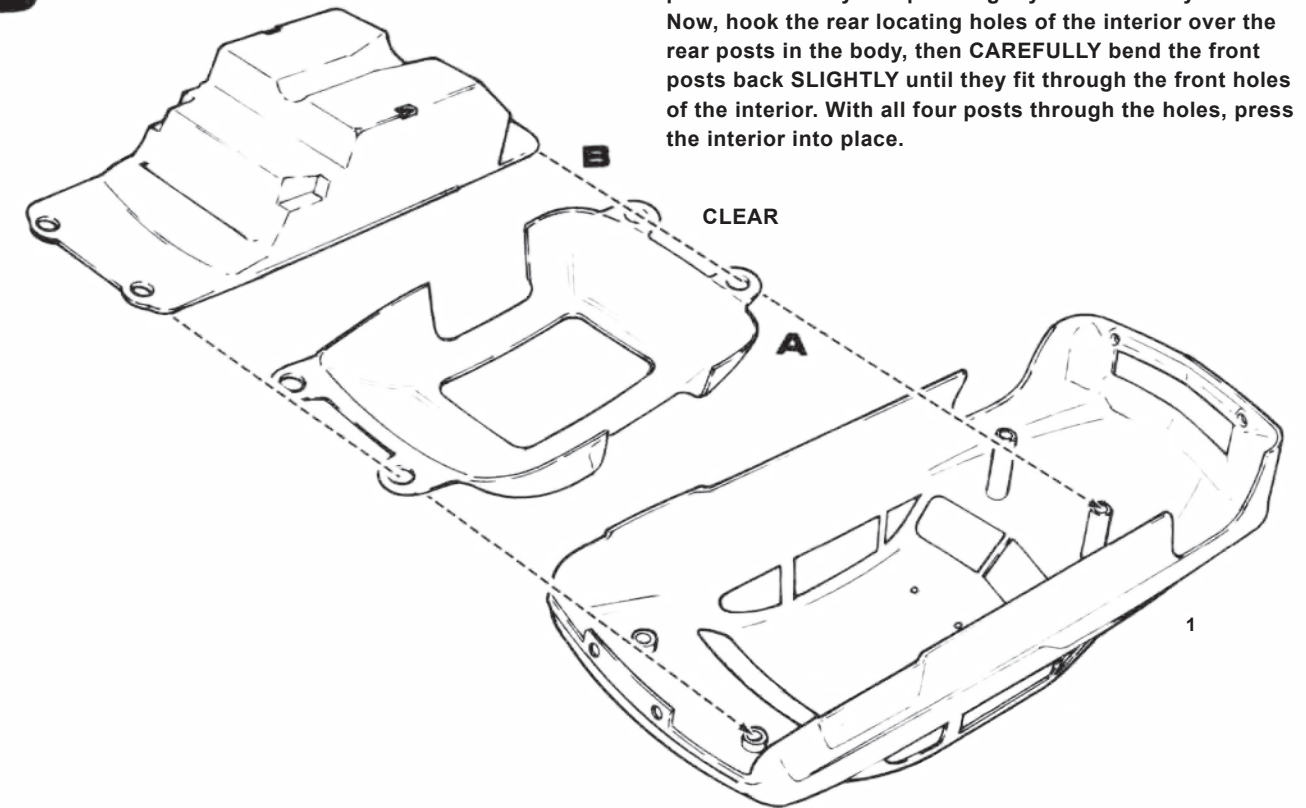

4

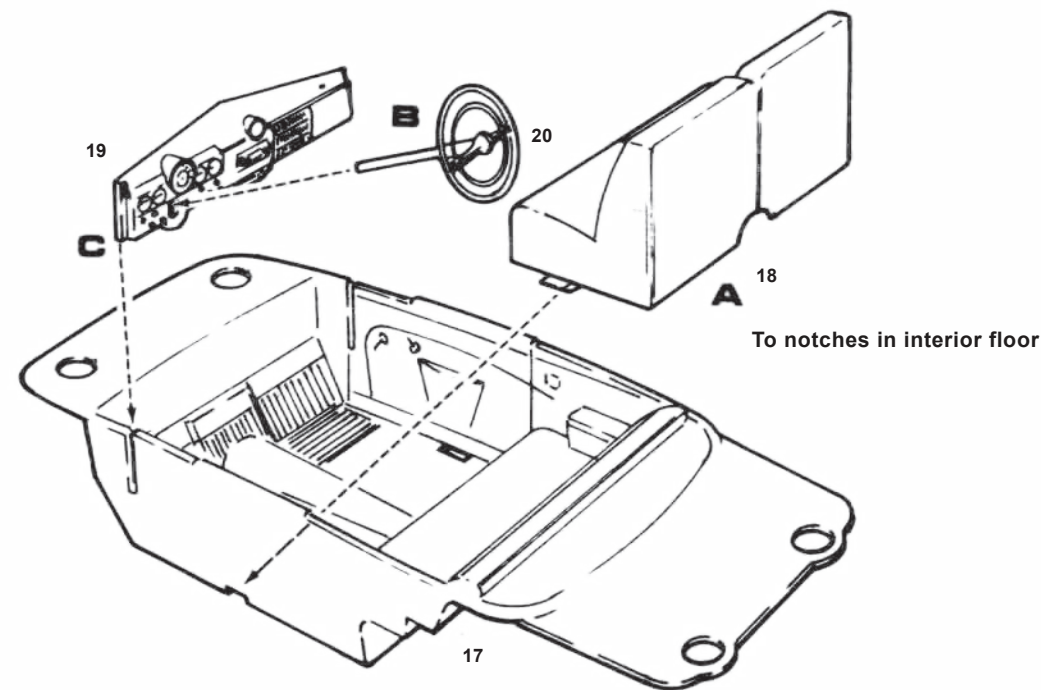

6

