

Super Drag

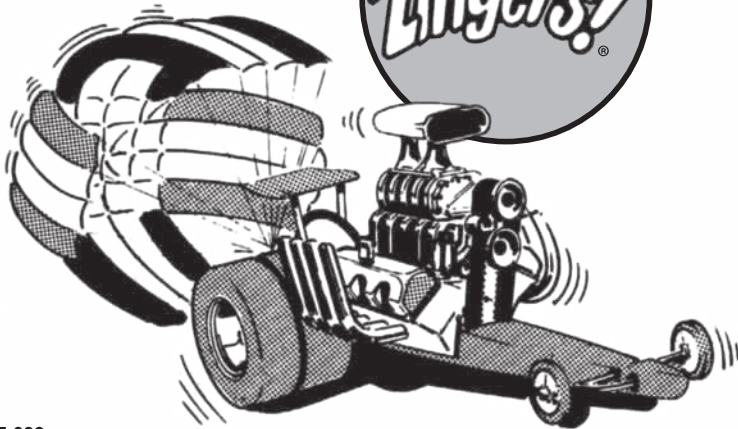

Before you begin building, look over the instructions carefully and test fit parts without cementing. Remove small parts from 'runners' with a modeler's knife, do not twist them off.

MPC kits are made of the highest quality styrene plastic.

Use only paint and cement made for styrene. Be sure that cement is used sparingly.

Trim off excess plastic or 'flash' and scrape plating from chromed parts before joining.

Follow the instructions carefully. The parts are numbered in their assembly order.



Chrome



Black



Body Color

M737-200

1

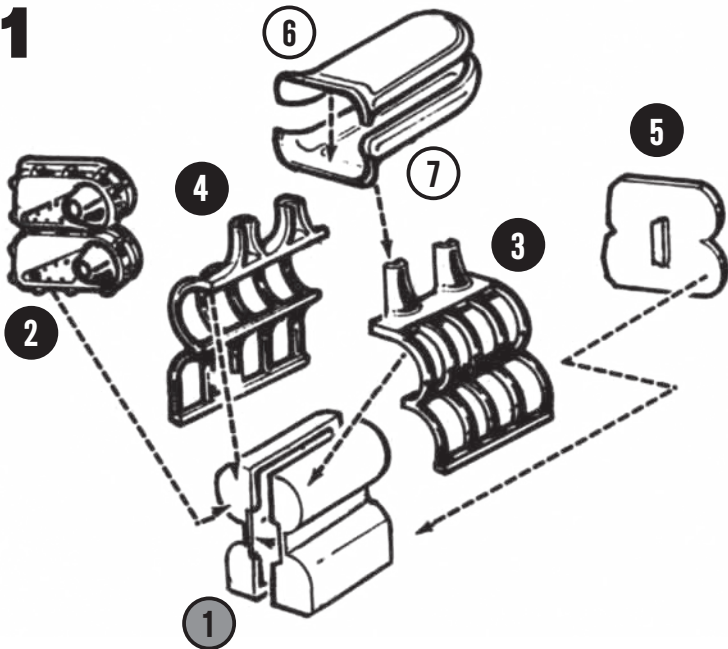

2

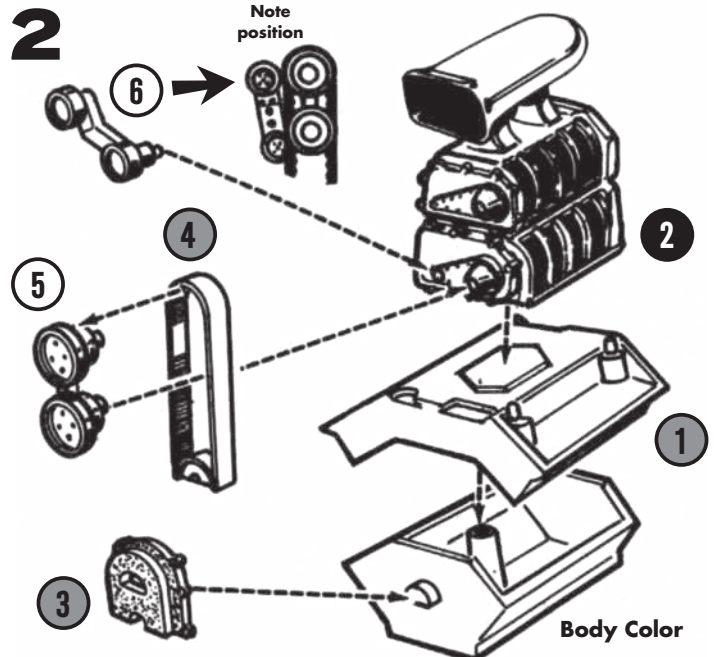

3

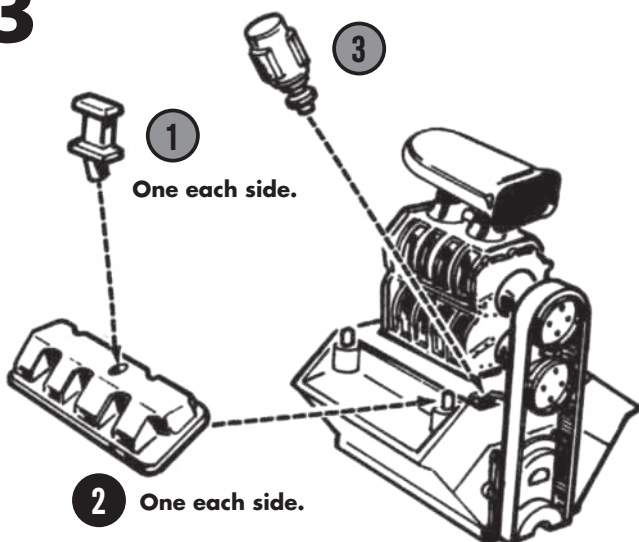

4

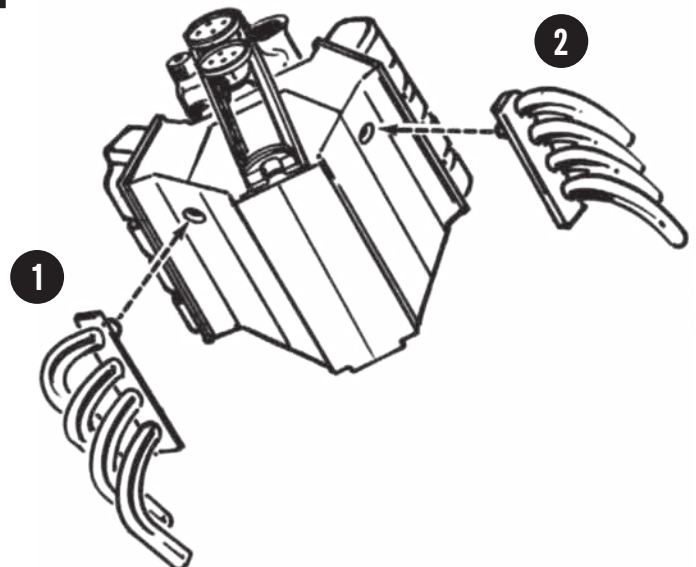

5

NOTE: Make sure the wheel is flush with the tire.

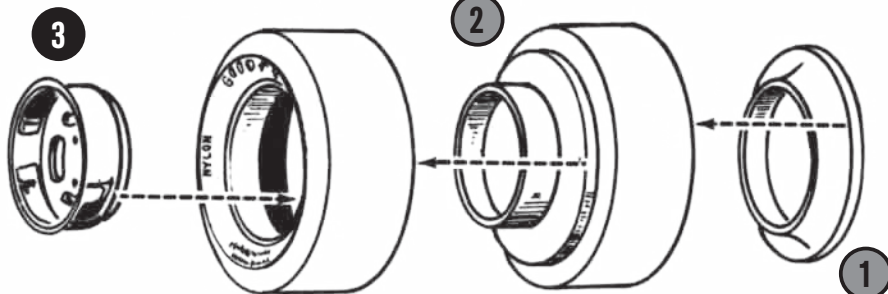
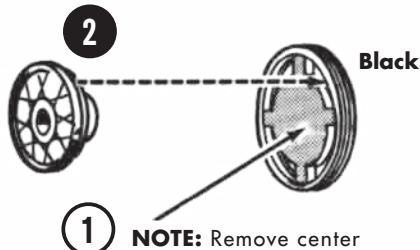

6

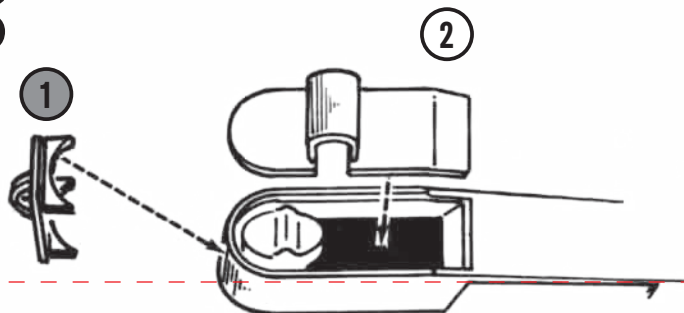

7

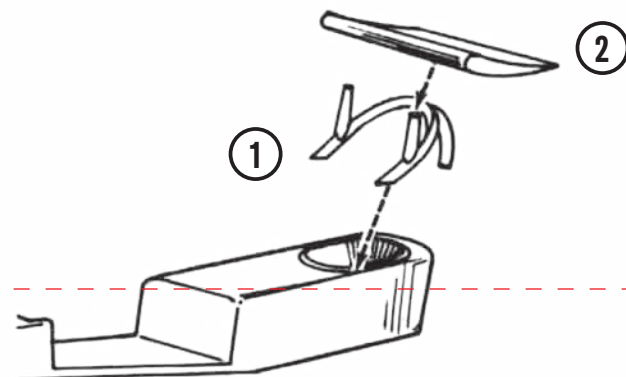

8

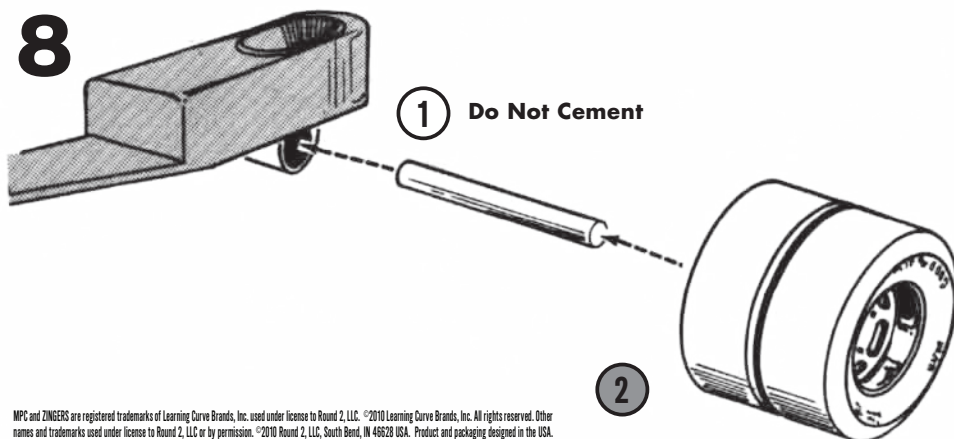

9

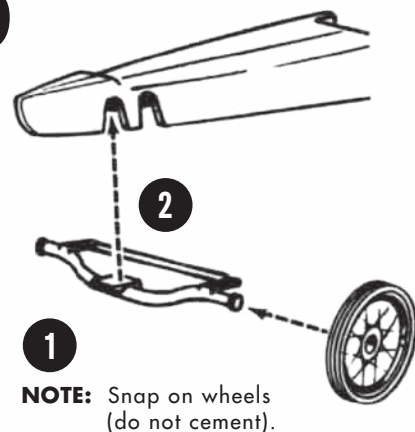

10

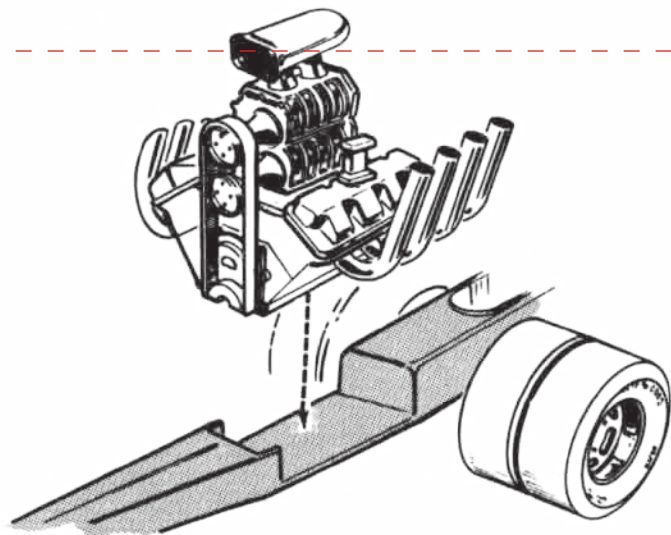

11

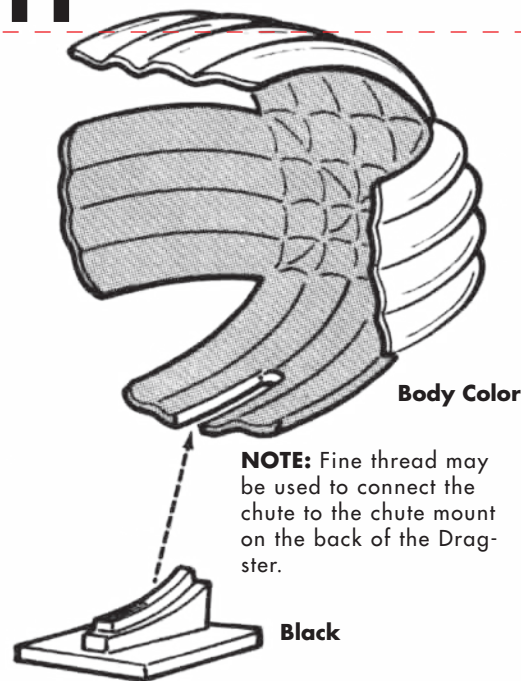

The **ZINGERS**® were taken from an original concept developed in the early 1970s by Denny Johnson, a master model builder during those years. His idea of putting oversized engines and wheels in a smaller scale body was received very well at model contests and custom car shows. MPC's engineering team turned the idea into the ZINGERS series which grew to a total of eight great kits.

It wasn't long before Bob Larivee Sr. of Promotions, Inc. commissioned the highly talented 1:1 custom car creator Chuck Miller (of Styline Customs at the time) to build four of the ZINGERS as "real" vehicles. Chuck built the VW®, Vette®, Super Semi and Super Van ZINGERS.

Steve Tansy, another well known custom car designer, was commissioned to build 1:1 versions of the Super Dune and Super Drag ZINGERS.

These wild "models brought to life", with their half-scale bodies, received wide magazine coverage and toured the country with great interest and excitement following them everywhere they went.

Now, after a 30 year absence, MPC's ZINGERS are back! They are icons of model car history and are just as much fun to build and collect today!

MPC and ZINGERS are registered trademarks of Learning Curve Brands, Inc. used under license to Round 2, LLC. ©2010 Learning Curve Brands, Inc. All rights reserved. Other names and trademarks used under license to Round 2, LLC or by permission. ©2010 Round 2, LLC, South Bend, IN 46628 USA. Product and packaging designed in the USA. Made in China. All rights reserved.