

NOTE: Turn trailer ramps around and locate to end of trailer bed. Do not cement.



5 Repeat steps (1) thru (4) for other side.

DO NOT CEMENT

other side.

NOTE: Locate trailer hitch to trailer ball as shown in illustration. Do not cement.



M753-200

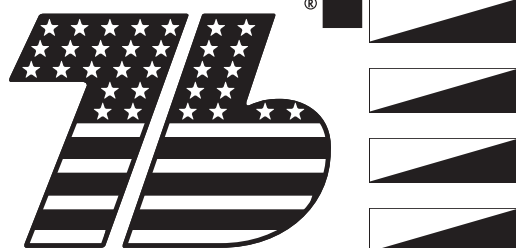

IMPORTANT! READ THIS FIRST

You may build this kit more than one way. Before you begin building, look over the instructions carefully. Following the procedure given, test-fit parts together without cementing, after you have decided what version to build. This way you will be more familiar with the location of parts when it becomes time to use cement.

For removing small parts from the "runners" it is best to use a modeler's knife, do not attempt to "twist" them off.

The highest quality styrene plastic goes into the making of each MPC model. Only paint and cement

made for styrene should be used. Before joining parts, trim off excess plastic or "flash". Scrape plating from chromed parts where they are to be joined with other parts. Be careful not to get cement on exposed areas. To join parts, use cement sparingly. Apply cement to very small parts with a toothpick.

When painting your model it is best to cement all non-chromed accessories to the body and paint the whole unit at one time.

You should have no trouble assembling your kit if the instructions are followed properly.

⑦ NON PLATED PARTS

7 PLATED PARTS

7 PART NUMBERS

-----> CEMENT

**DO NOT
CEMENT**

1 Assemble all four wheels same way.

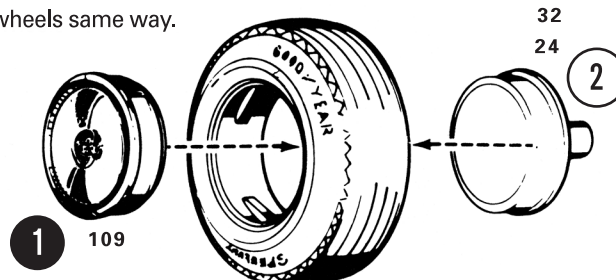

TRAILER

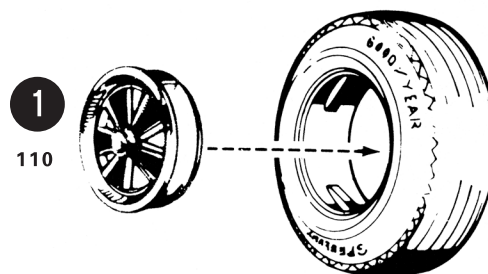

2

4 Locate to hole.

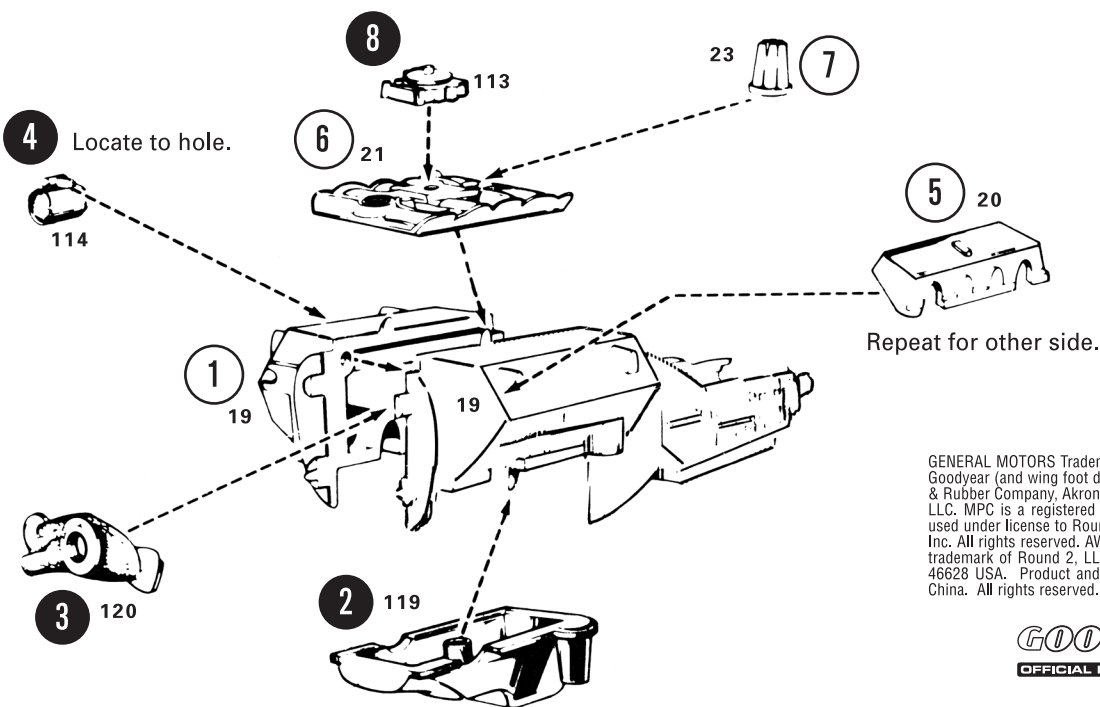

Repeat for other side.

GENERAL MOTORS Trademarks used under license to Round 2, LLC. Goodyear (and wing foot design) is a trademark of The Goodyear Tire & Rubber Company, Akron, Ohio USA used under license by Round 2, LLC. MPC is a registered trademark of Learning Curve Brands, Inc. used under license to Round 2, LLC. ©2010 Learning Curve Brands, Inc. All rights reserved. AW AUTO WORLD and design is a registered trademark of Round 2, LLC. ©2010 Round 2, LLC, South Bend, IN 46628 USA. Product and packaging designed in the USA. Made in China. All rights reserved.

GOODYEAR
OFFICIAL LICENSED PRODUCT

visit us at **Round2Models.com**

