

10.

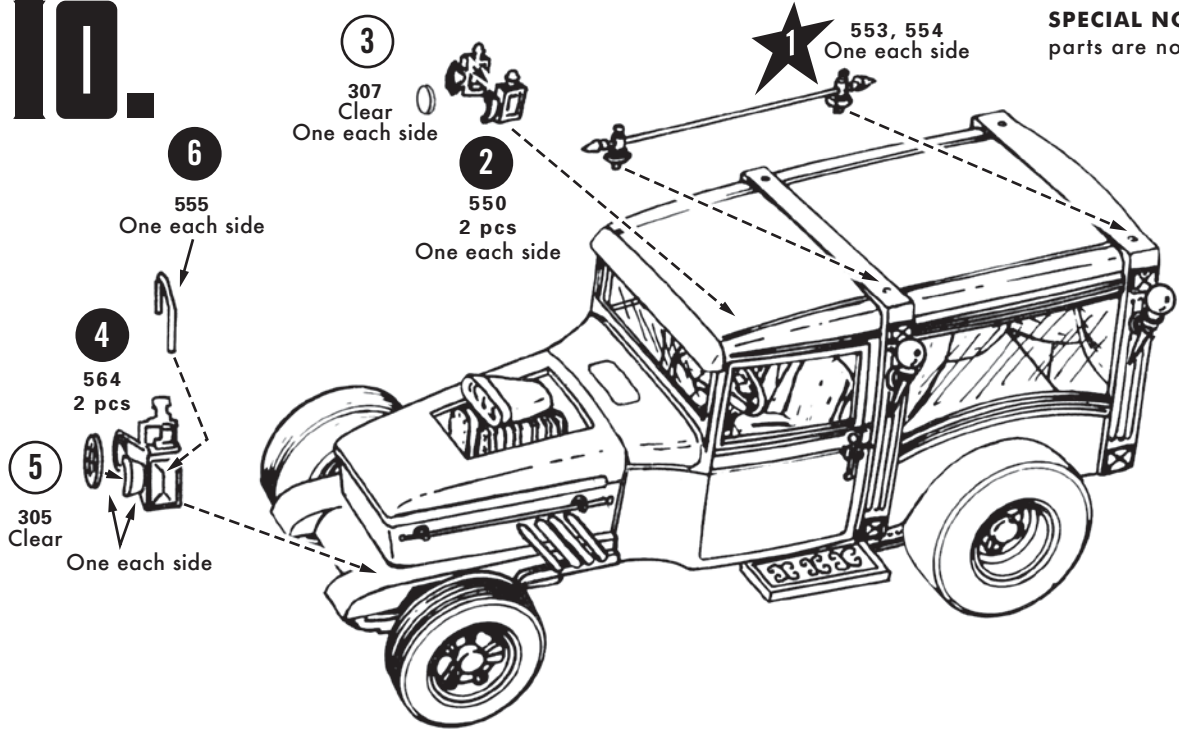

SPECIAL NOTE: Some duplicated parts are not shown for clarity.



IMPORTANT!

Before you begin building look over the instructions carefully. Following the procedure given, test-fit parts together without cementing. This way you will be more familiar with the location of parts when it becomes time to use cement.

For removing small parts from the "runners," it is best to use a modelers knife, do not attempt to "twist" them off.

The highest quality styrene plastic goes into the making of each MPC model. Only paint and cement made for styrene should be used. Before joining parts, trim off excess plastic or "flash." Scrape plating from chromed parts where they are to be joined with other parts. Be careful not to get cement on exposed areas. To join parts, use cement sparingly. Apply cement to very small parts with a toothpick.

When painting your model it is best to cement all non-chromed accessories to the body and paint the whole unit at one time.

You should have no trouble assembling your kit if the instructions are followed properly. The parts are numbered in order of assembly.

BARNABAS

VAMPIRE VAN



BEFORE YOU BEGIN GET YOUR TOOLS READY:



11.

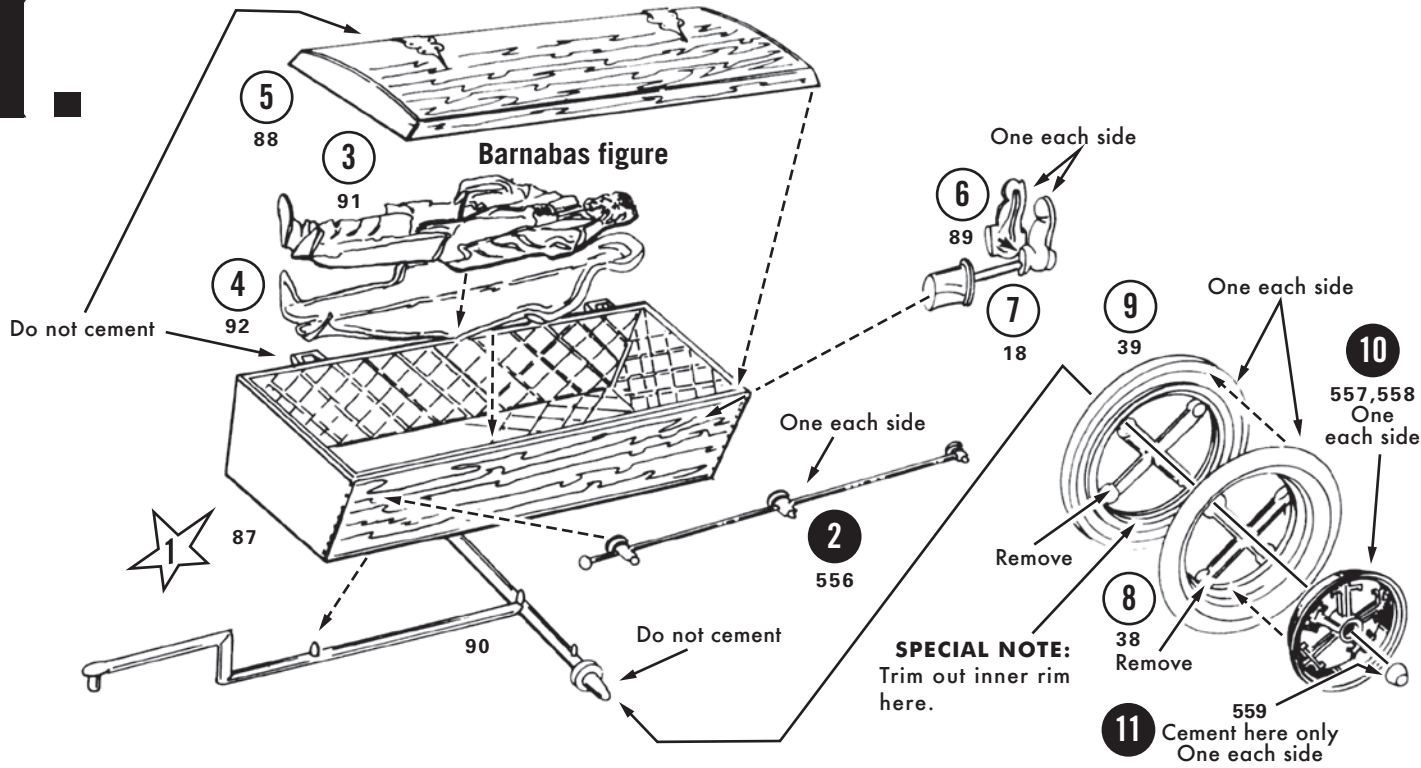

IS BARNABAS YOUR BAG?
LOOK FOR OTHER GREAT MPC
DARK SHADOWS KITS.
GET 'EM ALL FROM YOUR LOCAL HOBBY SHOP.

©Dan Curtis Productions, Inc. All rights reserved. Goodyear (and wing foot design) is a trademark of The Goodyear Tire & Rubber Company, Akron, Ohio USA used under license by Round 2, LLC. Other names and trademarks used under license to Round 2, LLC or by permission. MPC is a registered trademark. © 2011. Round 2 and design is a trademark of Round 2, LLC. © 2011 Round 2, LLC, South Bend, IN 46628 USA. Product and packaging designed in the USA. Printed in China. All rights reserved.

**BARNABAS
FIGURE
MPC757/12**



**WEREWOLF
FIGURE
MPC758/12**



1.

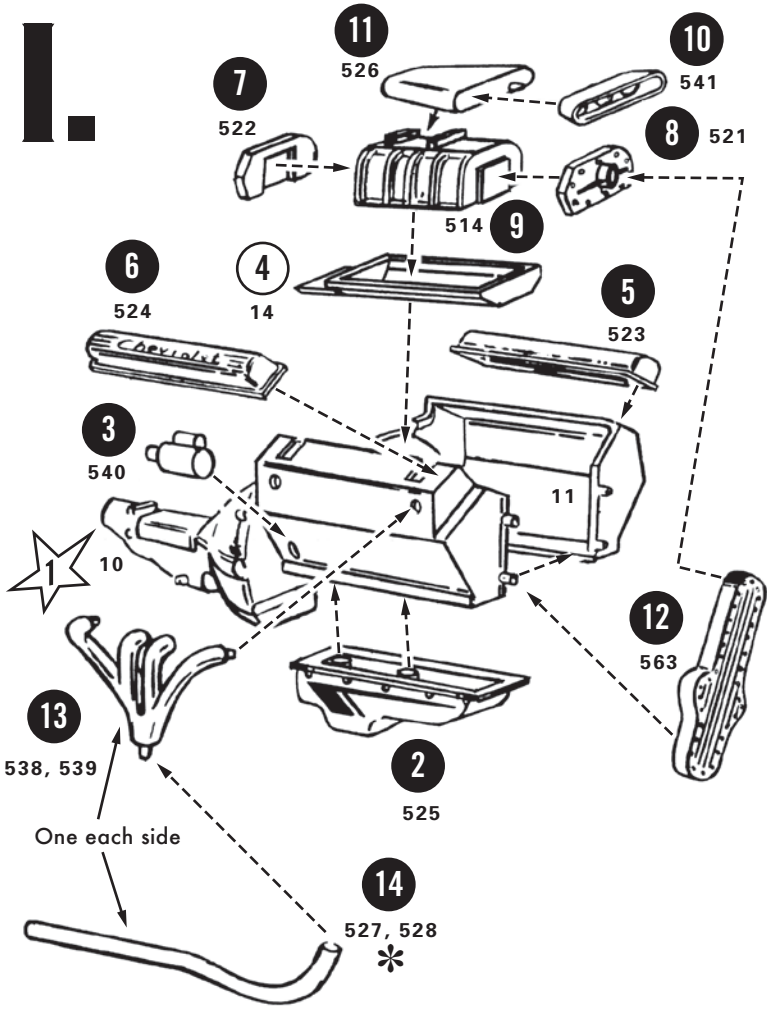

* **NOTE:** Cement to engine after engine is in chassis.

2.

FRONT

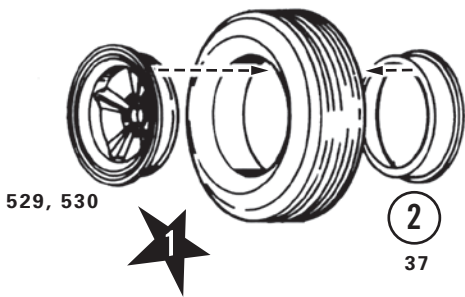

REAR

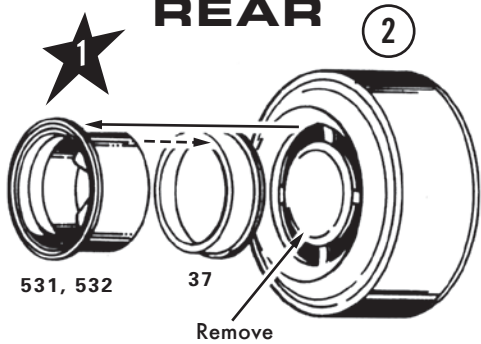

CUSTOM-ADE

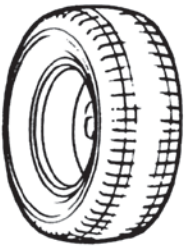

AUTHENTIC TIRES
Many modelers spend countless hours finishing the body, interior, and chassis of a kit, and completely overlook the tires. Authentic tires may be the final touch that makes your model a champion. A piece of fine sandpaper is all you need. To add a "slightly used" look, remove the surface gloss from the tread area only. For older, worn out tires, rough up both the tread and sidewalls, then sand away the center tread design, evenly, all the way around the tire.

CLIP and SAVE

3a

Apply cement to spindles, spread and place over pins on front axles, before cement dries. **DO NOT GET CEMENT ON PINS.** Spindles should be free to turn.

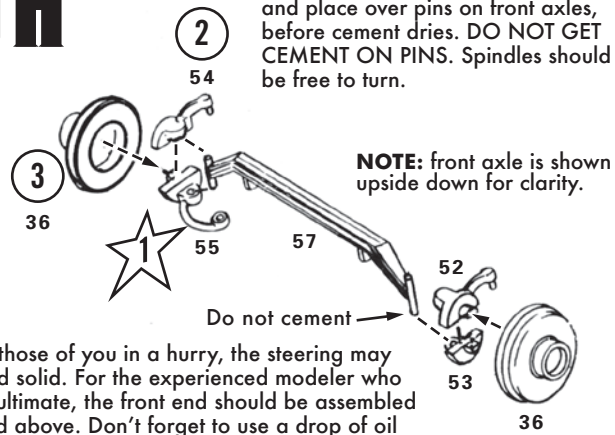

NOTE: For those of you in a hurry, the steering may be cemented solid. For the experienced modeler who desires the ultimate, the front end should be assembled as described above. Don't forget to use a drop of oil or Vaseline on all moving parts.

B

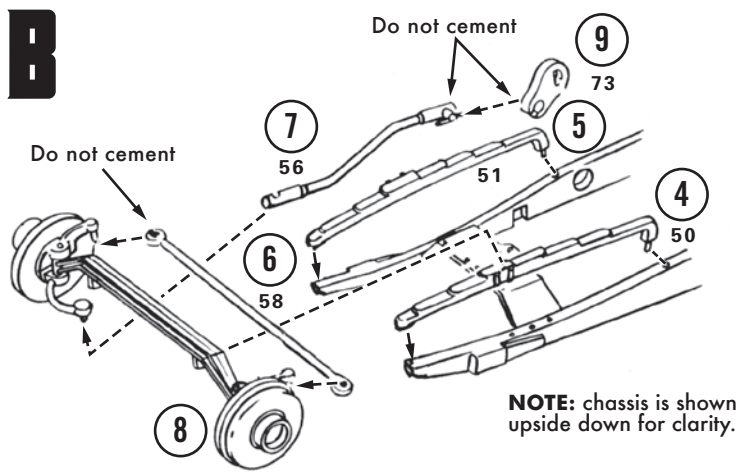

5.

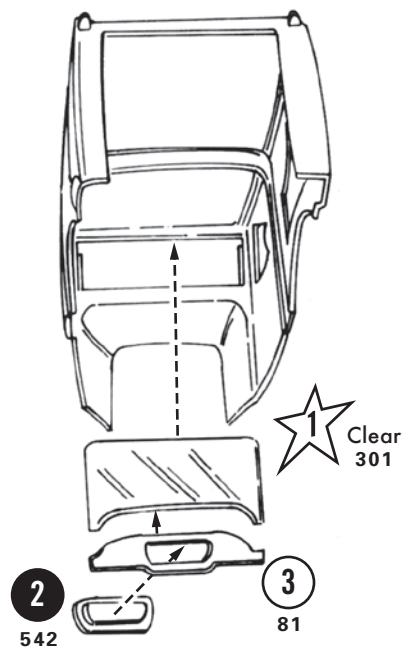

6.

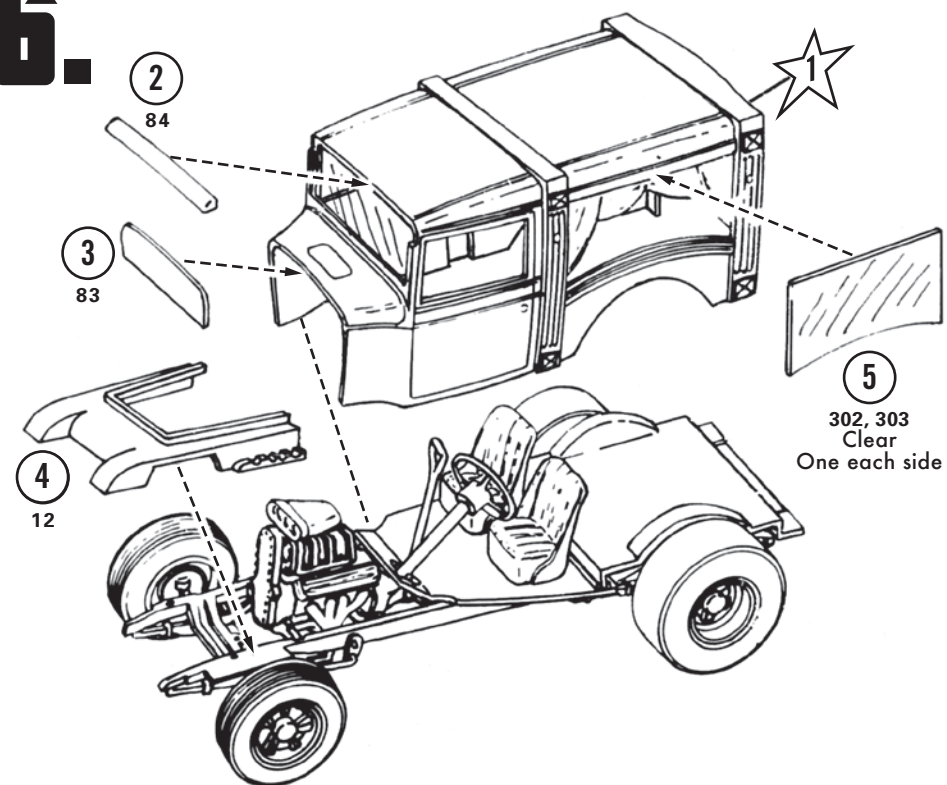

C

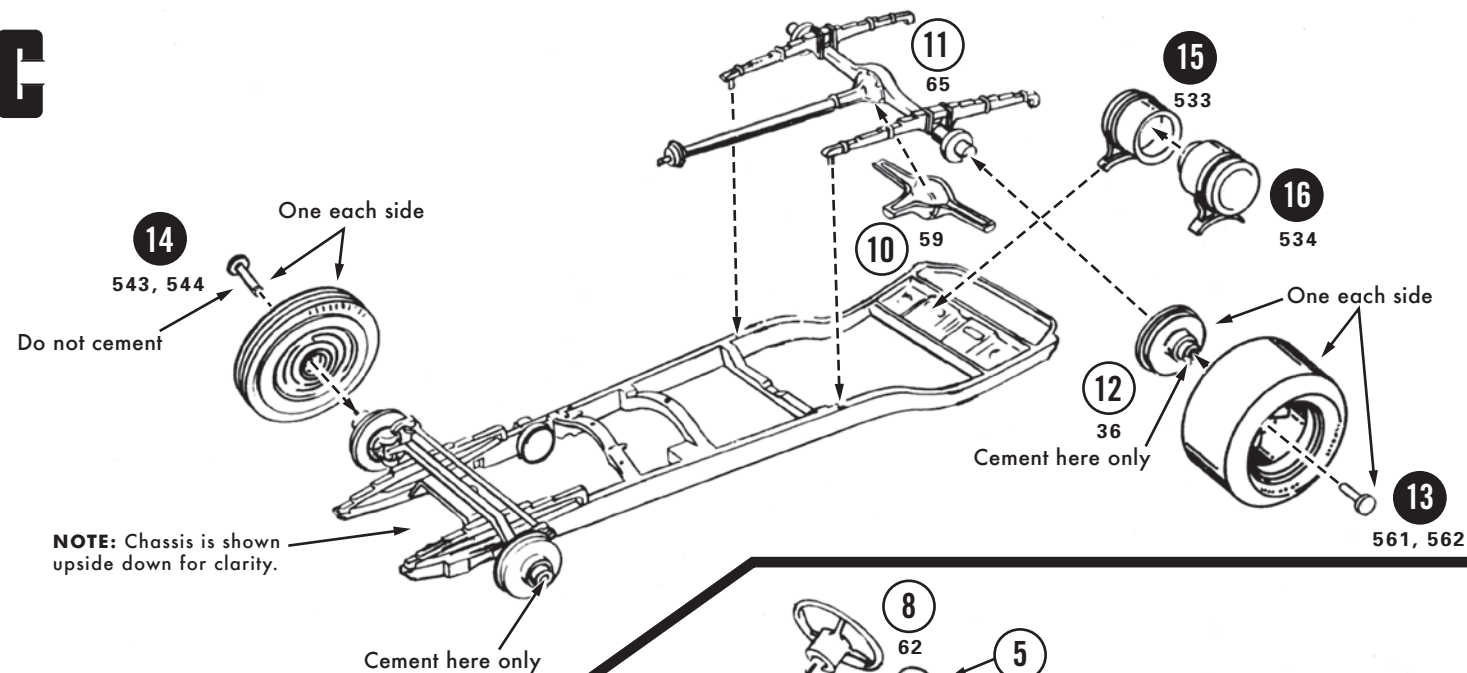

4a

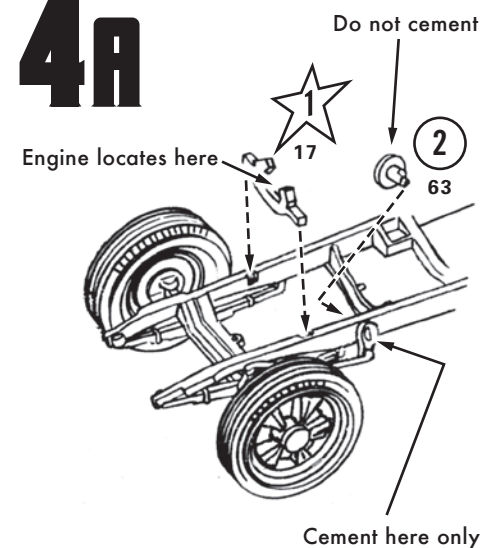

B

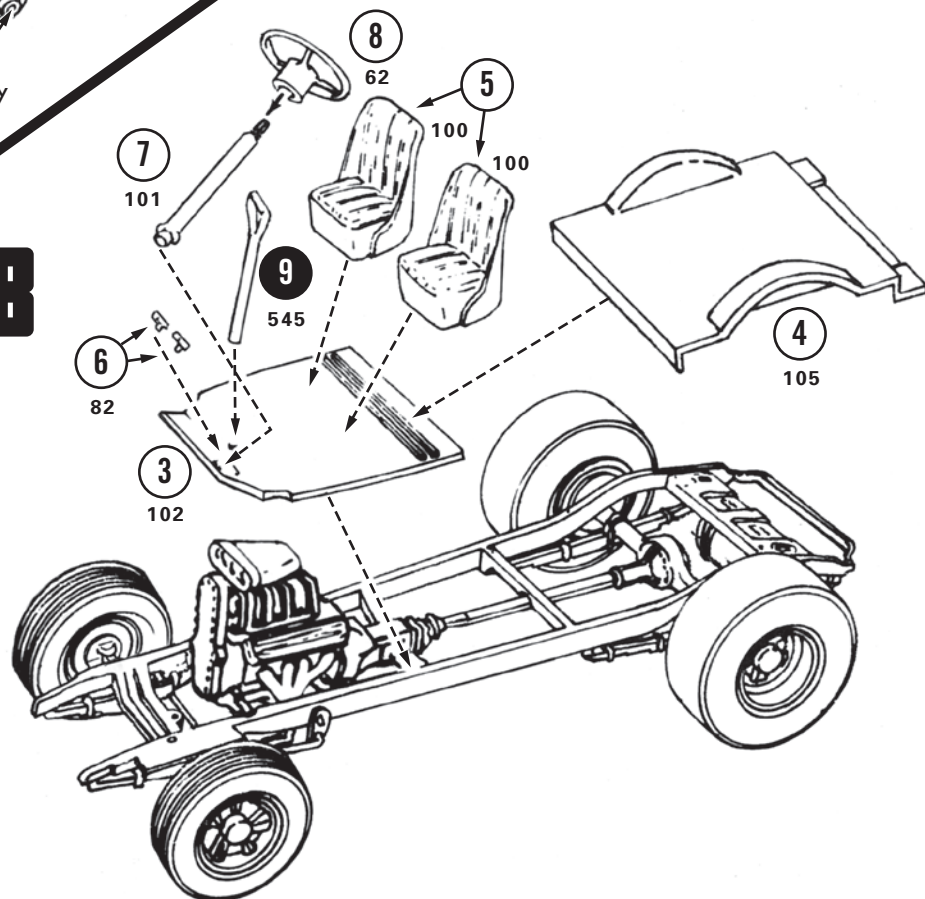

7.

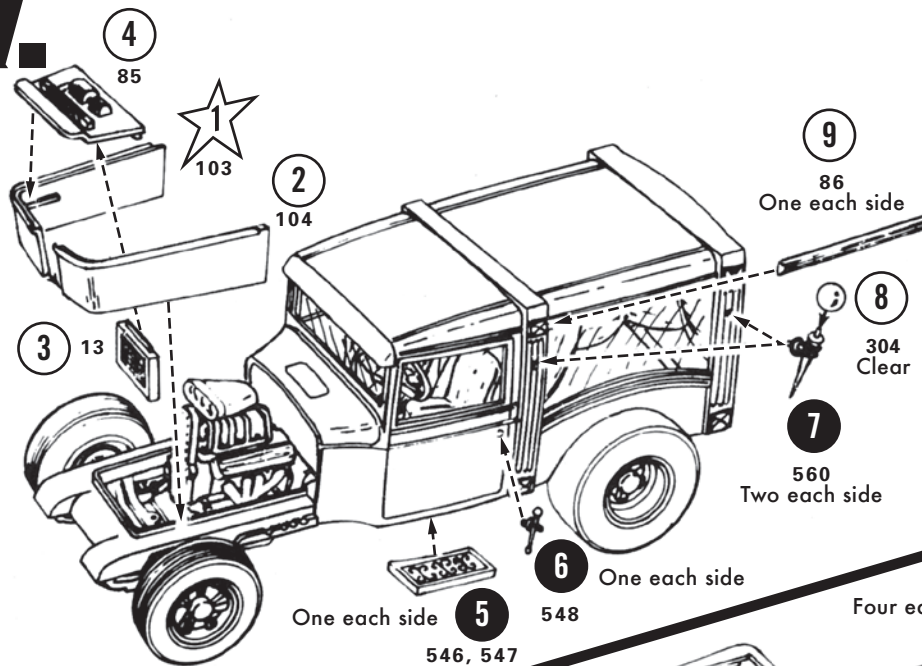

8.

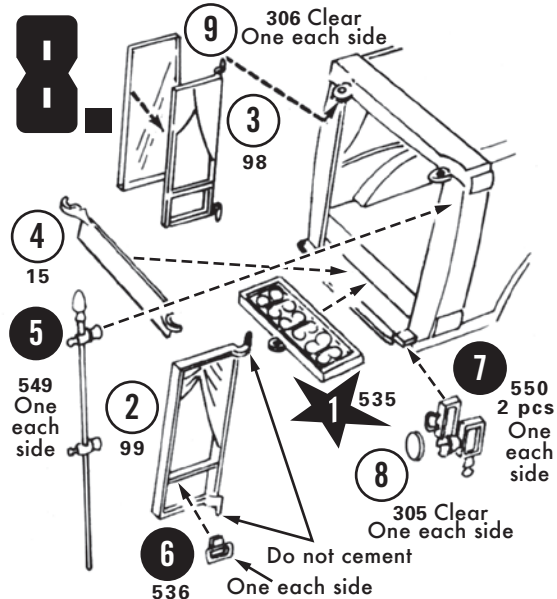

9.

