

Do Not Cement

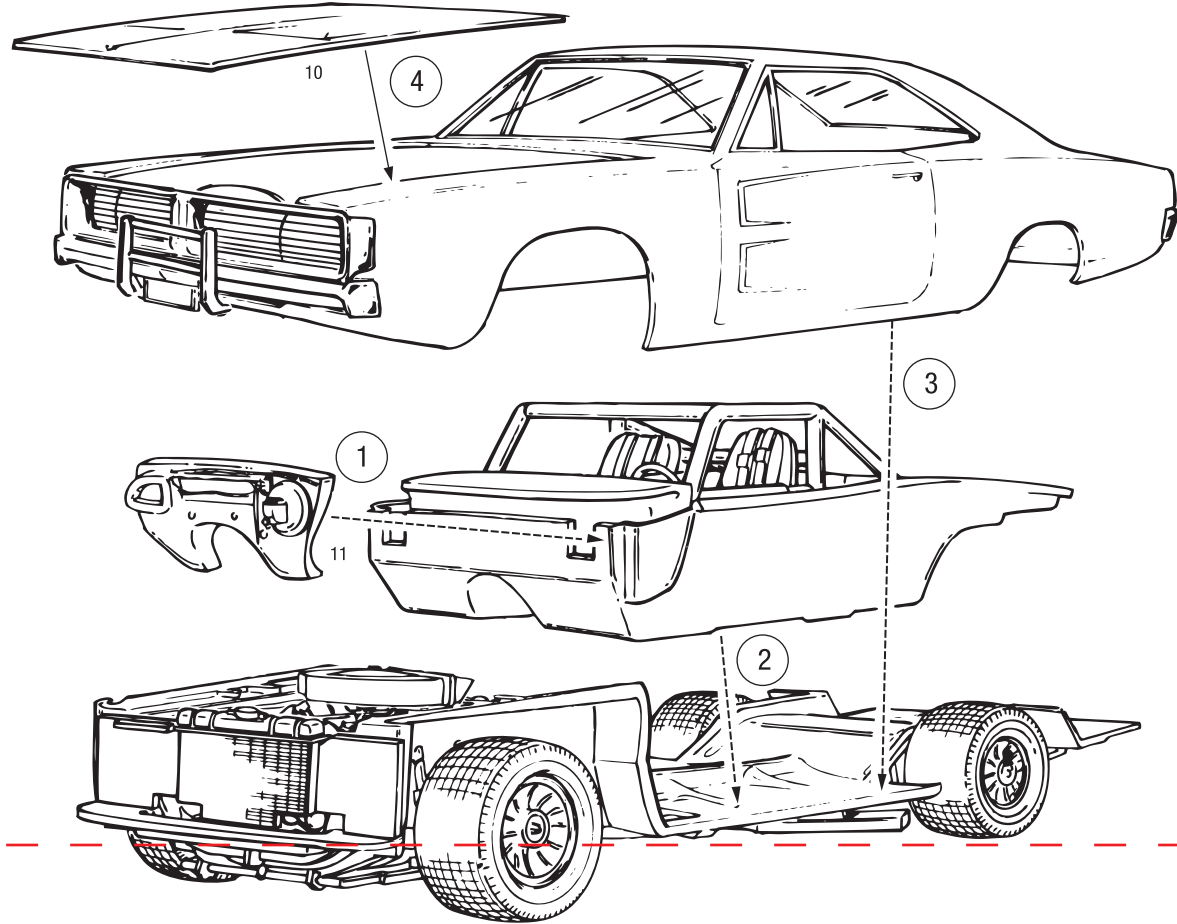

THE DUKES OF HAZZARD™

General Lee DODGE CHARGER

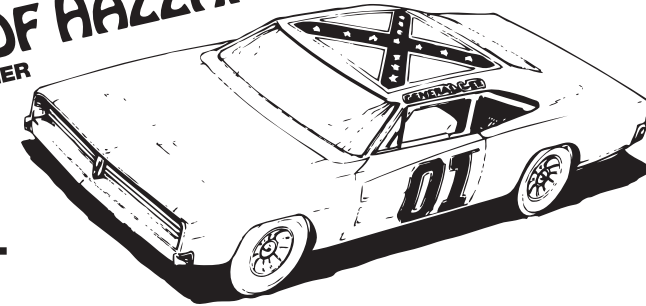

SPECIAL EDITION

IMPORTANT! READ THESE INSTRUCTIONS FIRST.

Before you begin building your kit, read the instructions and study the illustrations carefully. Test fit the parts before cementing them together, to acquaint yourself with their proper location. It is best to cut the parts from the "runners" with a modelers knife instead of twisting them off. Cut the parts only as they're needed. Only paint and cement made for styrene should be used. Trim

off excess plastic or "flash". The plating should be scraped from chromed parts where they are to be cemented. Use cement sparingly. Apply cement to small parts with a toothpick. When painting your model it is best to cement all non-chromed parts to the body and paint the whole unit at one time.



M766-200

STEP NUMBER FOR CHROMED PARTS 10

STEP NUMBERS FOR NON-CHROMED PARTS 10

PART NUMBERS 37

CEMENT ----->

DO NOT CEMENT ----->

CLEAR PLASTIC PARTS CLEAR

RED CLEAR PLASTIC PARTS RED CLEAR

1



1

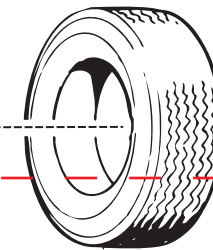

Do Not Cement

2

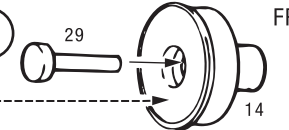

FRONT (2X)

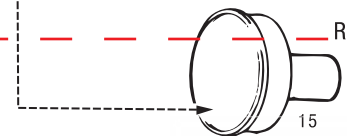

REAR (2X)

DECALS

NOTE: For ease of applying your decals, they are separated on the sheet. For the experienced modeler, you may still use a modelers knife and cut close to the image, and for the novice you can cut them apart with scissors.

NOTE: Refer to box cover illustration for additional information on decal location.

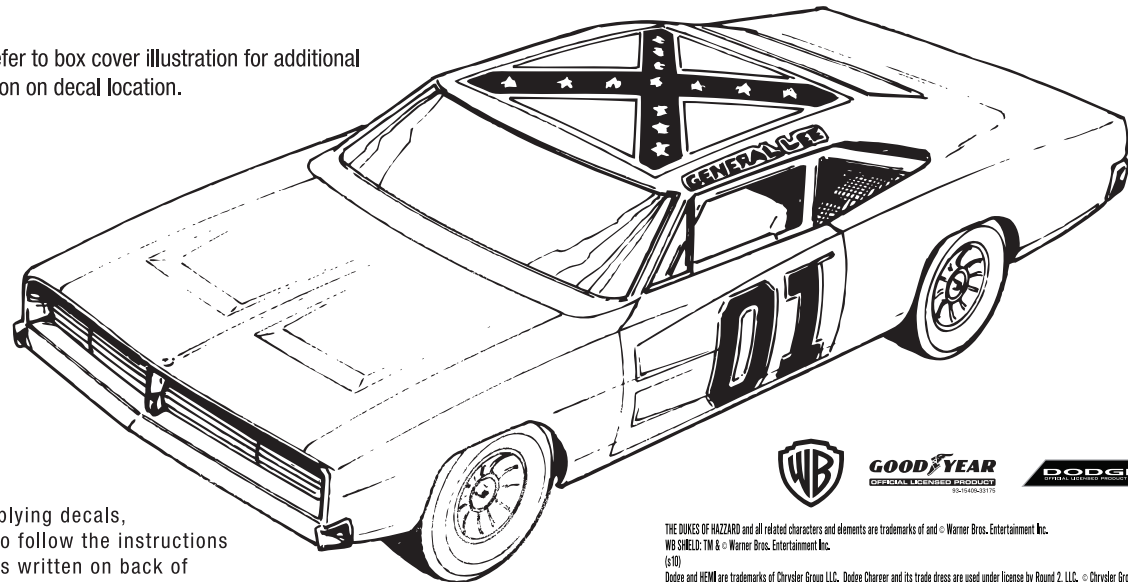

THE DUKES OF HAZZARD and all related characters and elements are trademarks of and © Warner Bros. Entertainment Inc. WB SIMELD: TM & © Warner Bros. Entertainment Inc. (S10)
 Dodge and HEMI are trademarks of Chrysler Group LLC. Dodge Charger and its trade dress are used under license by Round 2, LLC. © Chrysler Group LLC 2010. Goodyear (and wing foot design) is a trademark of The Goodyear Tire & Rubber Company, Akron, Ohio USA used under license by Round 2, LLC. MPC is a registered trademark of Learning Curve Brands, Inc. used under license to Round 2, LLC. ©2010 Learning Curve Brands, Inc. All rights reserved. ©2010 Round 2, LLC, South Bend, IN 46628 USA. Product and packaging designed in the USA. Made in China. All rights reserved.

When applying decals, be sure to follow the instructions exactly as written on back of decal sheet.

2



4



3

Repeat for other side.



6



5

8



OPTIONAL DUAL-CARB SETUP

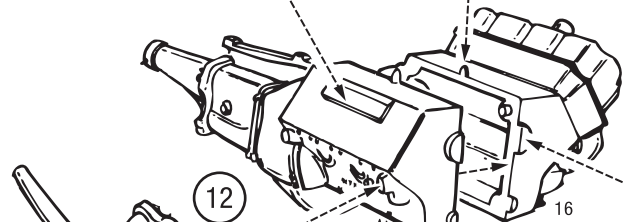
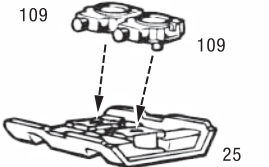

Repeat for other side.

108



9

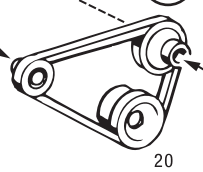

10

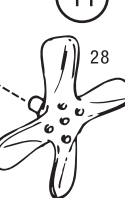

11

