



Street Charger

GENERAL INSTRUCTIONS

This kit is molded of the highest quality styrene plastic and vinyl. Only cement and paints designed for styrene should be used. Extreme care while constructing, patience and practice will result in a beautiful and superbly detailed model kit.

Look over this booklet carefully. Read all notes and study the illustrations. Many hours of research and development have been applied in order to make this kit simple and interesting.

Procedures:

1. When attaching plated parts together or to non-plated surfaces, scrape plating from contact points to allow strong binding of these parts.
2. Painting of parts and components is recommended. Before assembling painted parts, scrape paint from contact points to allow strong binding of these parts.
3. All parts are numbered. Numbered are engraved on the runners next to the parts.
4. As you build this kit, work assembly by assembly in order. Do not skip around. If you have difficulty, go back and reread step by step. Use care, check alignment, use cement sparingly, take your time and have fun.

1/16 DODGE CHARGER

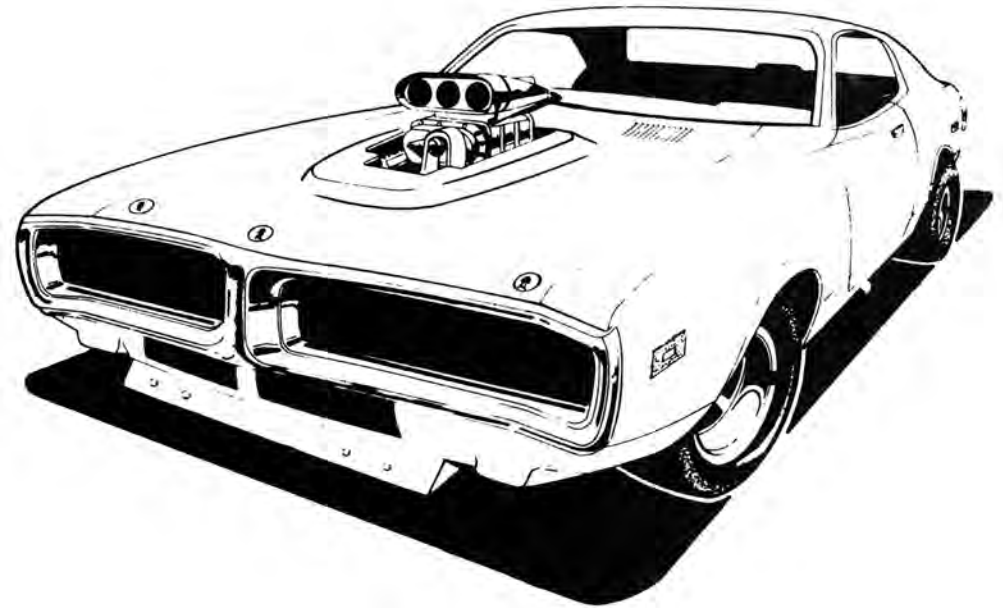

ASSEMBLY GUIDE

① NON PLATED ① PLATED ① CLEAR 1 PART NUMBER

TOOLS TO HELP ASSEMBLY (Not Included)

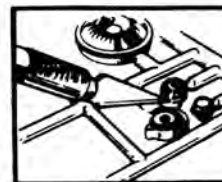

MODELERS KNIFE
To detach and trim.

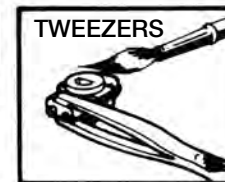

TWEEZERS
To pick up, hold and locate small parts.



TOOTHPICKS
For applying cement to small parts.



SCREWDRIVER
Heat seal pins for movable parts.



Dodge, HEMI, vehicle nameplates and trade dress are trademarks of Chrysler Group LLC and used under license by Round 2, LLC.
© Chrysler Group LLC 2011. Goodyear (and wing foot design) is a trademark of The Goodyear Tire & Rubber Company, Akron, Ohio USA used under license by Round 2, LLC. MPC is a registered trademark. ©2011. All rights reserved. ©2011 Round 2, LLC, South Bend, IN 46628 USA.
Product and packaging designed in the USA. Made in China. All rights reserved.

1

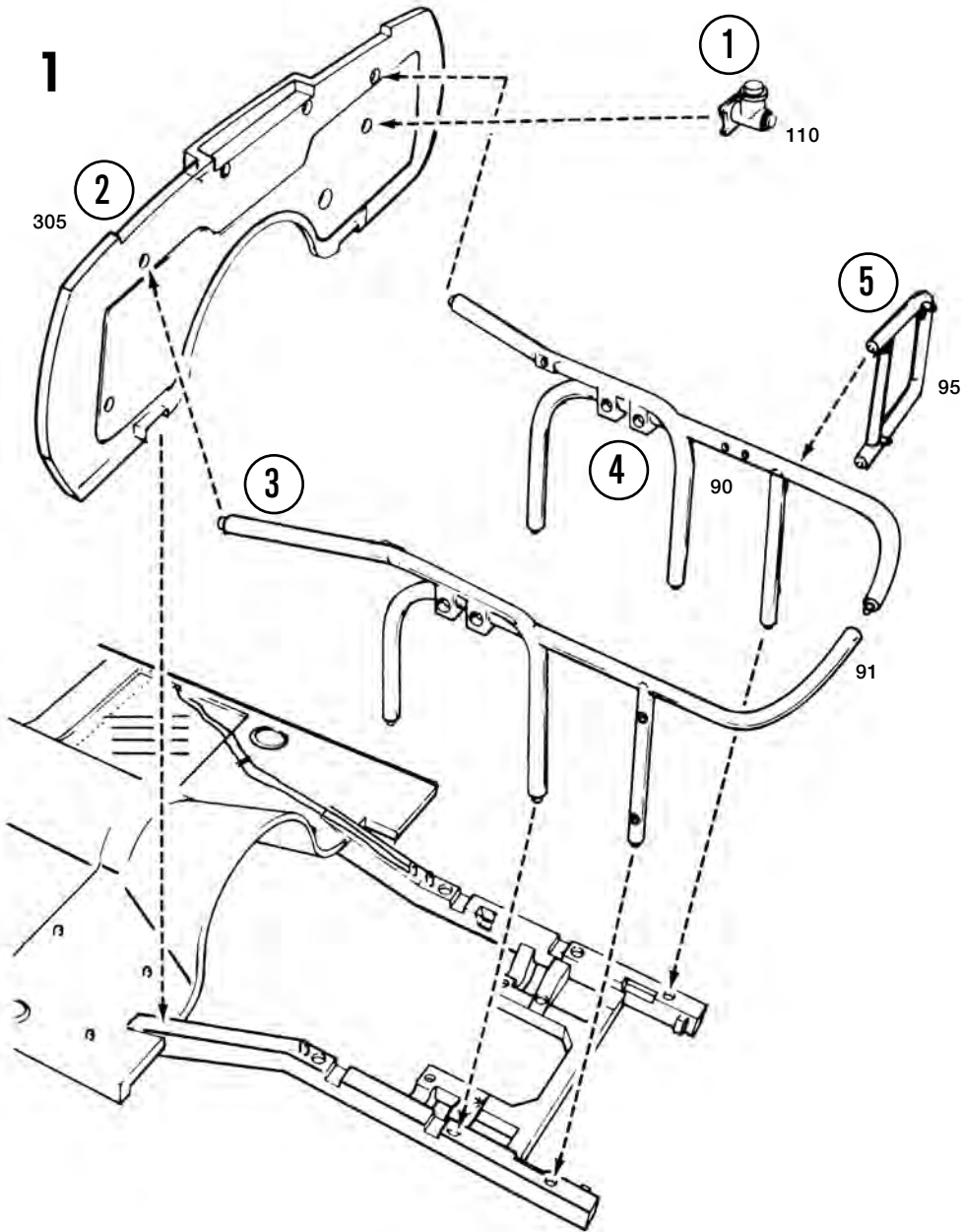

1. Master Cylinder
2. Firewall
3. Right Shock Tower
4. Left Shock Tower
5. Fender Brace

2

1. Control Arm Retainer
- 2 & 3. Upper Control Arm Brackets
- 4 & 5. Lower Arm Control
6. Torsion Bar
8. Radiator Expansion Tank

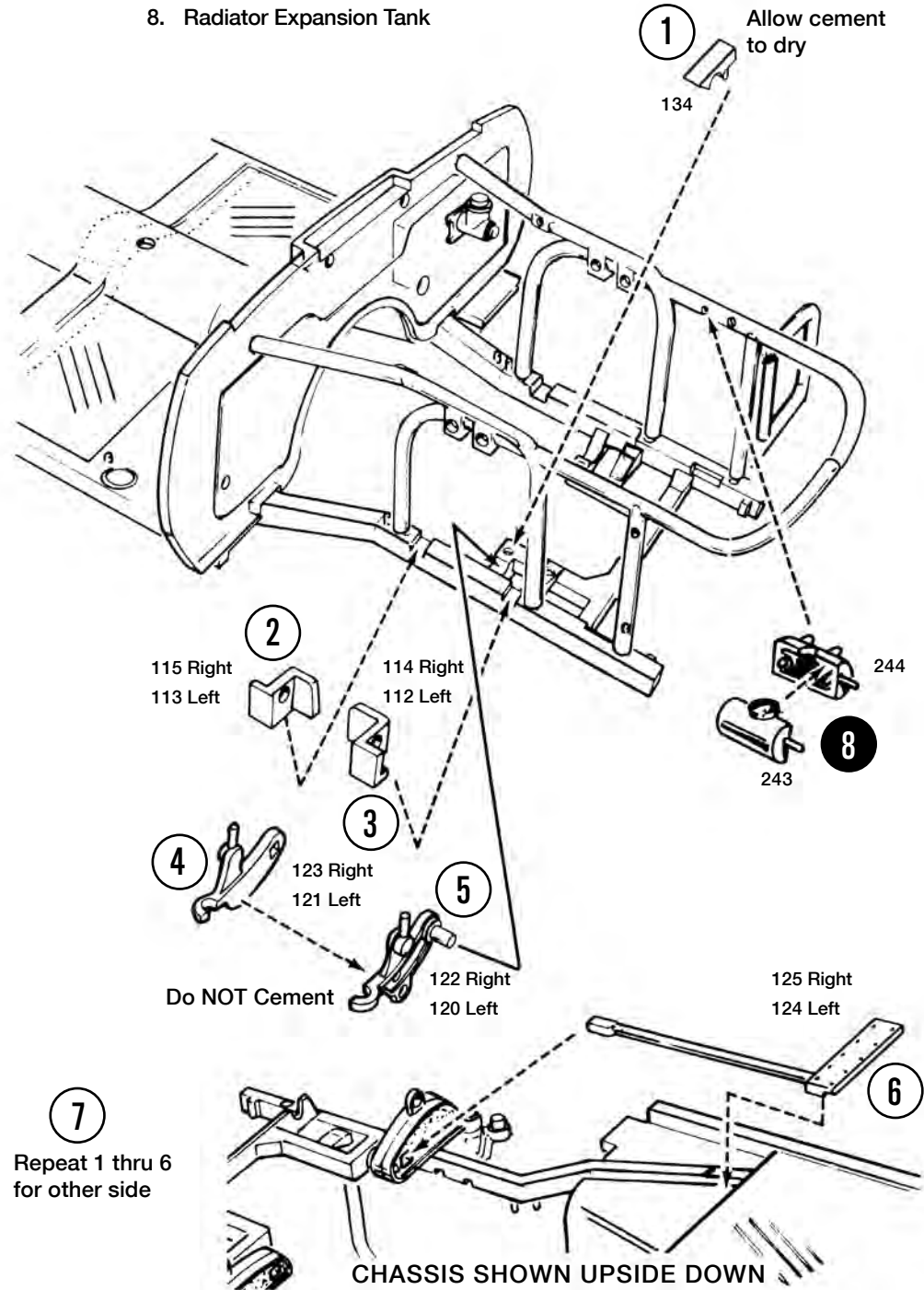

Repeat 1 thru 6
for other side

CHASSIS SHOWN UPSIDE DOWN

3

4 Repeat 1 Thru 3 For Other Side

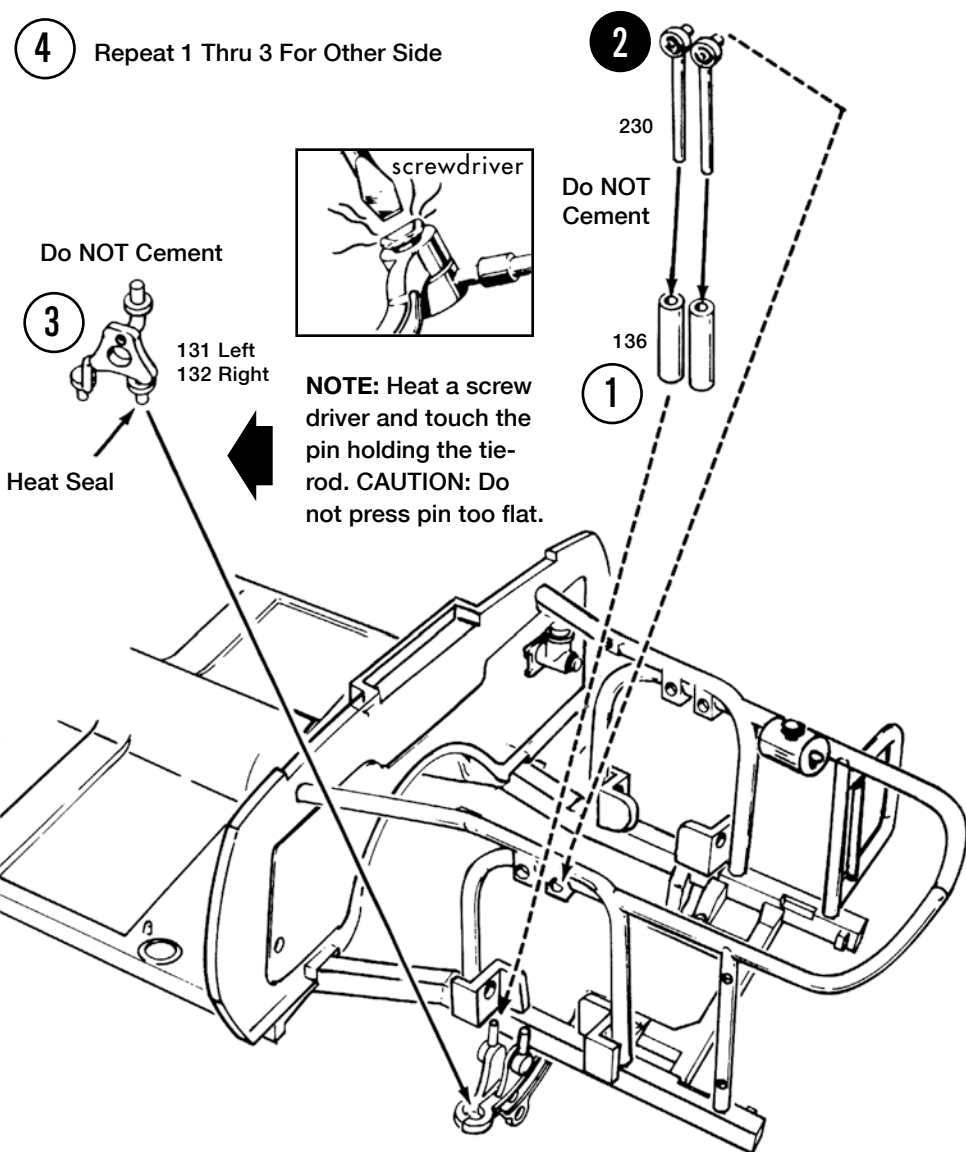

1. Front Shock Tubes
2. Front Shock Rods
3. King Pins

NOTE: If you want a static front end (one that does not work), cement all parts together except the brake drum and retaining pin.

4a

Repeat for other tire

1. Tires
2. Wheel Outers
3. Wheel Inners

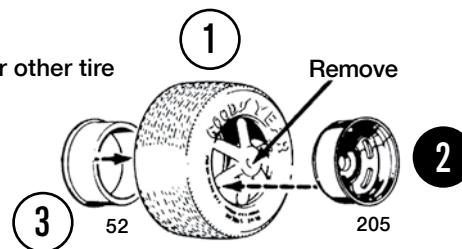

4b

6 Repeat 2 Thru 5 For Other Side

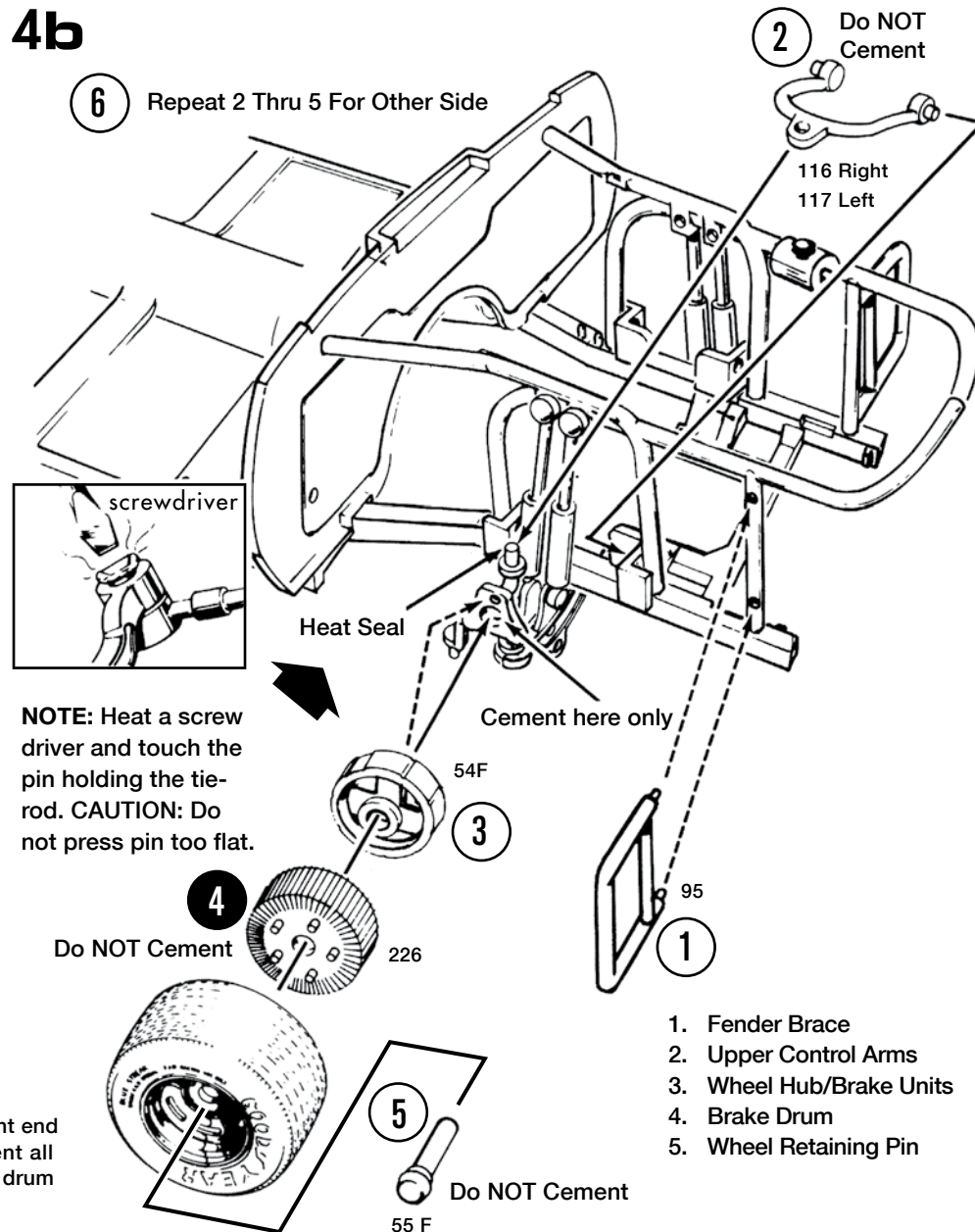

1. Fender Brace
2. Upper Control Arms
3. Wheel Hub/Brake Units
4. Brake Drum
5. Wheel Retaining Pin

Do NOT Cement

5

- 1. & 2. Shock Brackets
- 3. Upper Shock Bar
- 4. Fuel Cell
- 6. & 7. Shackets

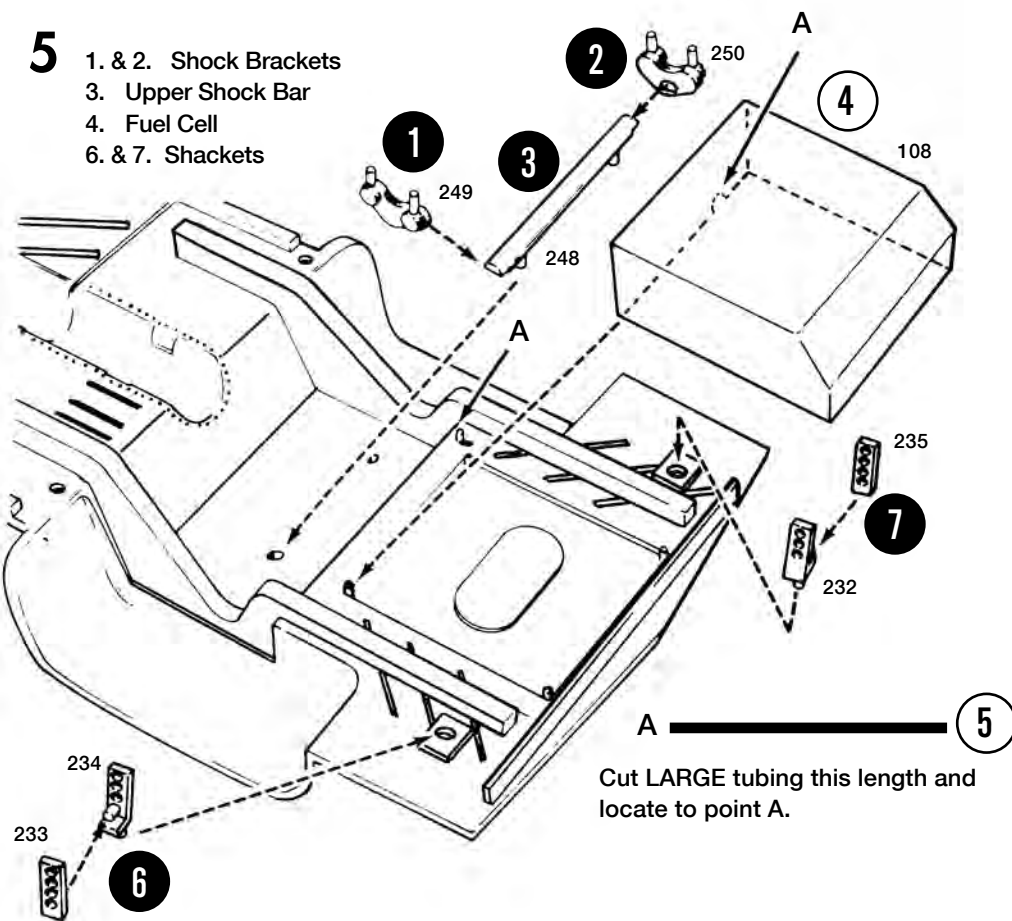

Cut LARGE tubing this length and locate to point A.

6

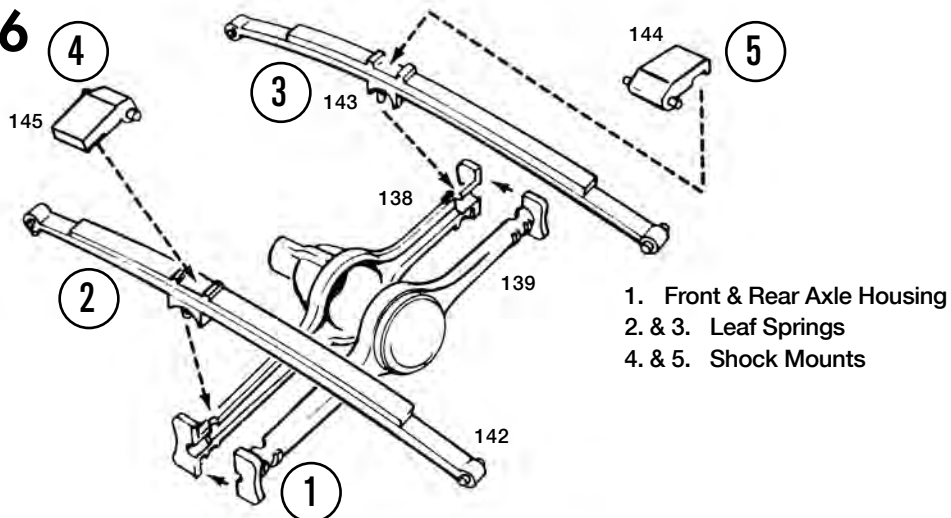

- 1. Front & Rear Axle Housing
- 2. & 3. Leaf Springs
- 4. & 5. Shock Mounts

7

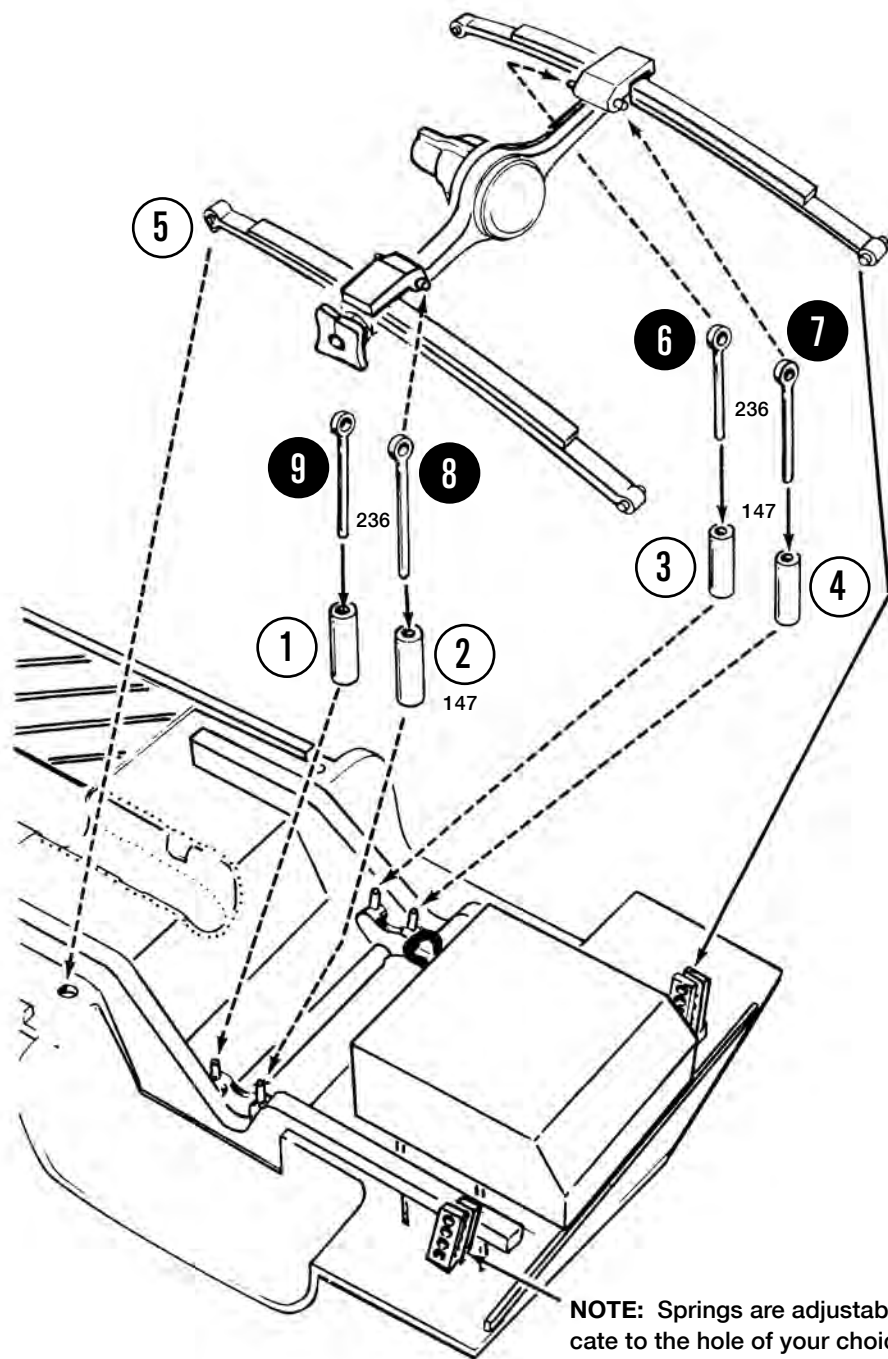

NOTE: Springs are adjustable locate to the hole of your choice for desired height.

- 1. 2. 3. & 4. Rear Shock Tubes
- 5. Assembled Axle
- 6. 7. 8. & 9. Rear Shock Rods

8

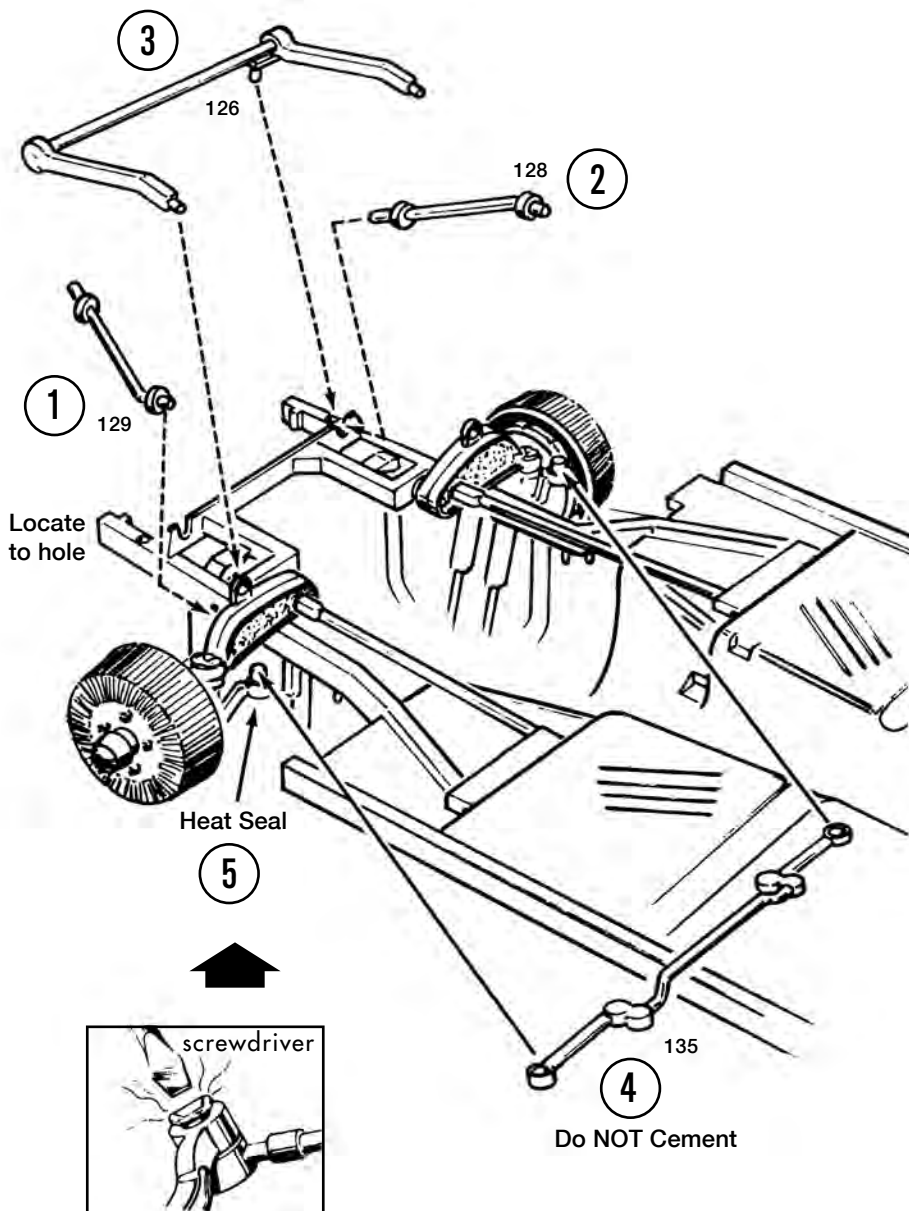

NOTE: Heat a screw driver and touch the pin holding the tie-rod. **CAUTION:** Do not press pin too flat.

1. & 2. Radius Rods
3. Control Strut
4. Tie Rod

9

Repeat for other tire

1. Tires
2. Wheel Outers
3. Wheel Inners

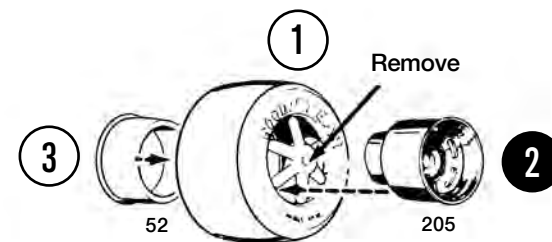

10

5 Repeat 1 Thru 4 For Other Side

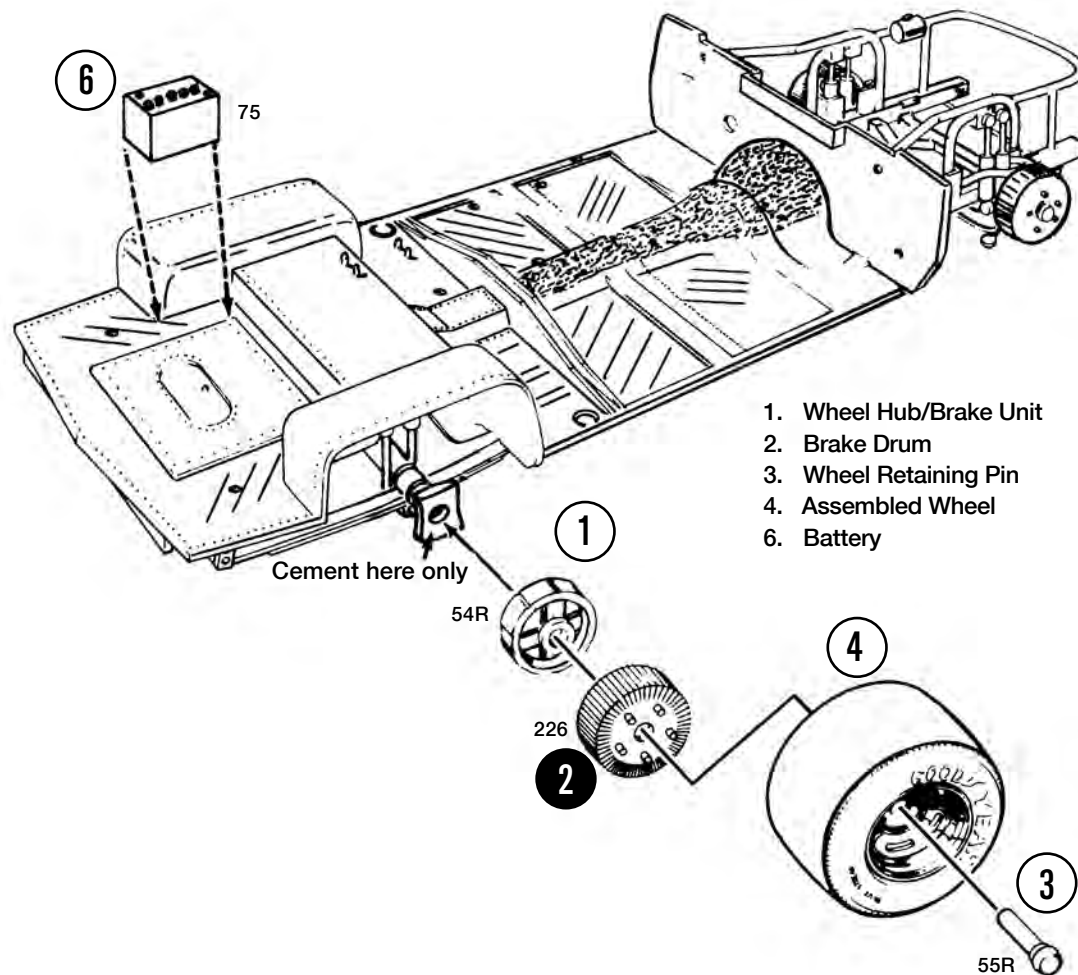

1. Wheel Hub/Brake Unit
2. Brake Drum
3. Wheel Retaining Pin
4. Assembled Wheel
6. Battery

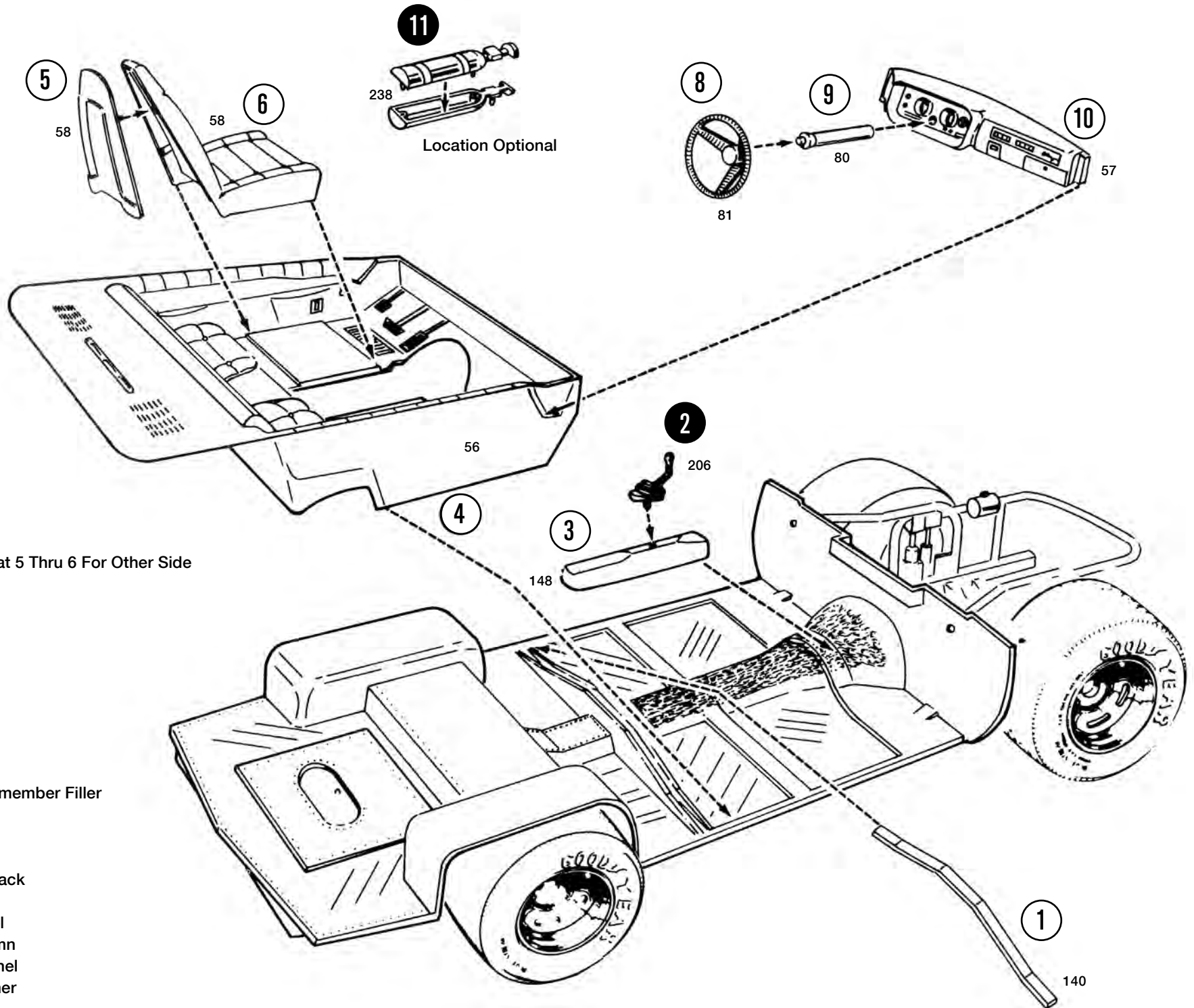

1. Chassis Crossmember Filler
2. Shifter
3. Console
4. Interior
5. Bucket Seat Back
6. Bucket Seat
8. Steering Wheel
9. Steering Column
10. Instrument Panel
11. Fire Extinguisher

12

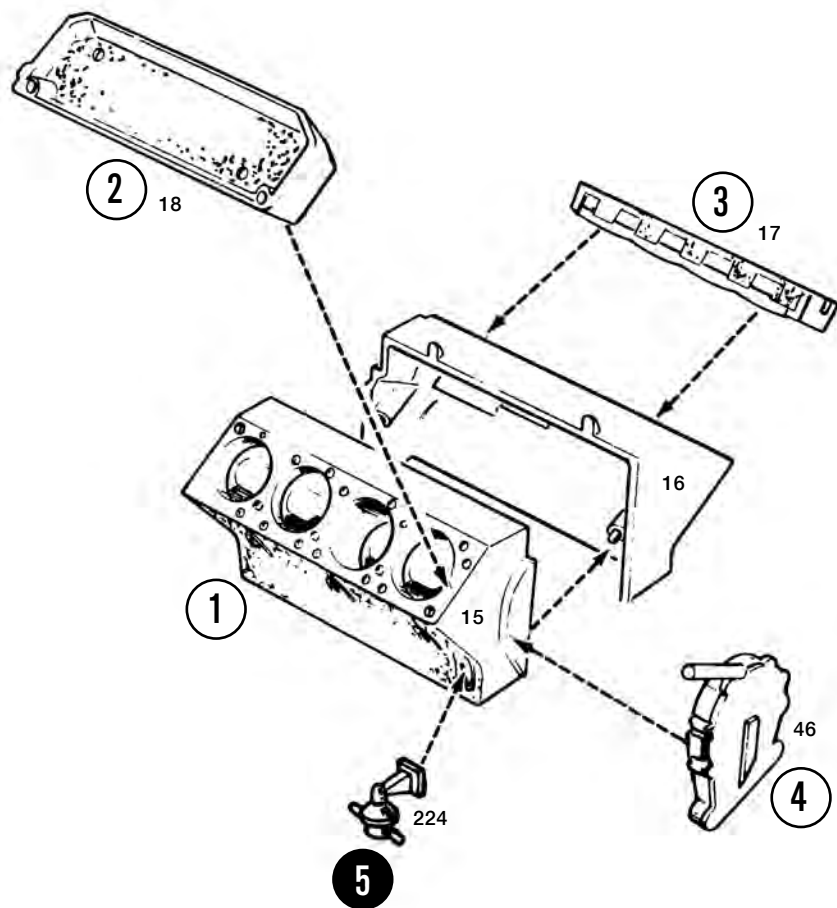

1. Engine Block Halves
2. Right Cylinder Head
3. Left Cylinder Head
4. Engine Front
5. Fuel Pump

13

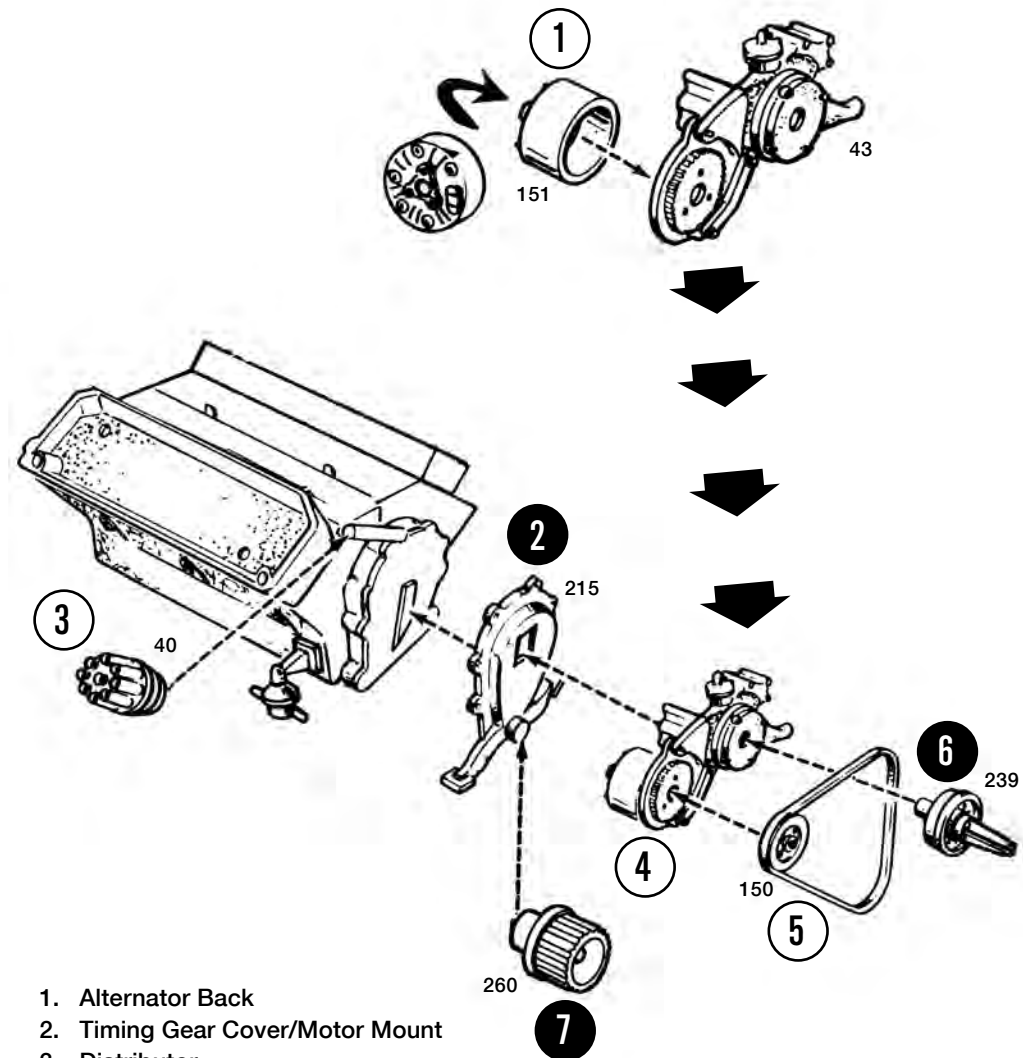

1. Alternator Back
2. Timing Gear Cover/Motor Mount
3. Distributor
4. Water Pump & Alternator Bracket
5. Alternator Pulley & Fan Belt
6. Fan Pulley
7. Crank Pulley

14

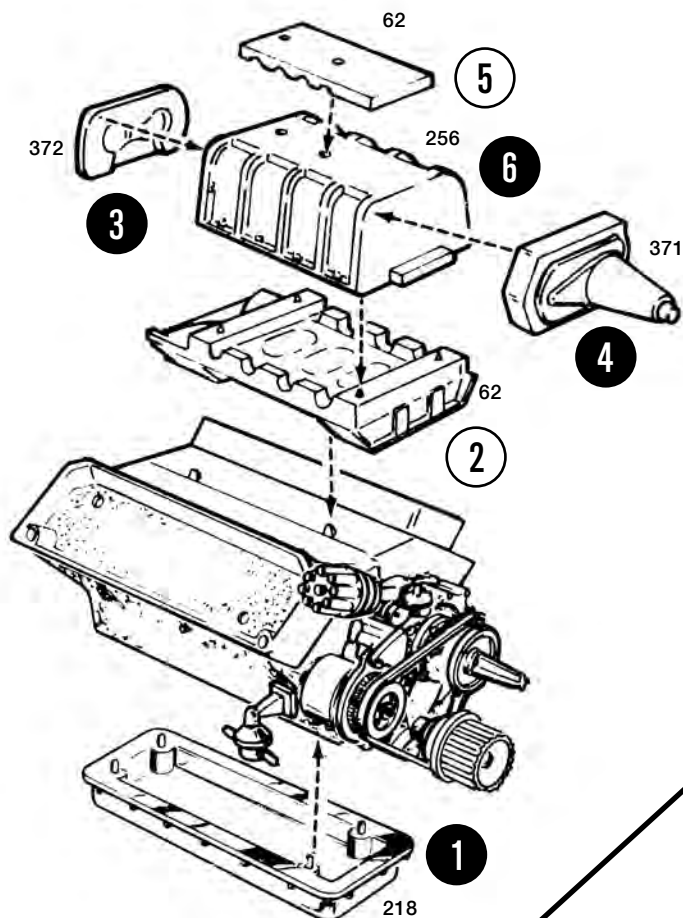

1. Oil Pan
2. Blower Manifold
3. Blower Rear Endplate
4. Blower Front Endplate
5. Blower Injection
6. Blower Case Assembly

15

Butterflies are trapped by scoop top & may be left uncemented so they move.

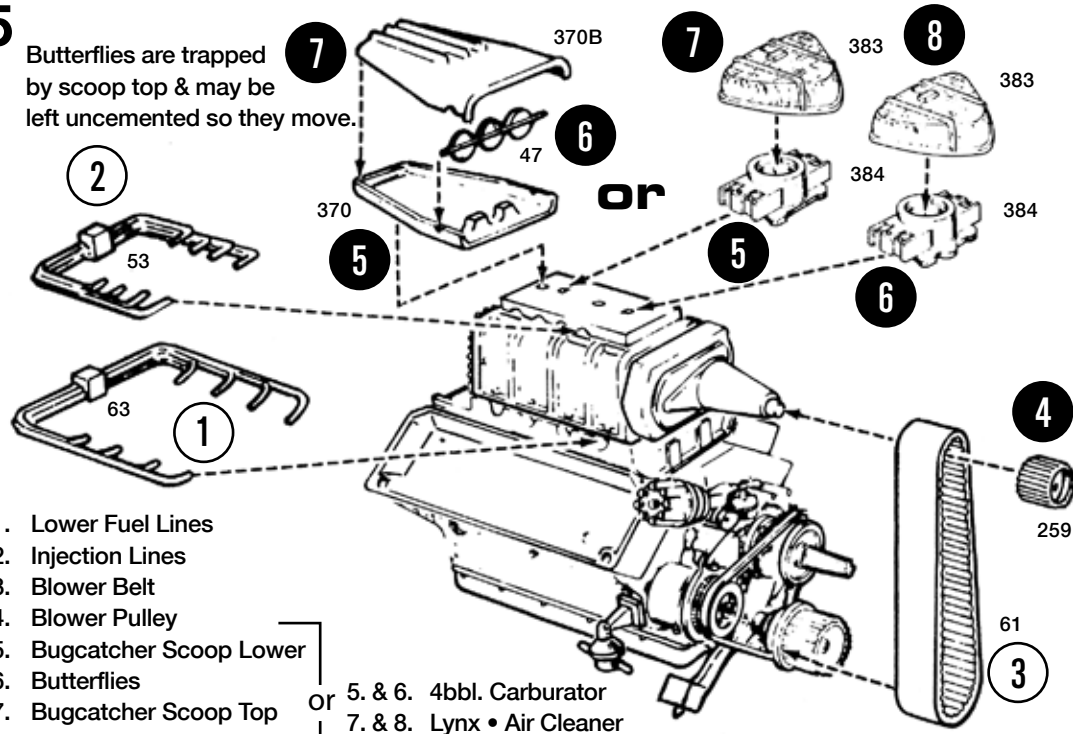

1. Lower Fuel Lines
 2. Injection Lines
 3. Blower Belt
 4. Blower Pulley
 5. Bugcatcher Scoop Lower
 6. Butterflies
 7. Bugcatcher Scoop Top
- or
5. & 6. 4bbl. Carburetor
 7. & 8. Lynx • Air Cleaner

16

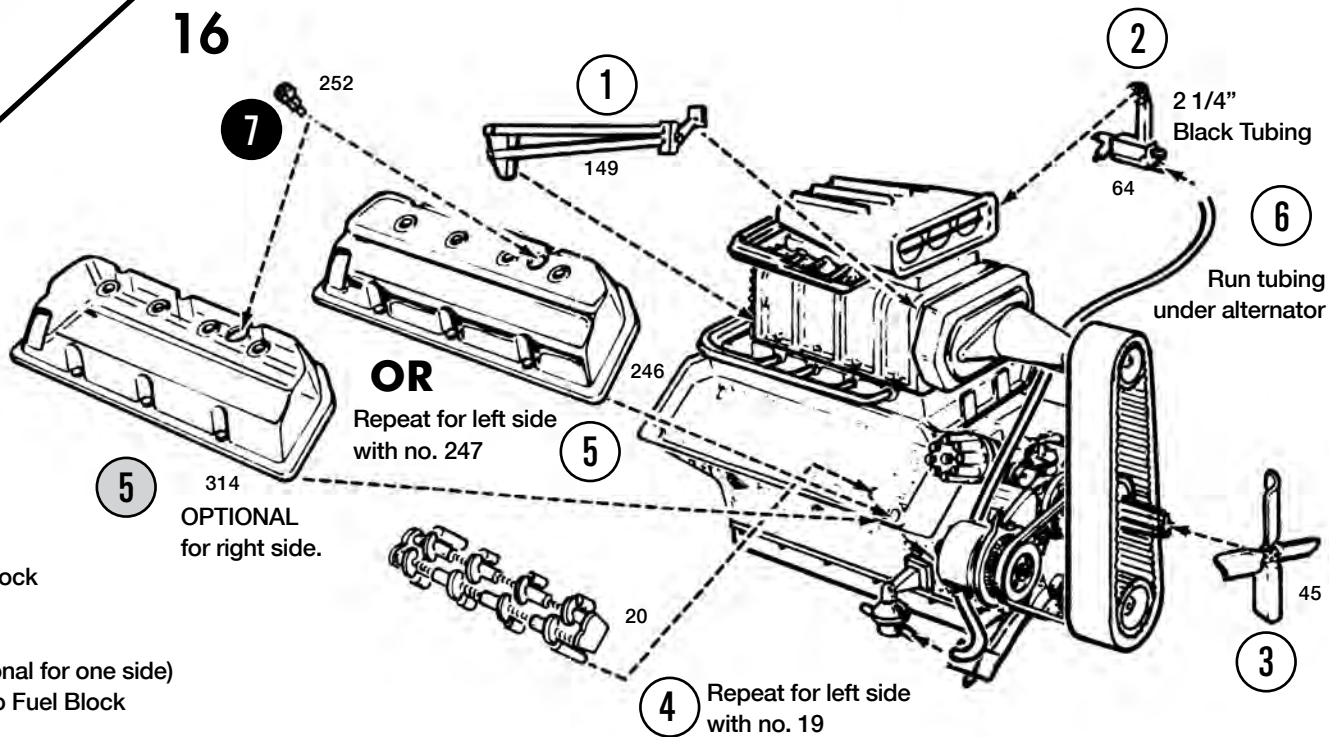

1. Blower linkage
2. Fuel Injection Linkage & Fuel Block
3. Fan
4. Rocker Arms
5. Valve Covers (Clear one is optional for one side)
6. Small Tubing from Fuel Pump to Fuel Block
7. Breather Cap

OR

Repeat for left side with no. 247

OPTIONAL for right side.

2 1/4" Black Tubing

Run tubing under alternator

4 Repeat for left side with no. 19

17

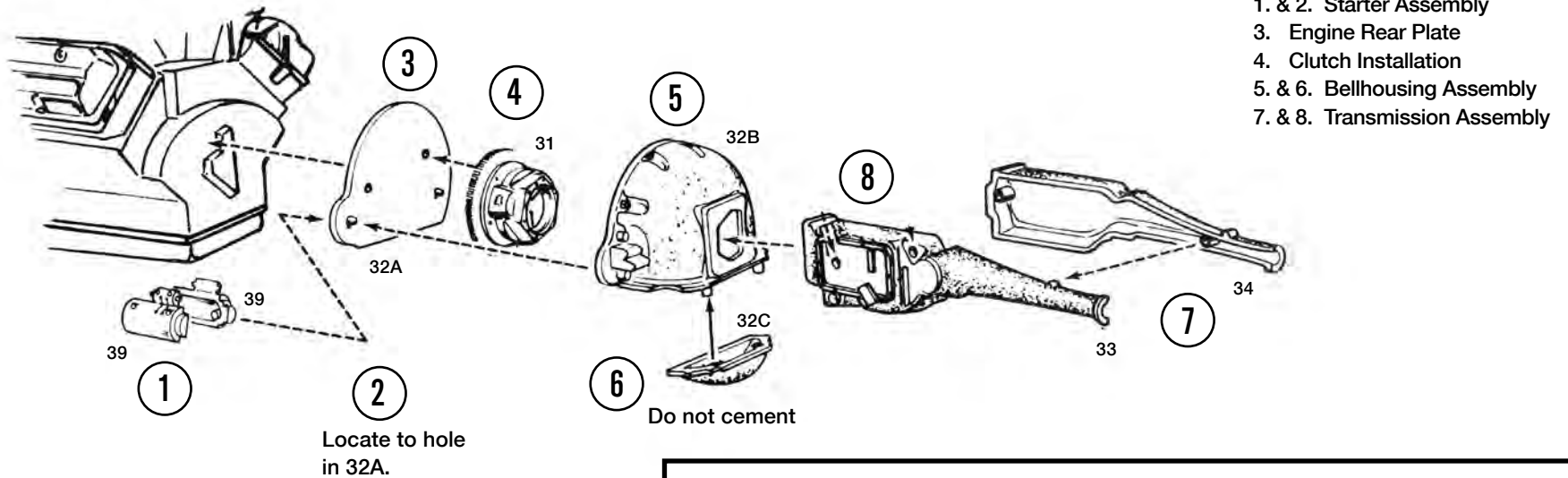

18

1. & 2. Header Pipe Assembly
3. Header Flange Assembly
4. Repeat steps 1 to 3 for other side
5. Fuel Line

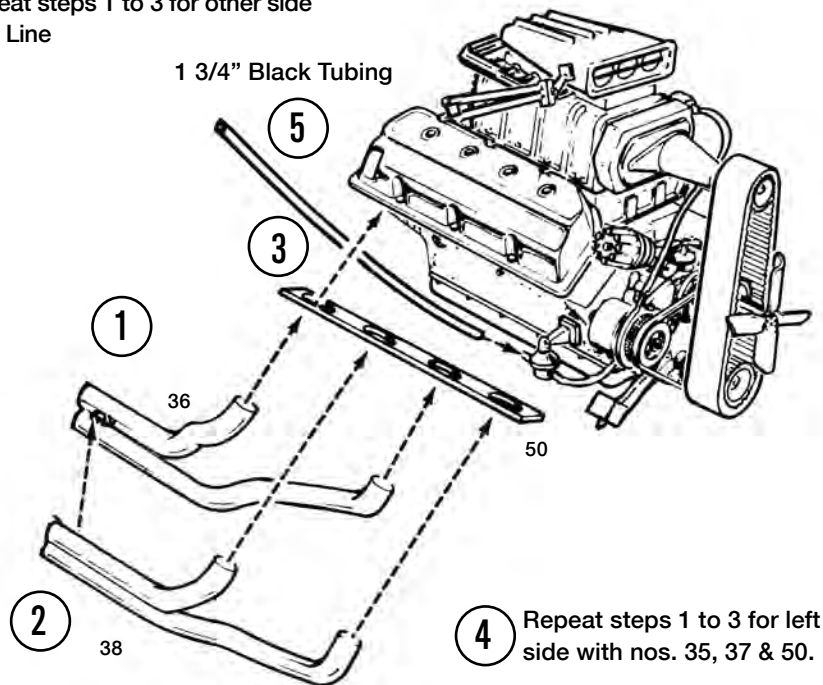

19

SPARK PLUG WIRING DIAGRAM

USE YELLOW TUBING

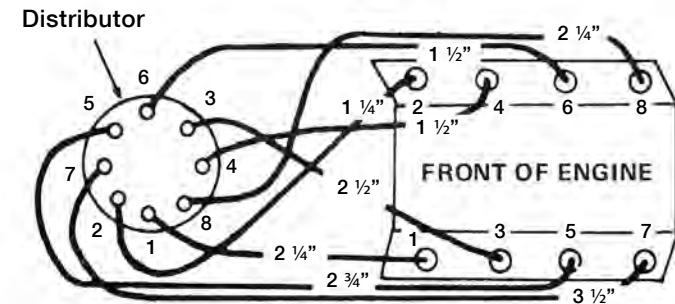

20

1. Oil Filter
2. Oil Pump
3. Oil Line
4. & 5. Lower & Upper Radiator Hoses

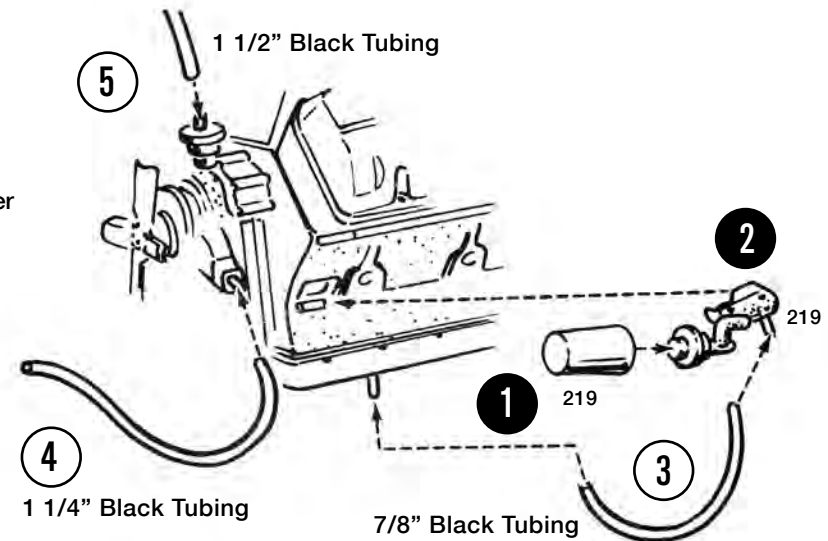

21

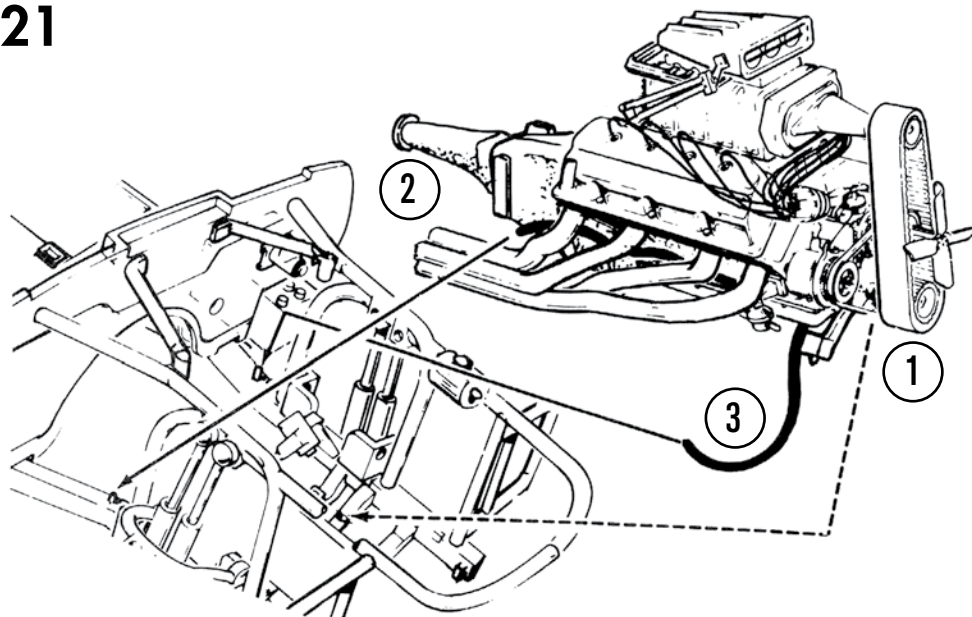

22

NOTE: Tires are not shown for clarity.

Repeat steps 5 & 6 for other side, using 337A and 337B

2

NOTE: Cement Engine in place.

1. Drive Shaft
3. Drive Shaft Safety Retainer
4. Transmission Retainer
5. & 6. Exhaust Pipes

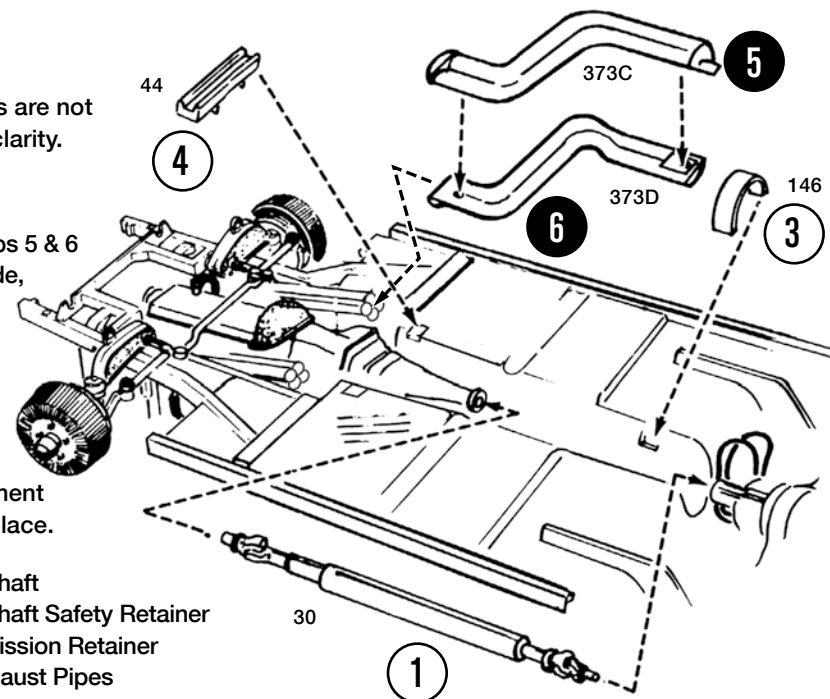

23

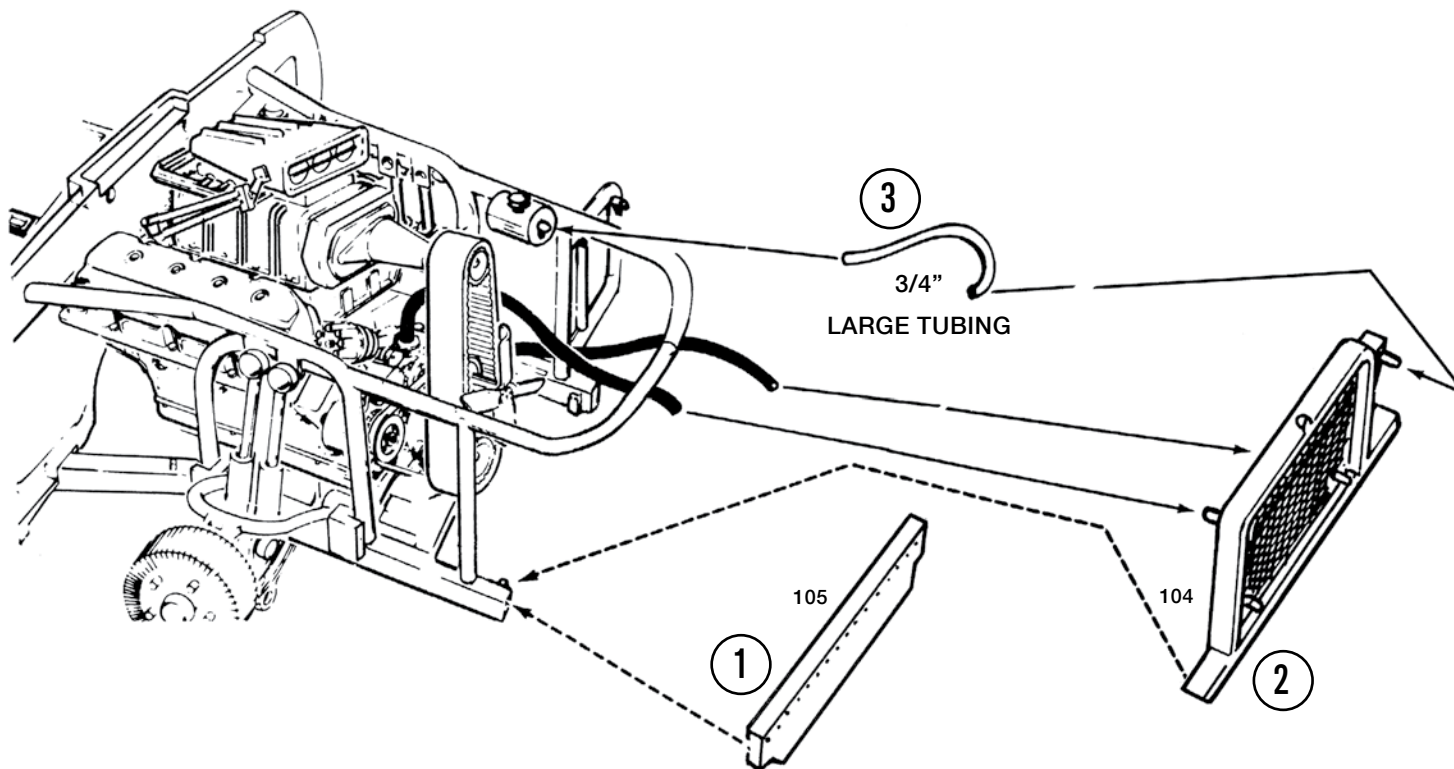

24

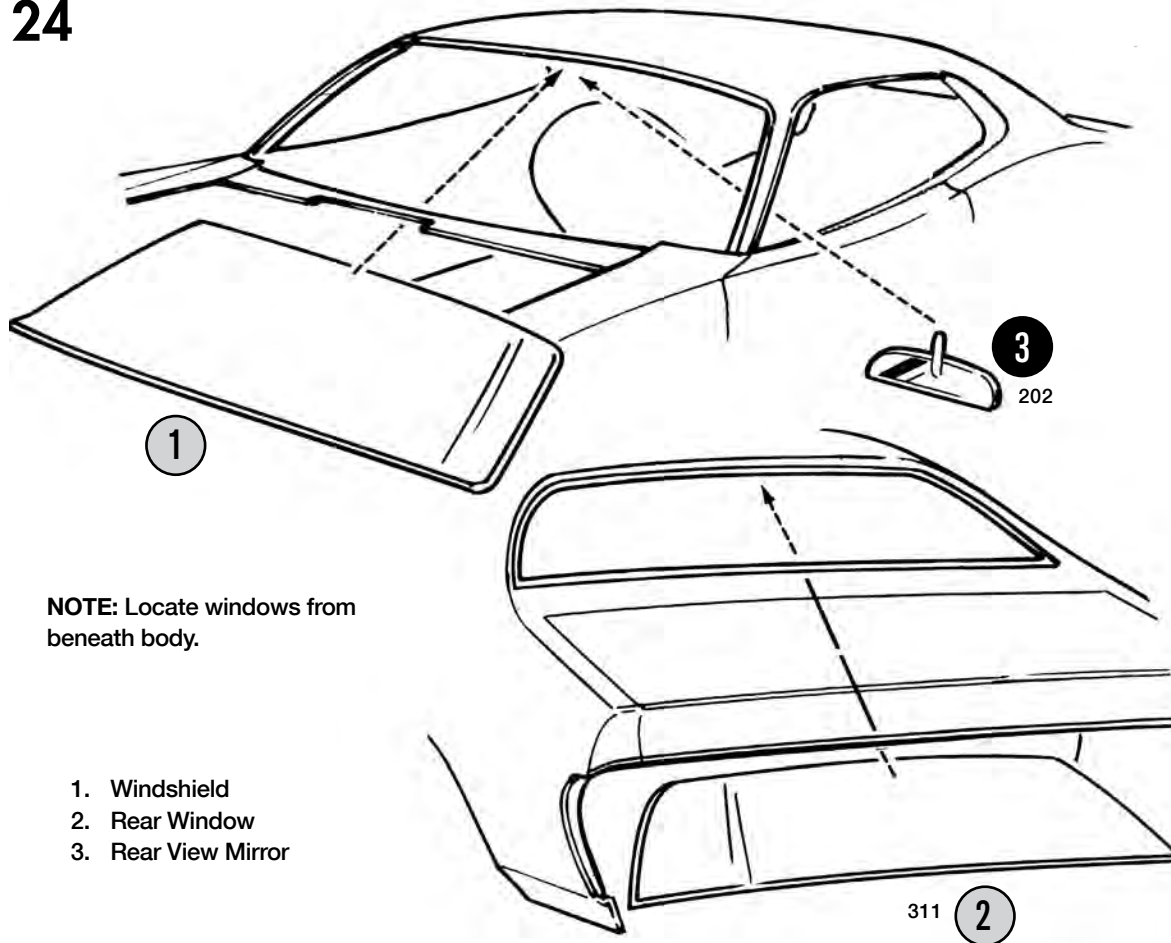

25

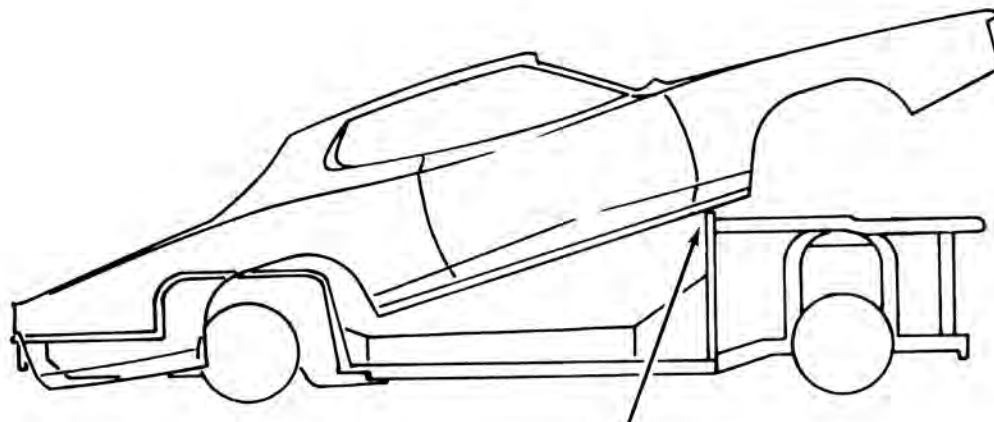

26

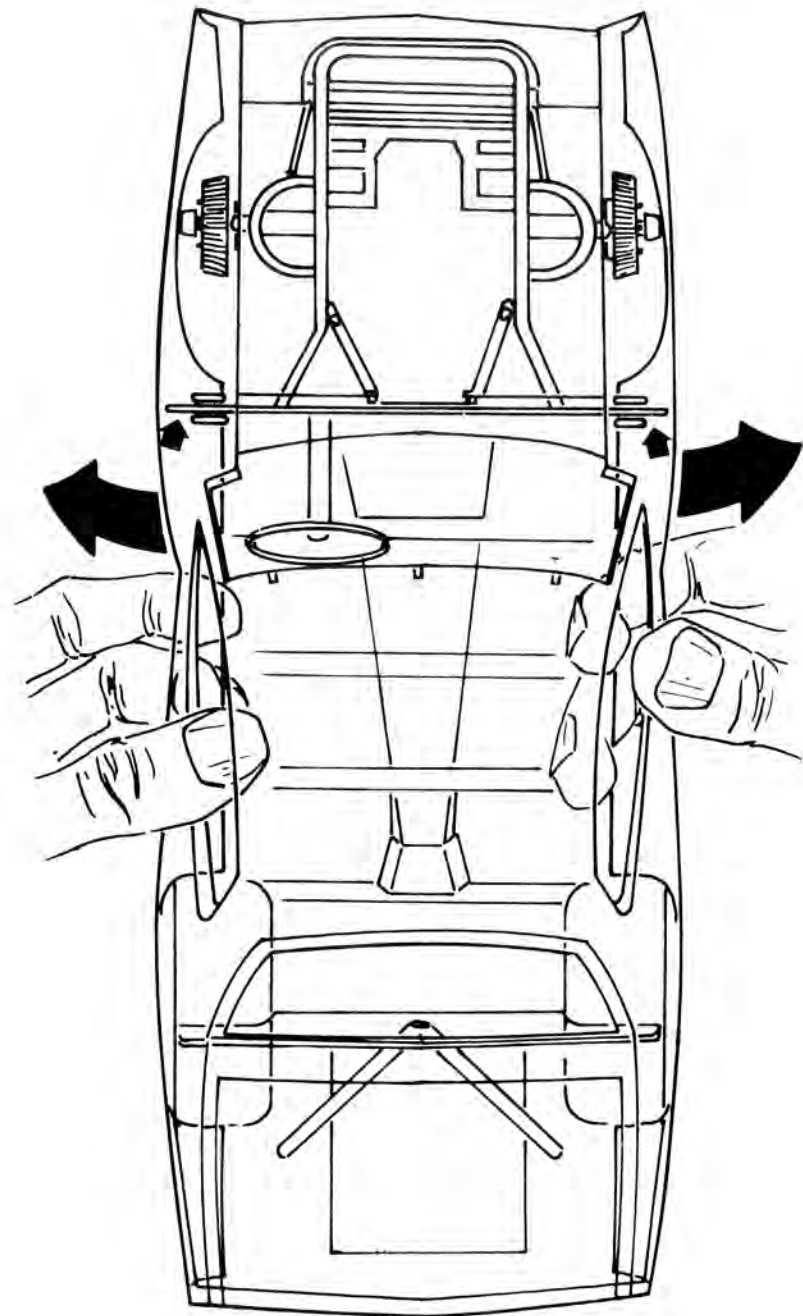

27

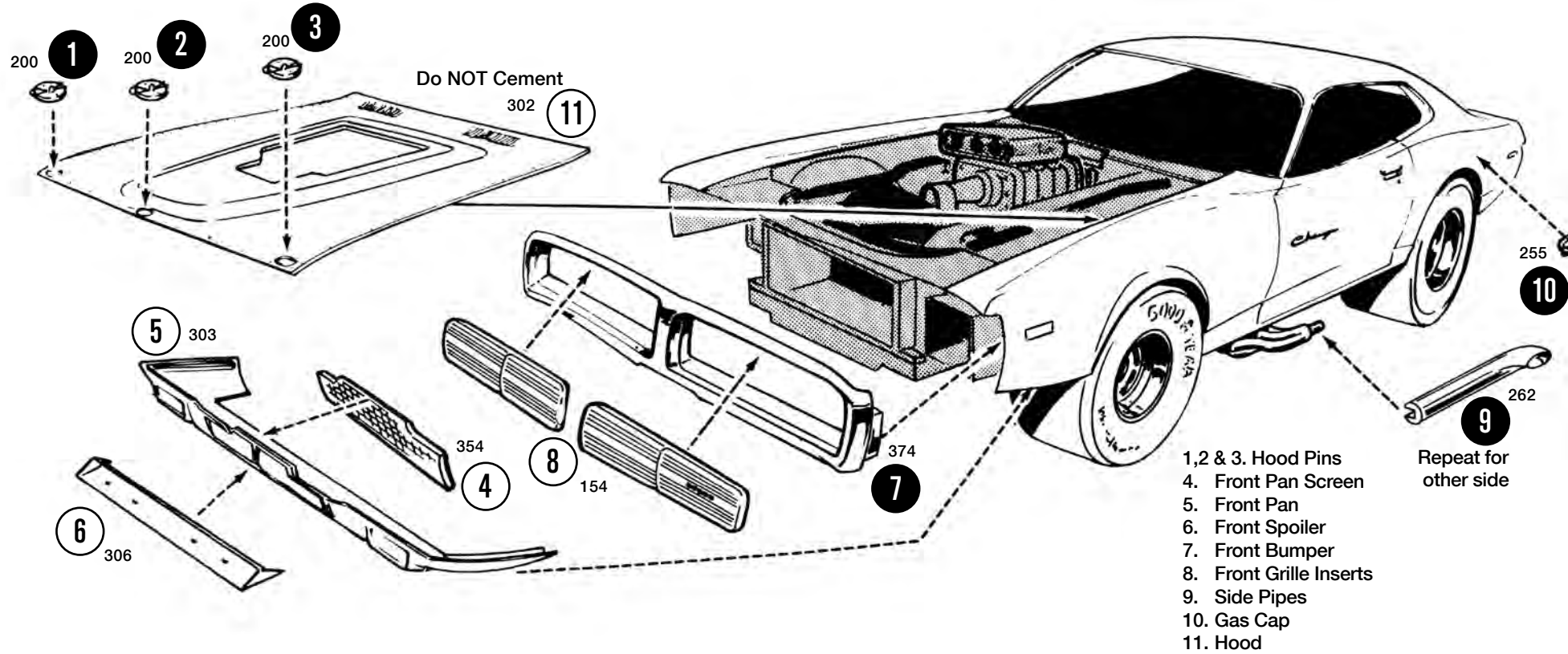

28

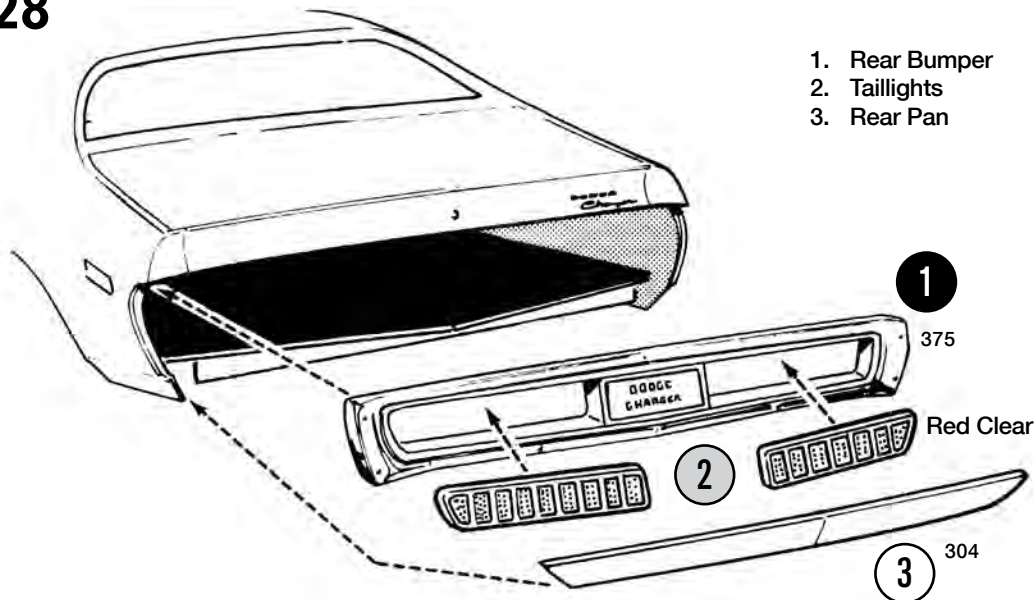

29

