

mpc  
M852-200

# MONSTER TRUCK

DATSUN

### IMPORTANT - READ THIS FIRST!

- ★ Study assembly drawings carefully before starting.
- ★ Follow step number sequence in each assembly drawing.
- ★ Scrape paint and plating from contact areas to be joined.
- ★ Only use cement made for styrene plastic.
- ★ Check fit before cementing parts together.
- ★ Use cement sparingly.
- ★ Cement all parts except where noted.
- ★ Painting your model is optional.
- ★ Use standard colors where noted.
- ★ Allow paint to dry completely before handling.

### INSTRUCTION SYMBOLS

2 — step numbers

13 — part numbers

\*106 — plated part numbers

(2X) — repeat

## 1 (4X) ASSEMBLE FOUR MONSTER TIRES & WHEELS

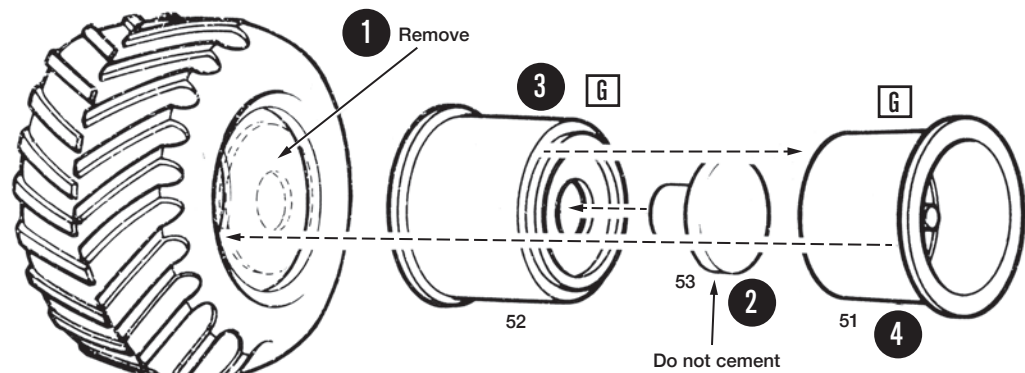

Assemble tires and wheels, two left and two right. Tread should point forward on all four tires.

## 2 BLOWN V8

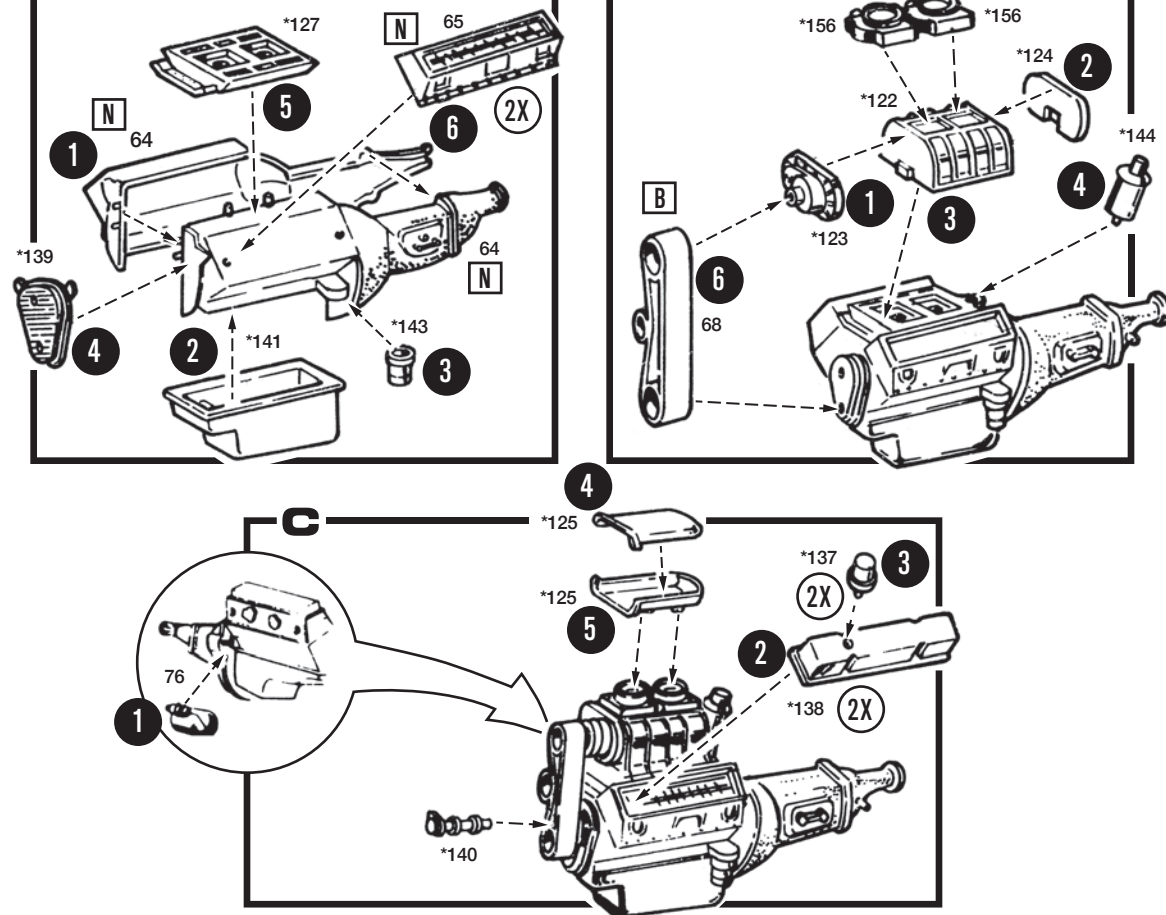

## 3 FLIP FRONT END

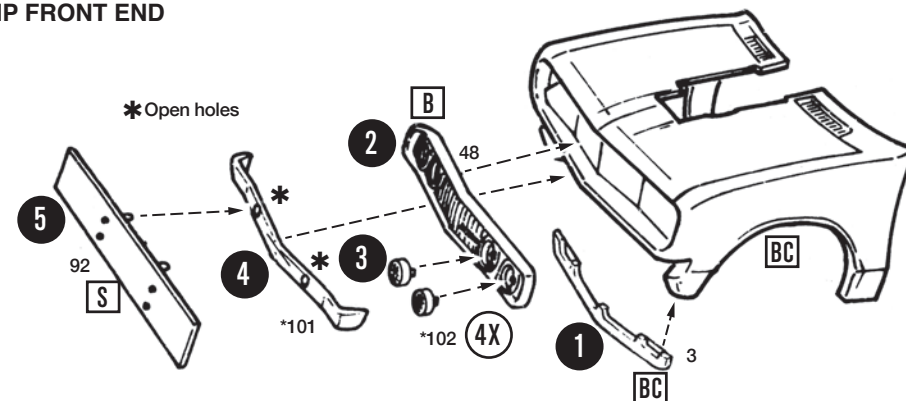

## 4 REAR SUSPENSION

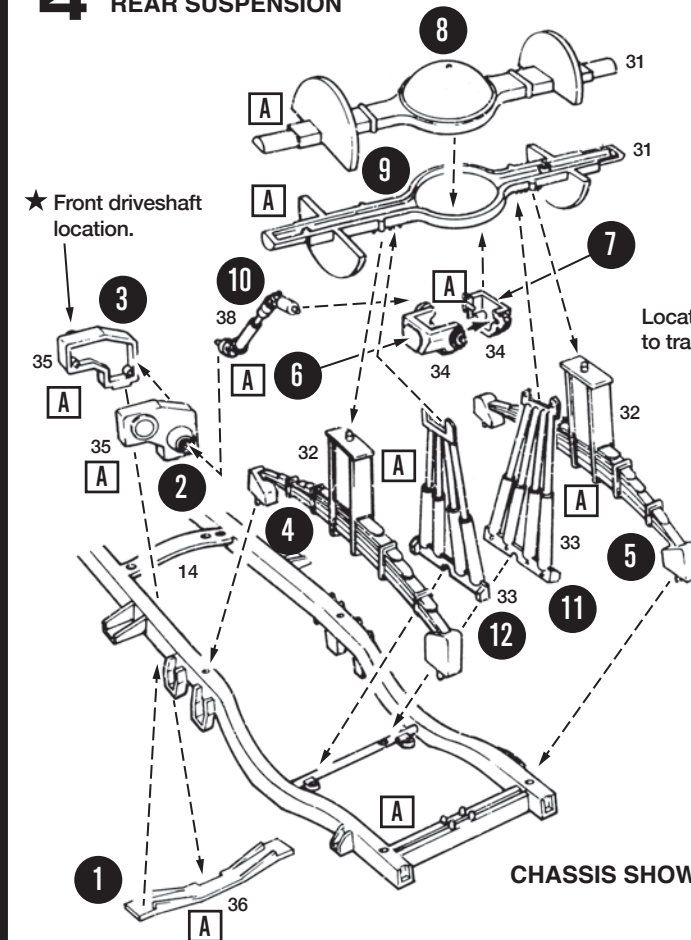

## 5 FRONT SUSPENSION

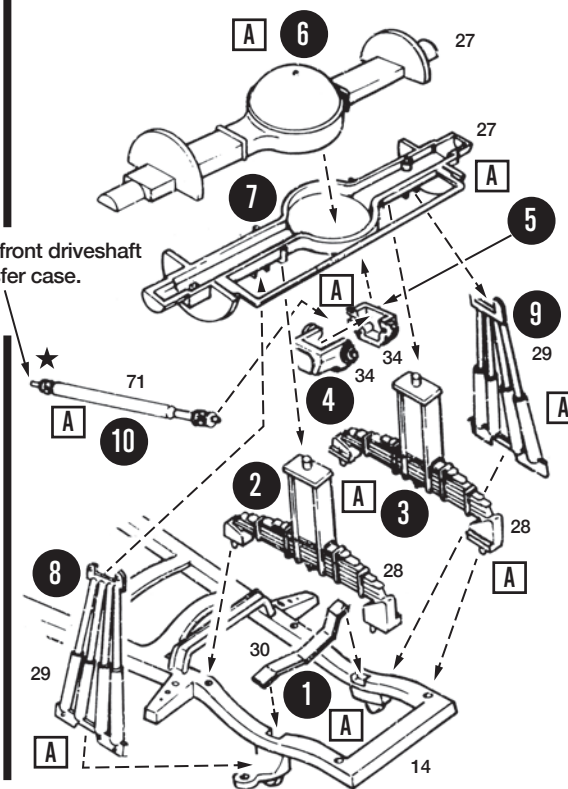

## 6 ENGINE TO CHASSIS

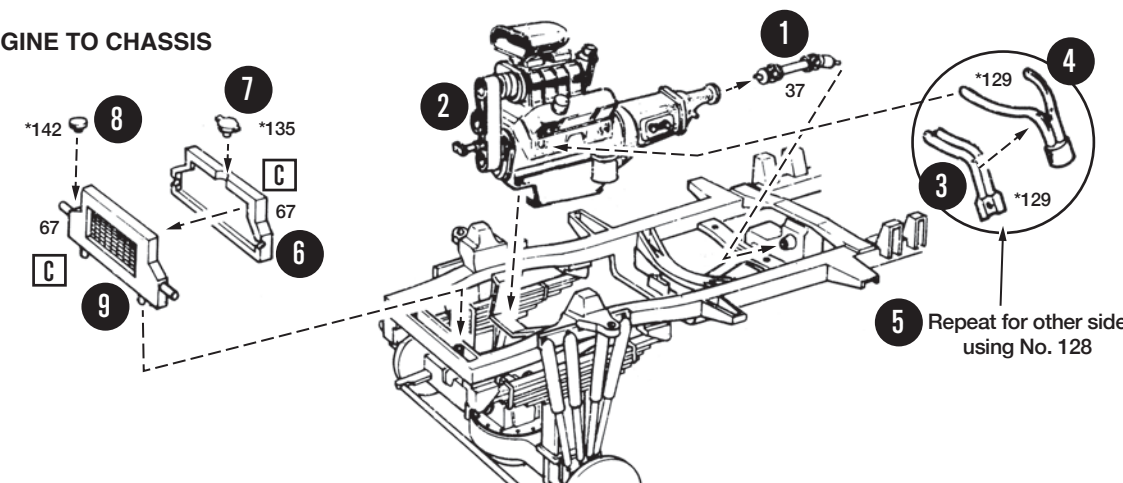



## 7 INTERIOR

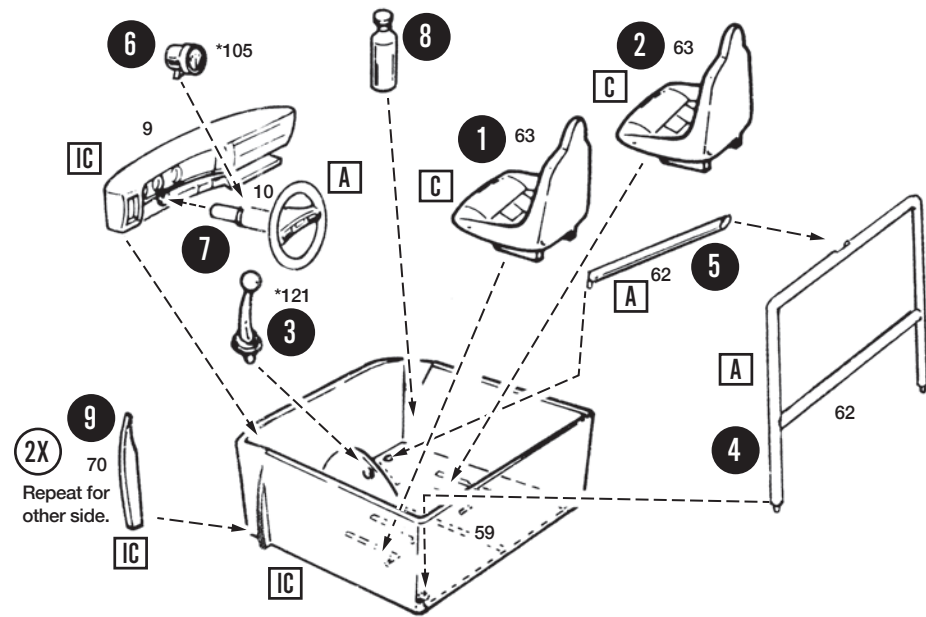

## 8 CAB

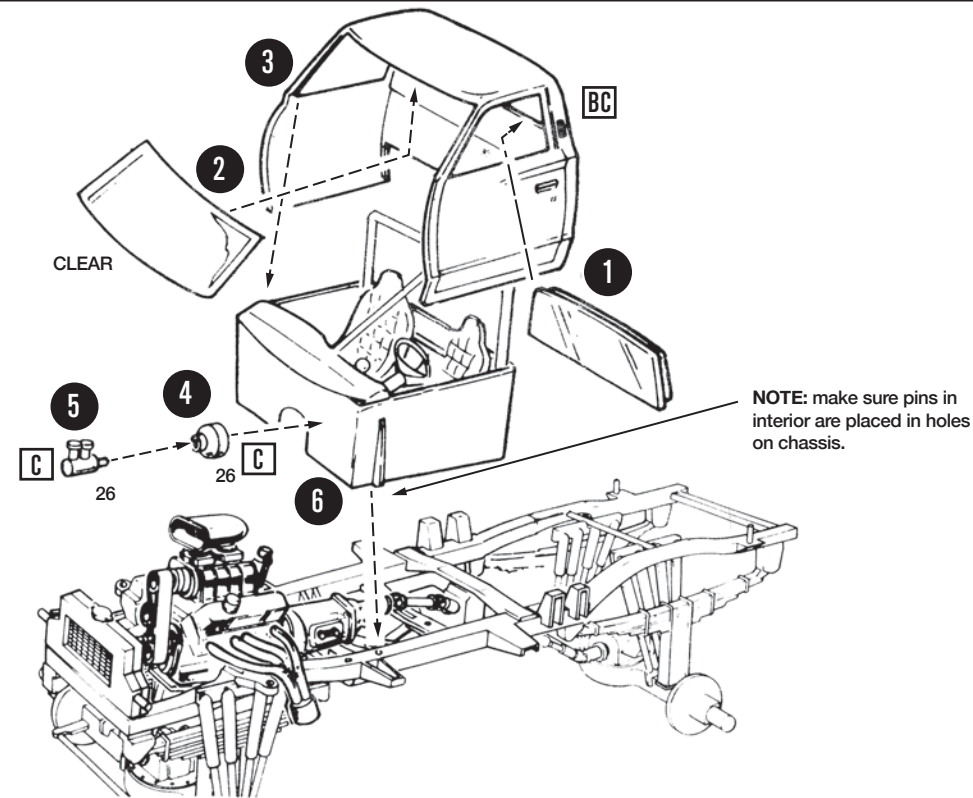

## 9 BED

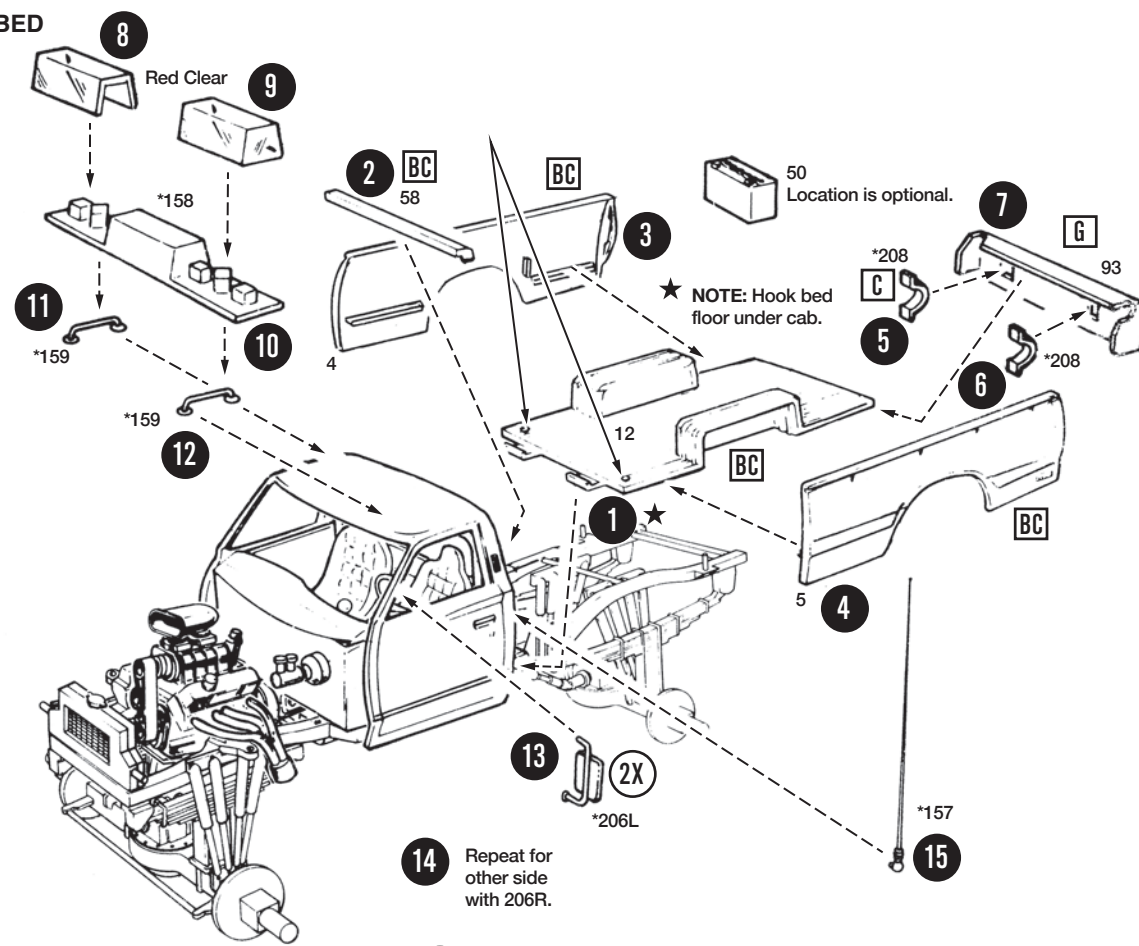

## 10 WRECKER UNIT

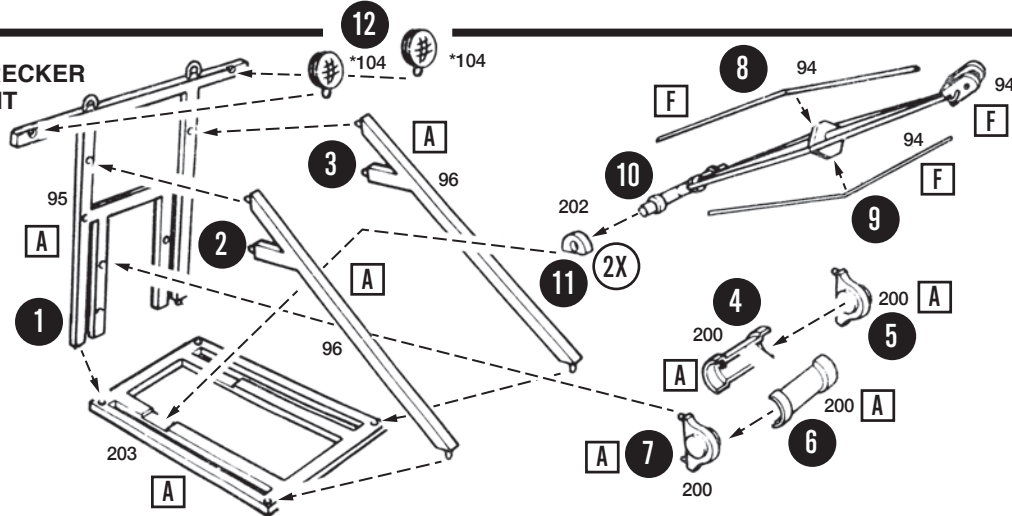

## 11 COMPLETION

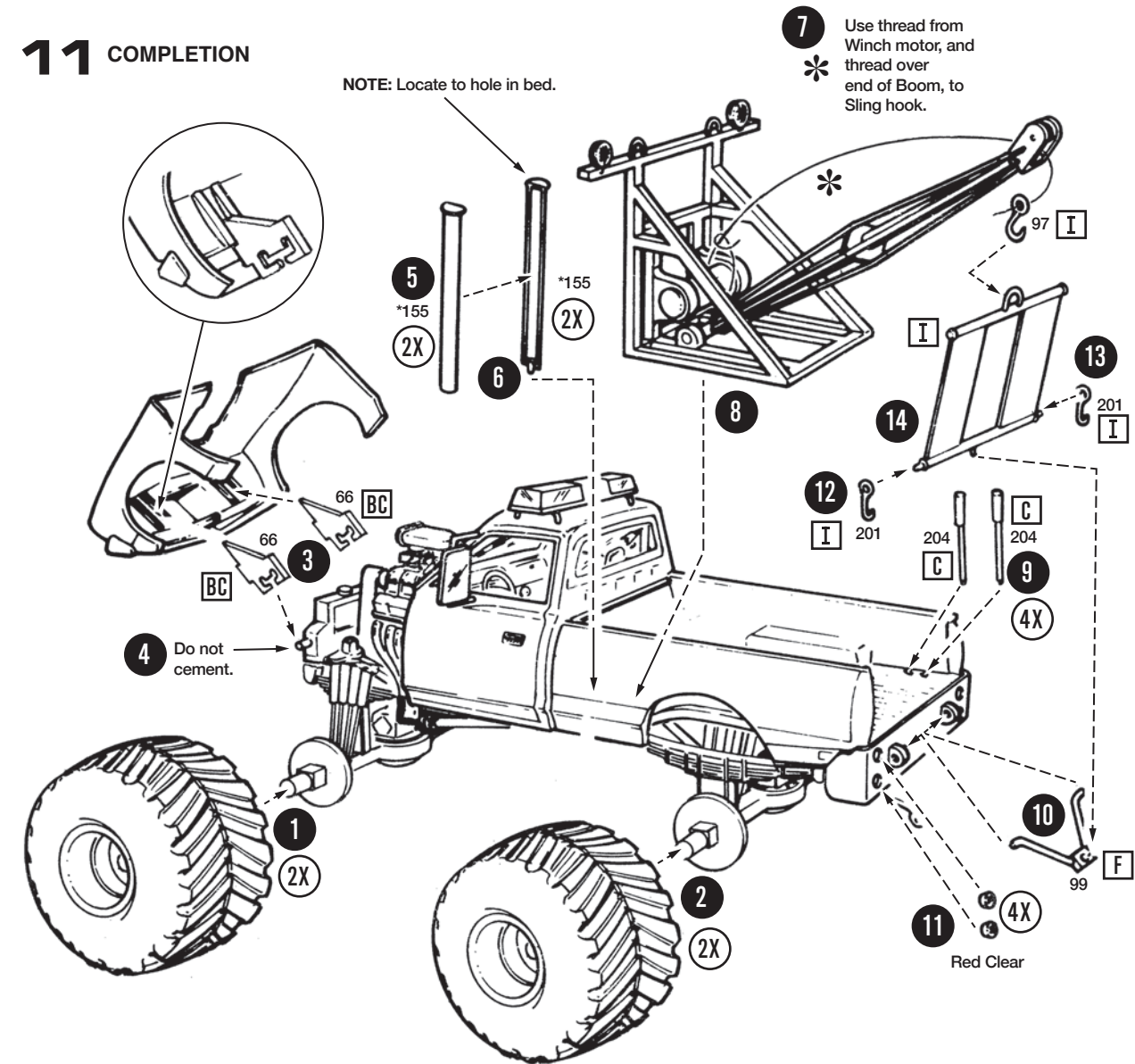

## PAINT COLORS

<b>A</b> Black	<b>H</b> Aluminum	<b>O</b> Transparent Red	<b>V</b> Dark Blue	<b>BC</b> Body Color
<b>B</b> Flat Black	<b>I</b> Steel	<b>P</b> Orange	<b>W</b> Transparent Blue	<b>IC</b> Interior Color
<b>C</b> Semi-Gloss Black	<b>J</b> Brass	<b>Q</b> Yellow	<b>X</b> Lt. Green	<b>▲</b> Semi-Gloss
<b>D</b> White	<b>K</b> Gold	<b>R</b> Tan	<b>Y</b> Dark Green	<b>△</b> Gloss
<b>E</b> Flat White	<b>L</b> Amber	<b>S</b> Brown	<b>Z</b> Gray	<b>▲</b> Metallic
<b>F</b> Silver	<b>M</b> Transparent Amber	<b>T</b> Lt. Blue	<b>AA</b> Purple	
<b>G</b> Chrome (Bright Silver)	<b>N</b> Red	<b>U</b> Med. Blue	<b>BB</b> Beige	