

1979 PONTIAC FIREBIRD

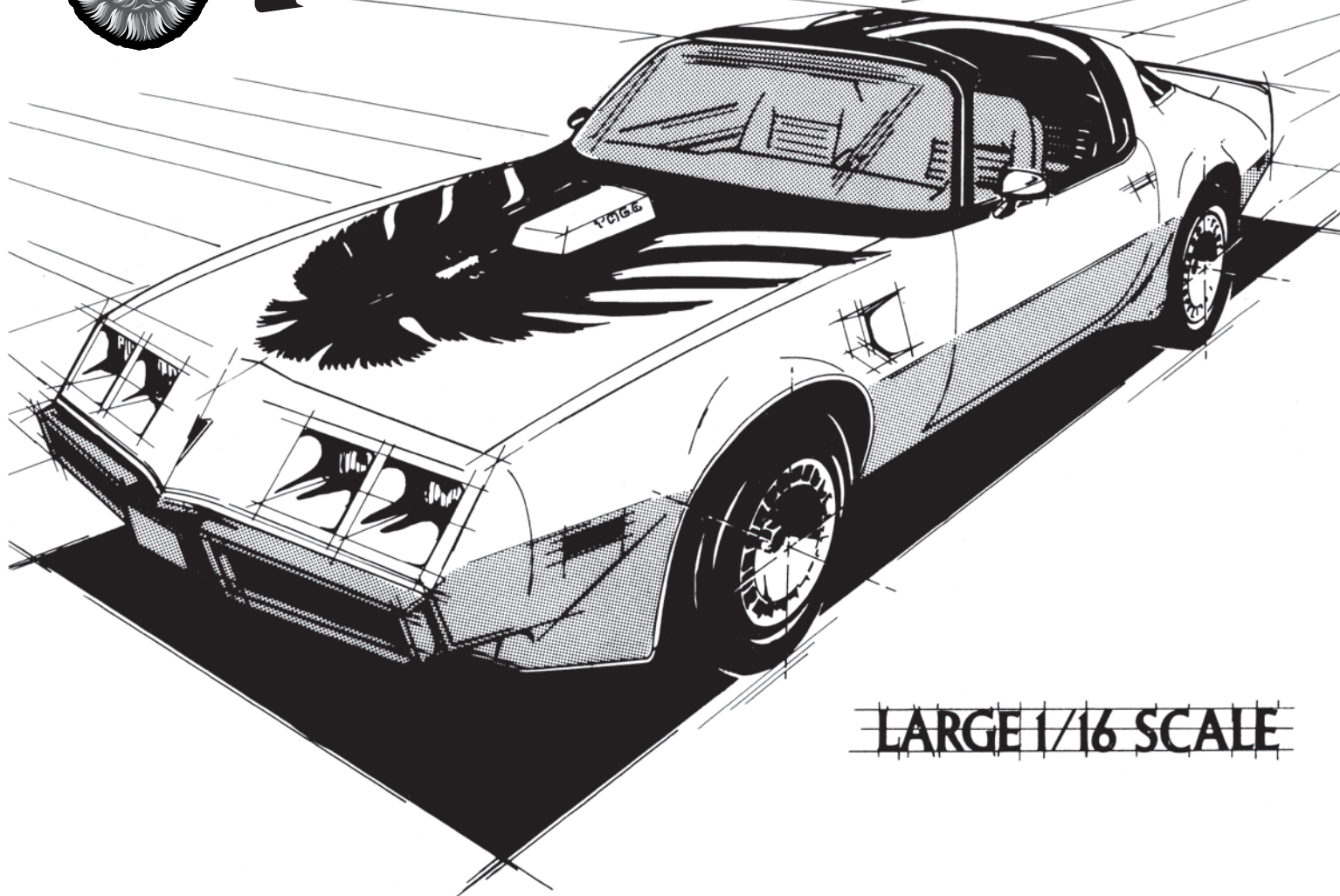

LARGE 1/16 SCALE

mpc
MPC862/06

IMPORTANT! READ THE INSTRUCTIONS FIRST.

1. Study the illustrations and instructions carefully, before you begin assembly.
2. Use only cement for styrene plastic. Liquid cement is best used for attaching small parts.
3. Apply cement sparingly to avoid ruining the surface of your model.
4. Use a hobby knife to cut parts from the runners and to remove any excess plastic before assembly.
5. Test fit parts, before cementing.
6. To assist you in locating individual pieces, parts will have both a letter and a number. Example; D-64 TRACK RAIL.
The letter will be found in the corner of each "cluster" of parts. The individual parts of this kit are also named to aid you in identifying the major components of this Model.
7. The following modeling tools, while not required, will make assembly easier.
 - Modelers Knife - To remove parts from runners, remove excess plastic and scrape plating where cement will be applied.
 - Small File or Emery Board - For finishing glue joints and fittings.
 - Fine Sandpaper and Steel Wool - For fine fitting and surface finish.
 - Paint Brushes (Various Sizes) - Used for painting (use a small brush or toothpick to apply liquid cement).
 - Tweezers - For handling small parts.
 - Clothes Pins - For holding parts together to set after cementing.
 - Rubber Bands - For holding parts together to set after cementing.

PART NUMBERS FOR
PLATED PARTS.

5

PART NUMBERS FOR
CLEAR PARTS.

5

PART NUMBERS FOR
NON-PLATED PARTS.

5

REFER TO ...



SHOWN UPSIDE DOWN



REPEAT ON OTHER SIDE



CEMENT ----->

DO NOT CEMENT



REMOVE



PAINT NUMBERS

D

1

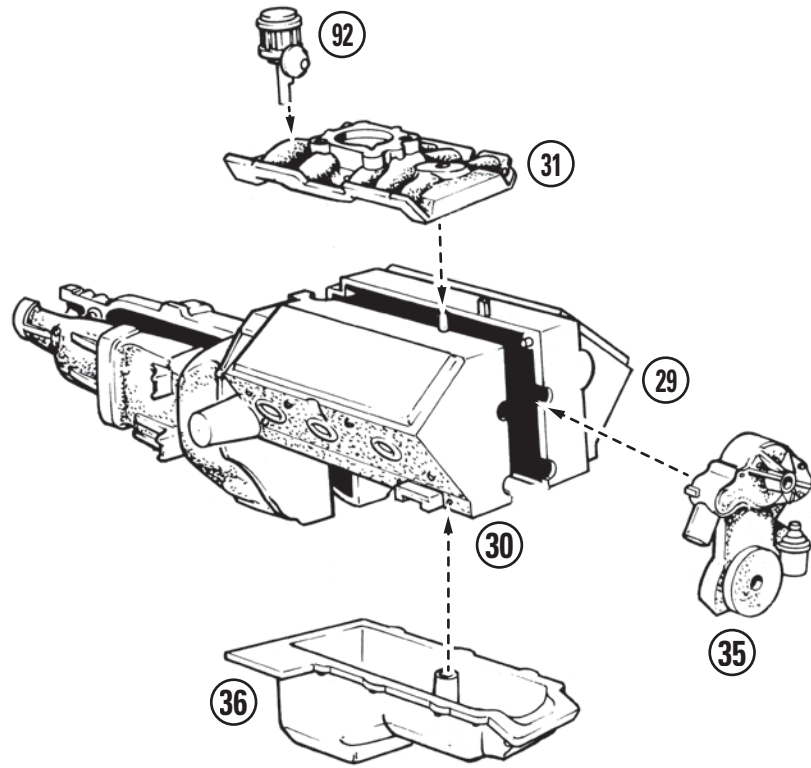

2

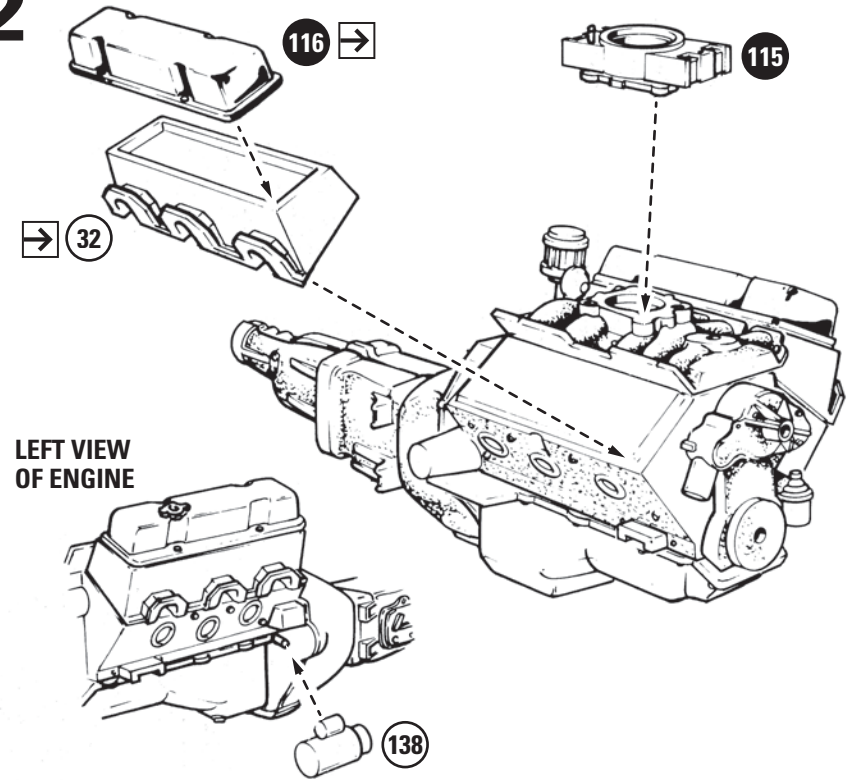

3

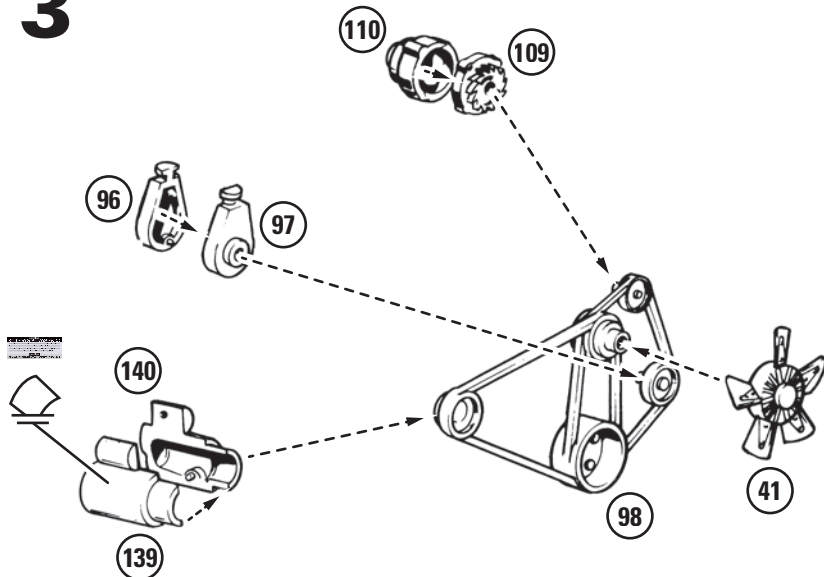

4

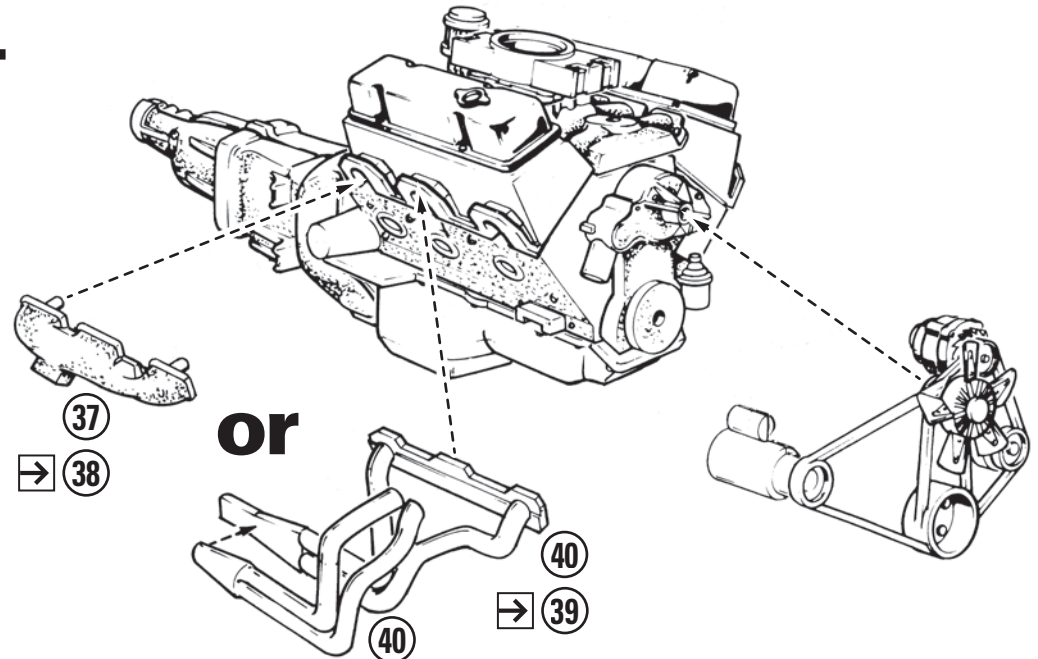

5

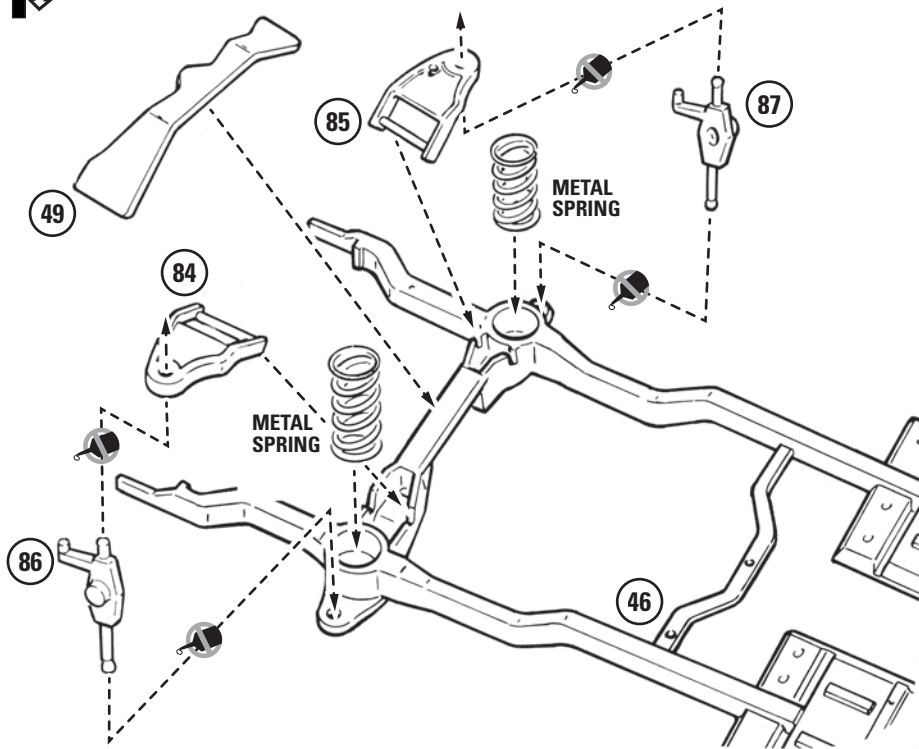

6

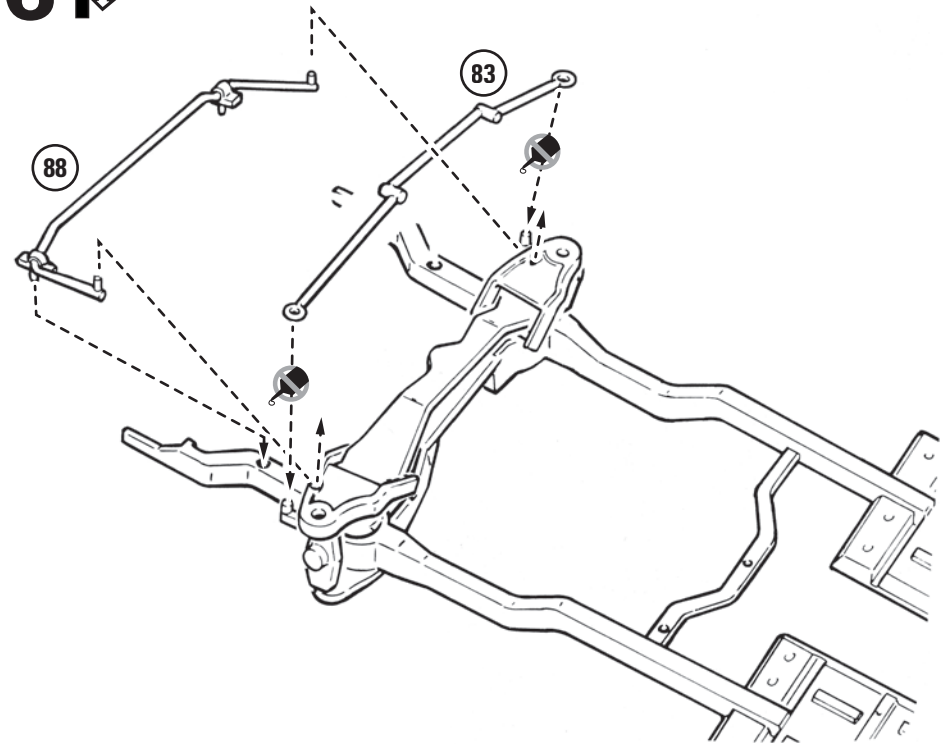

7

STOCK ONLY

NOTE: Do not use stock exhaust system on engines with headers.

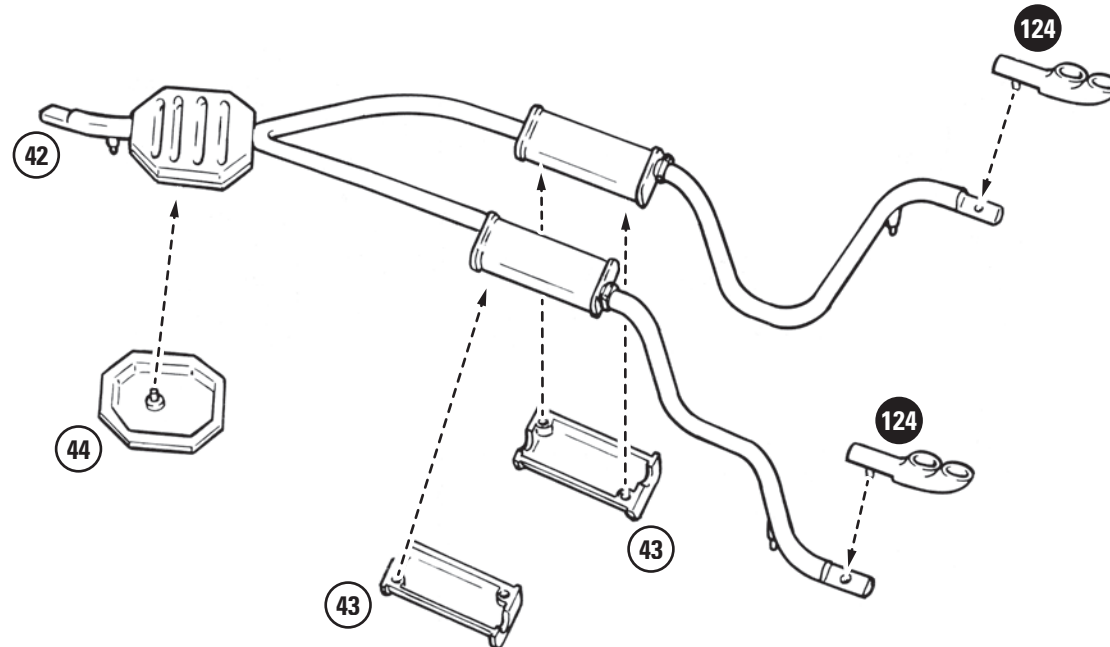

8

STOCK ONLY

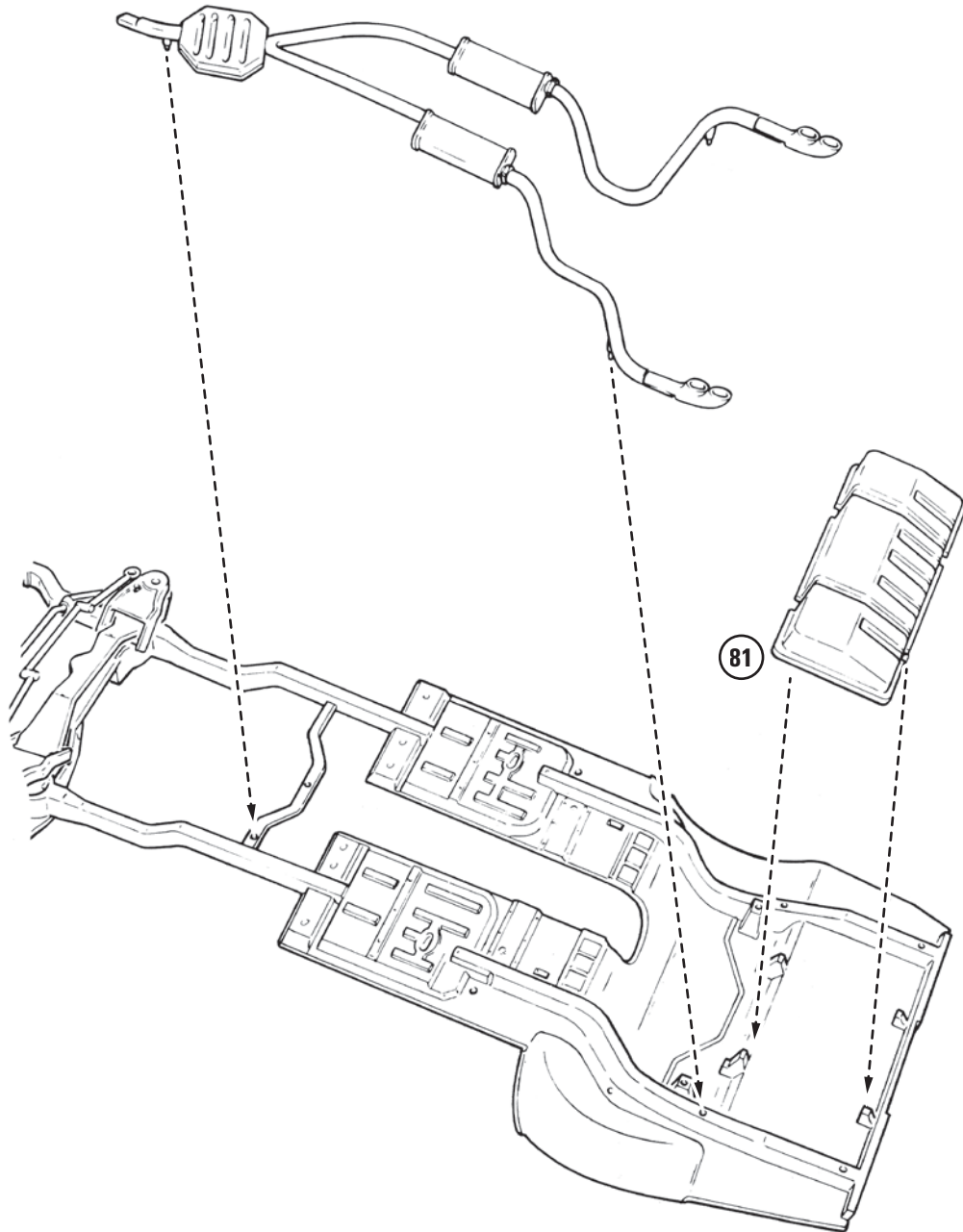

9

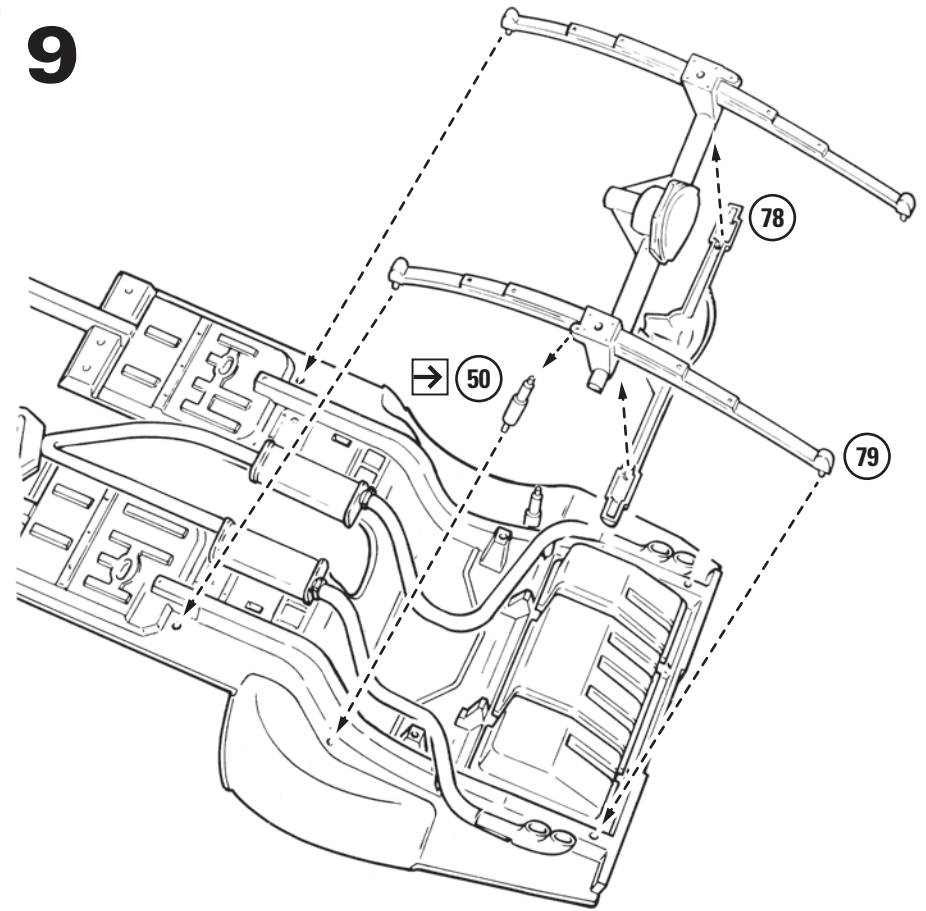

10

OPTIONAL

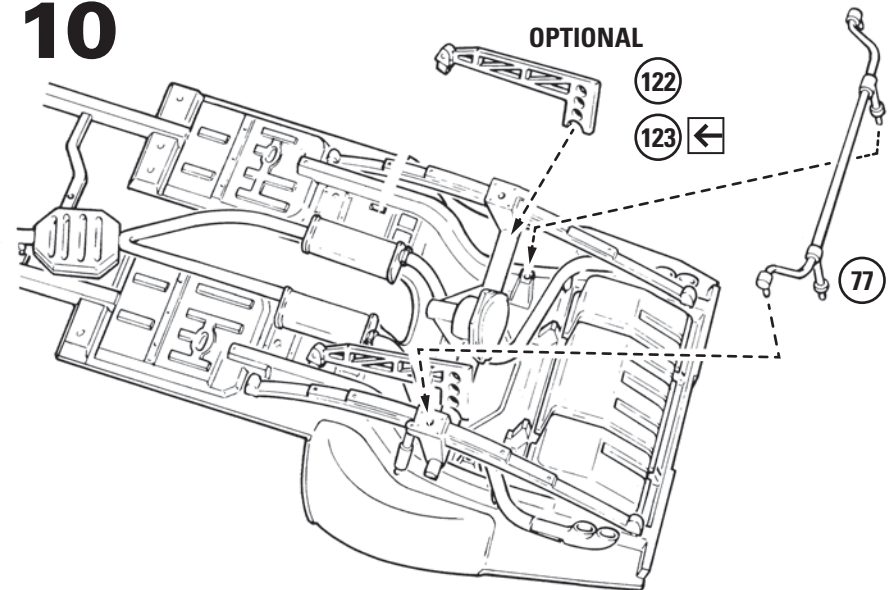

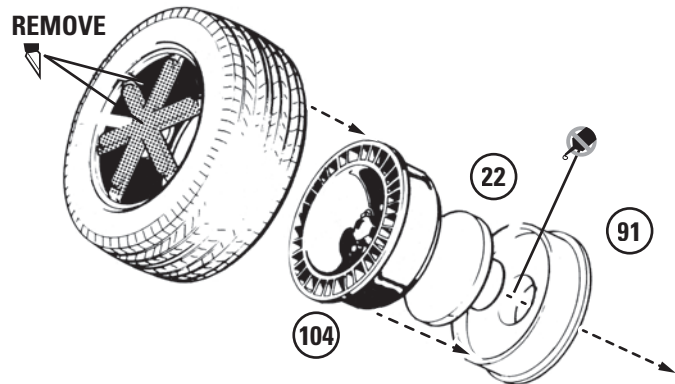
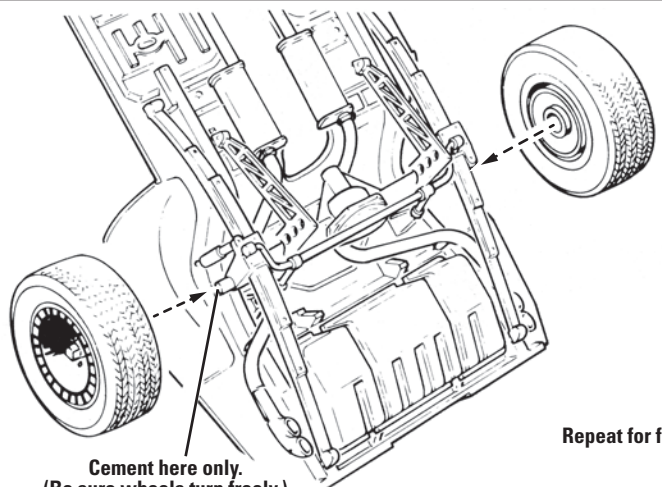
11 x4**12**

Repeat for front.

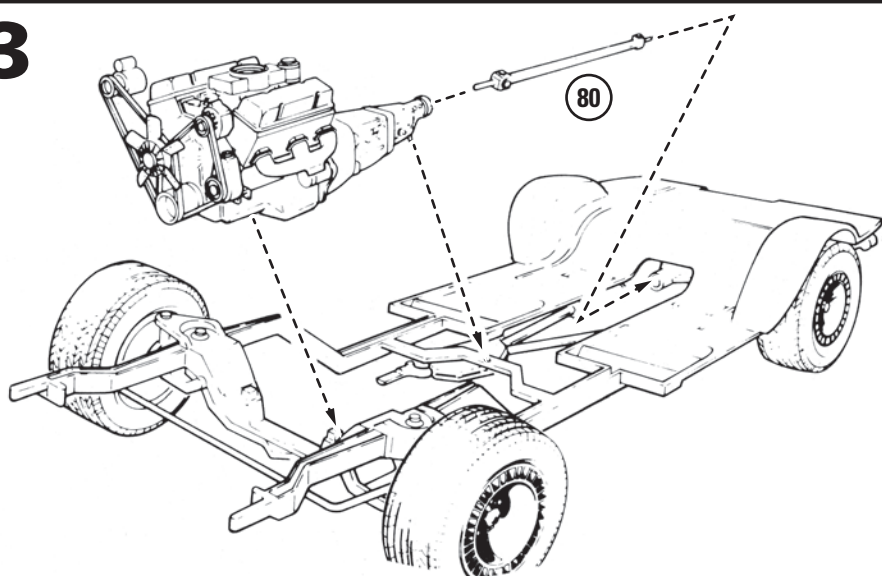
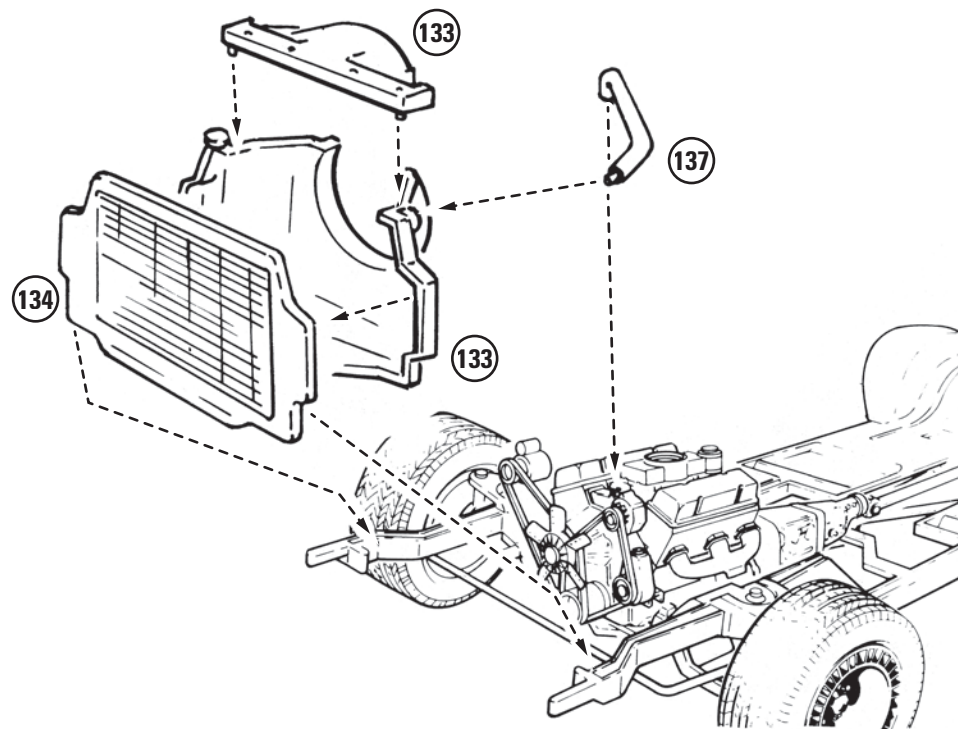
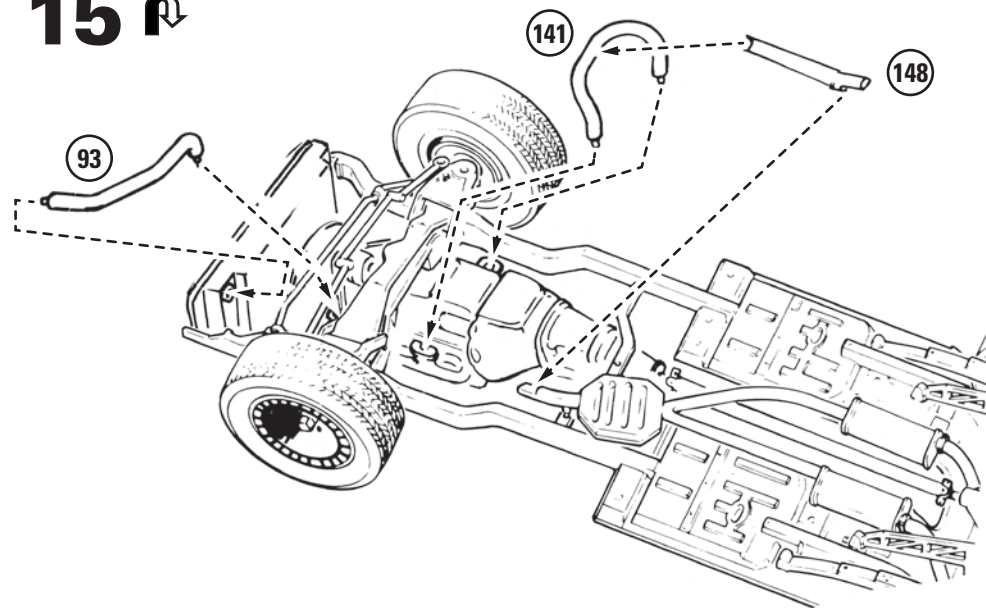
13**14****15** ↺

16

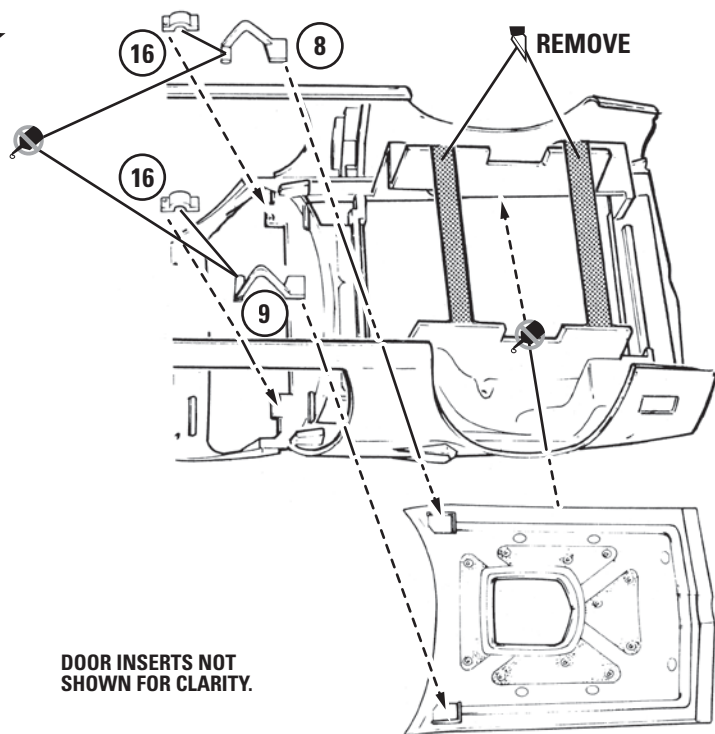

DOOR INSERTS NOT SHOWN FOR CLARITY.

NOTE: Tape hood into position while assembling the hinges.

17

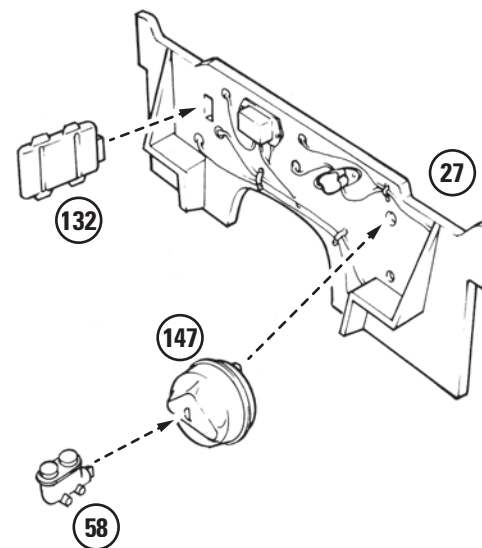

18

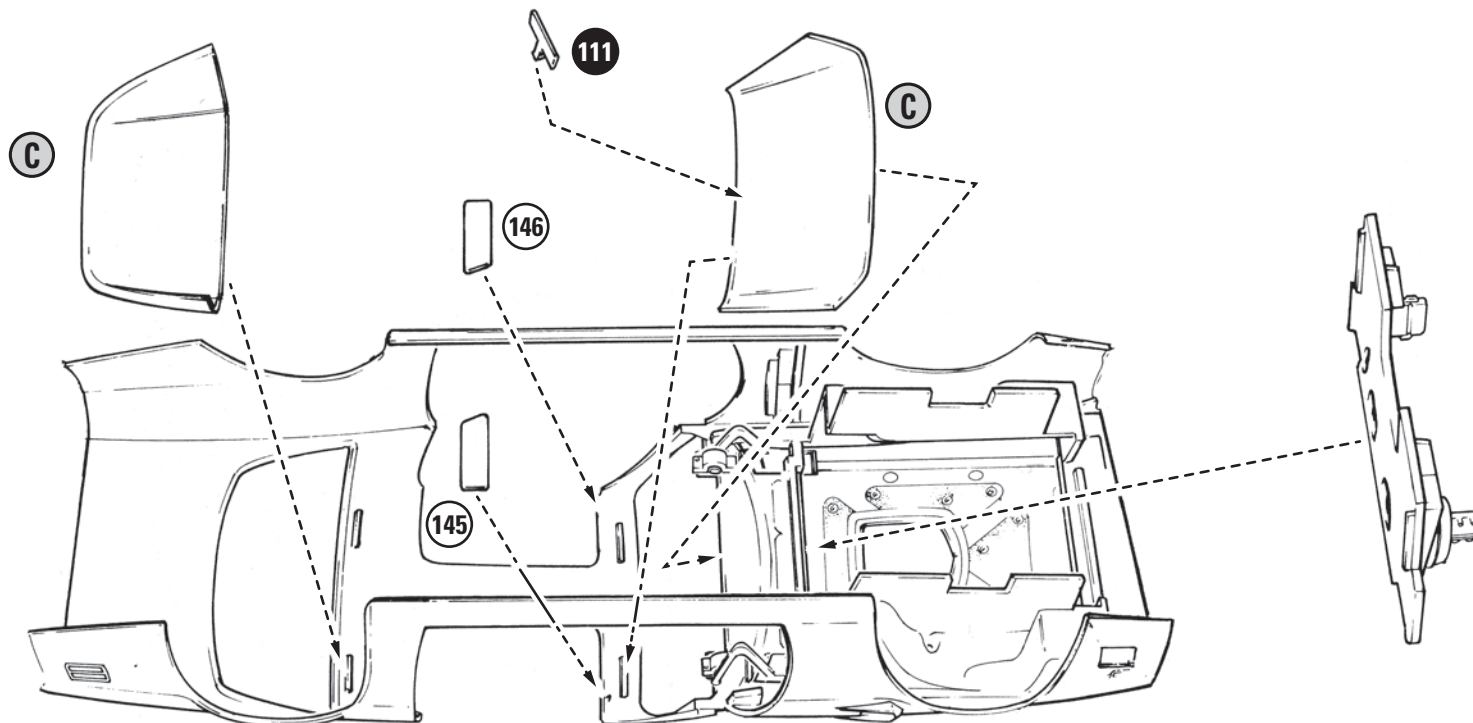

DOOR INSERTS NOT SHOWN FOR CLARITY.

19

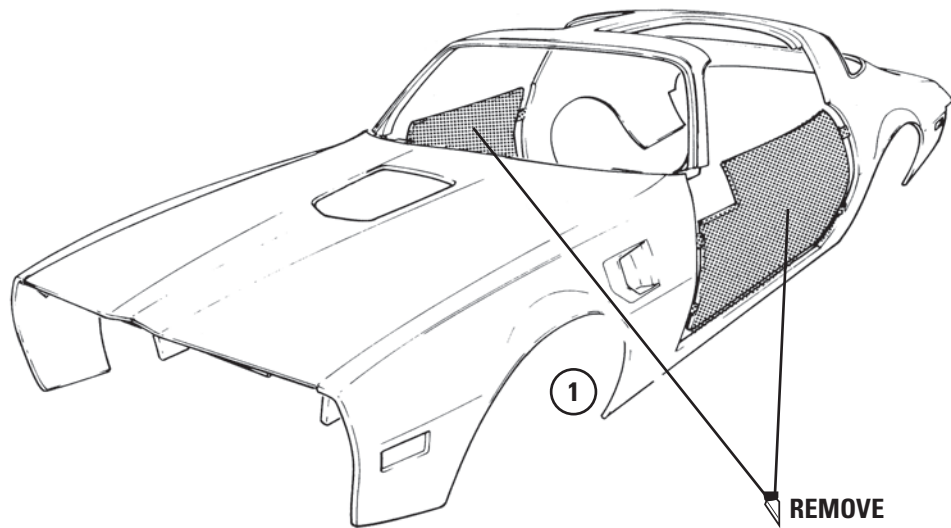

20

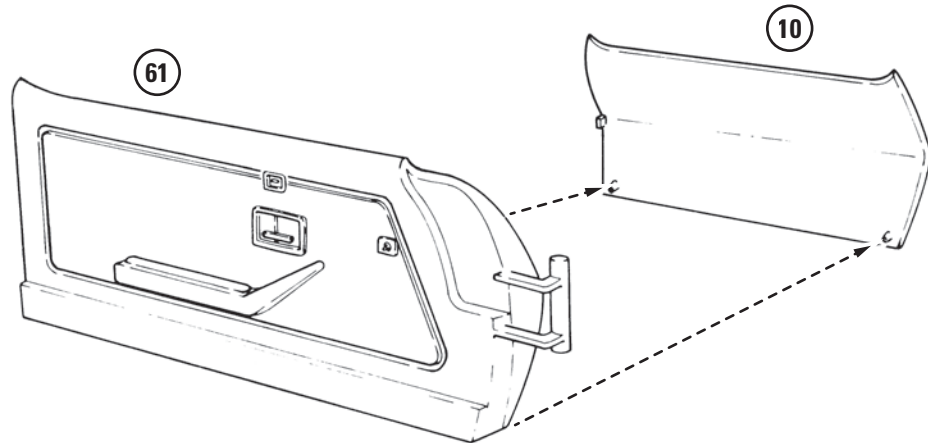

21

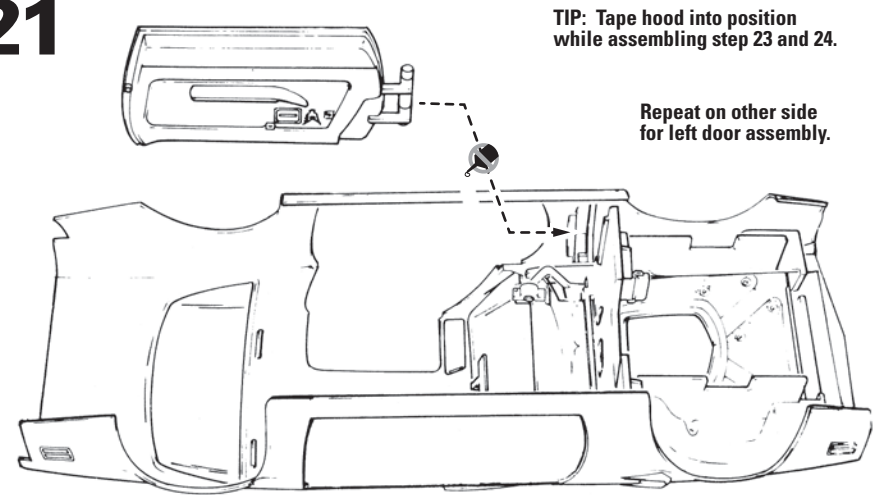

22

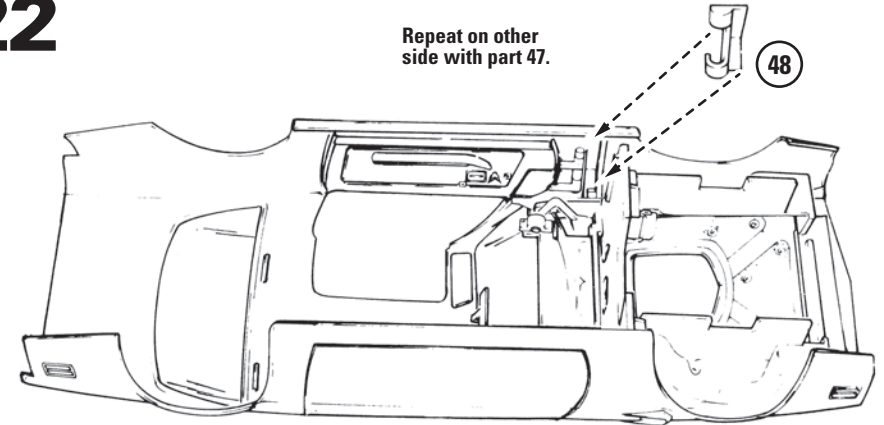

23

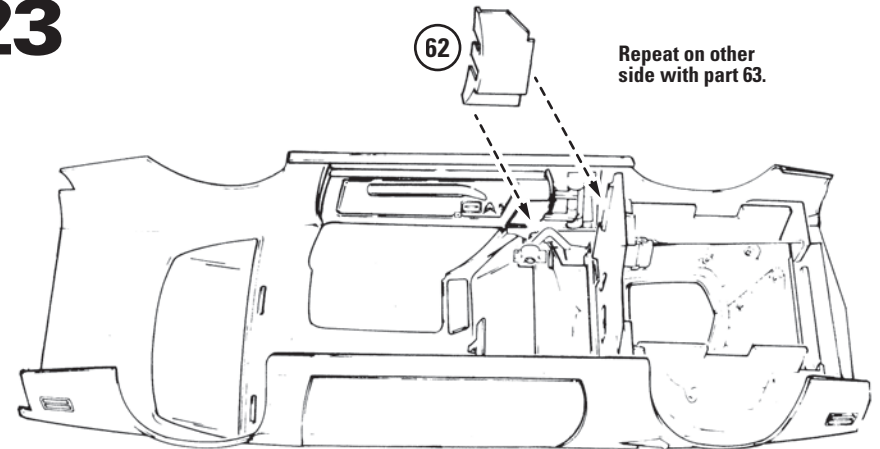

24

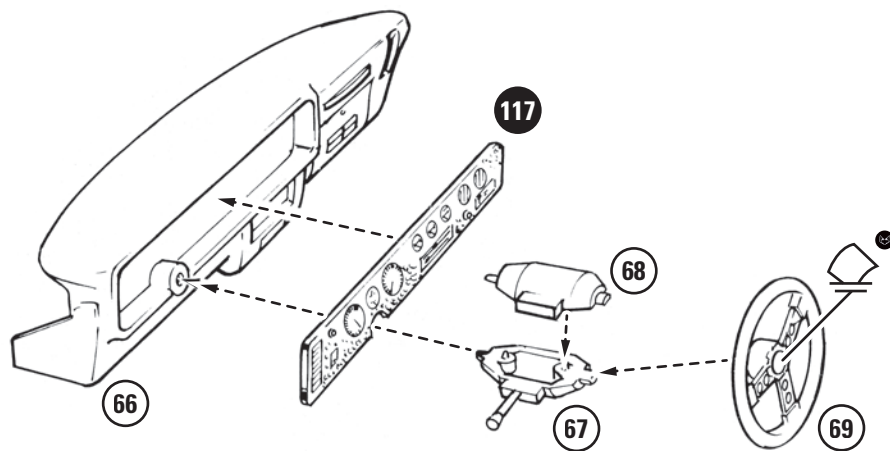

27

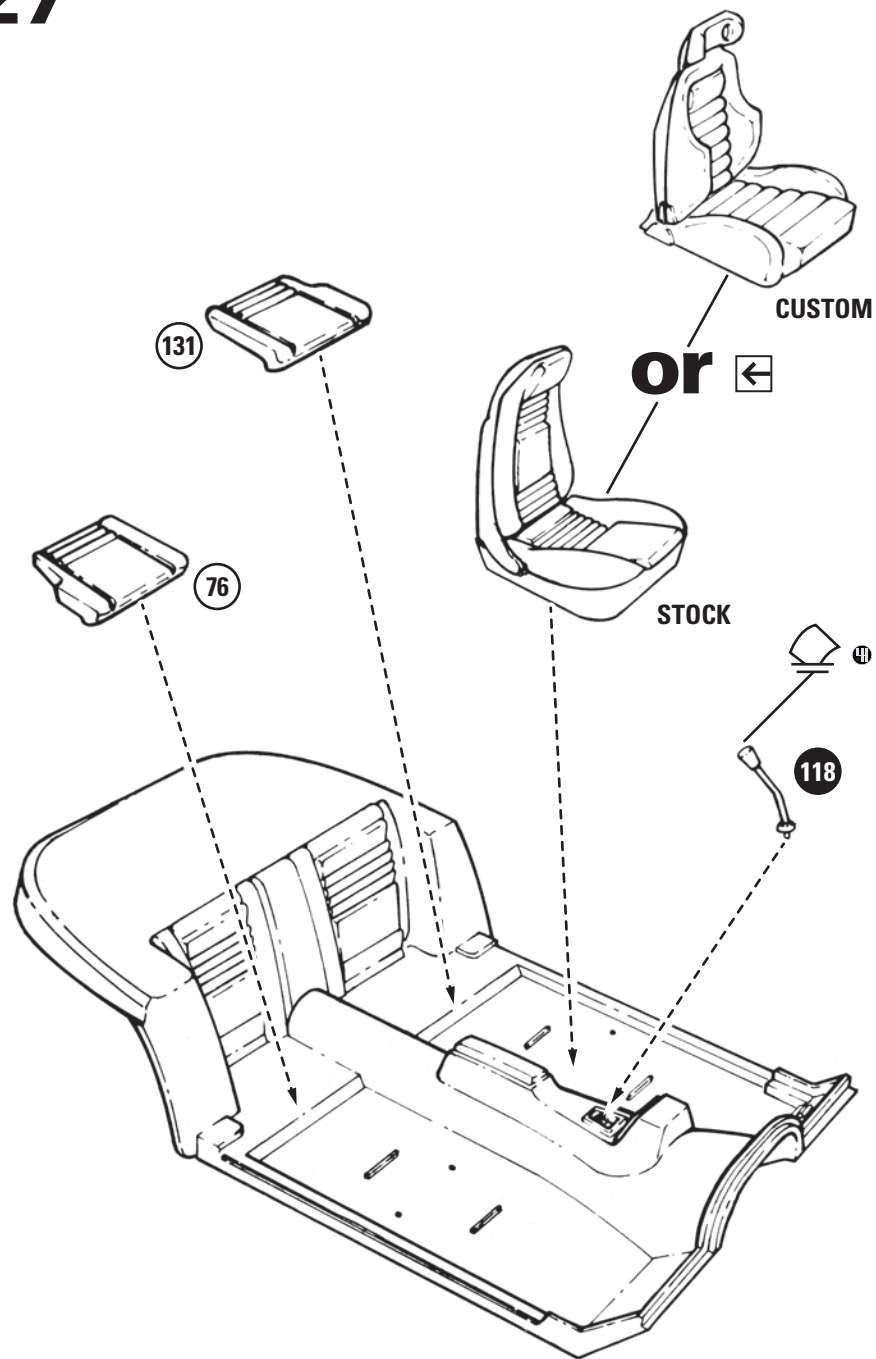

25 STOCK

TIP: Hold top half of seat in place while cementing parts 72 and 73 together.

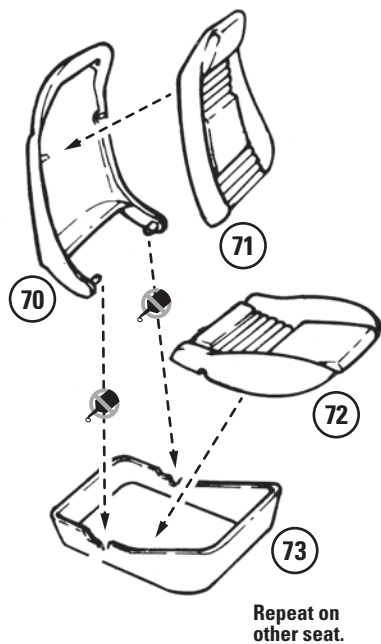

26 OPTIONAL CUSTOM SEATS

Repeat on other seat.

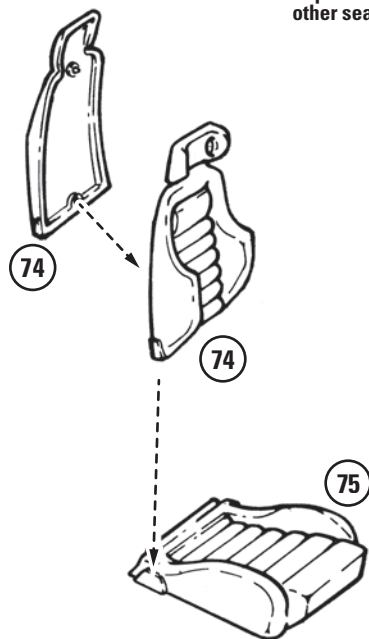

28 

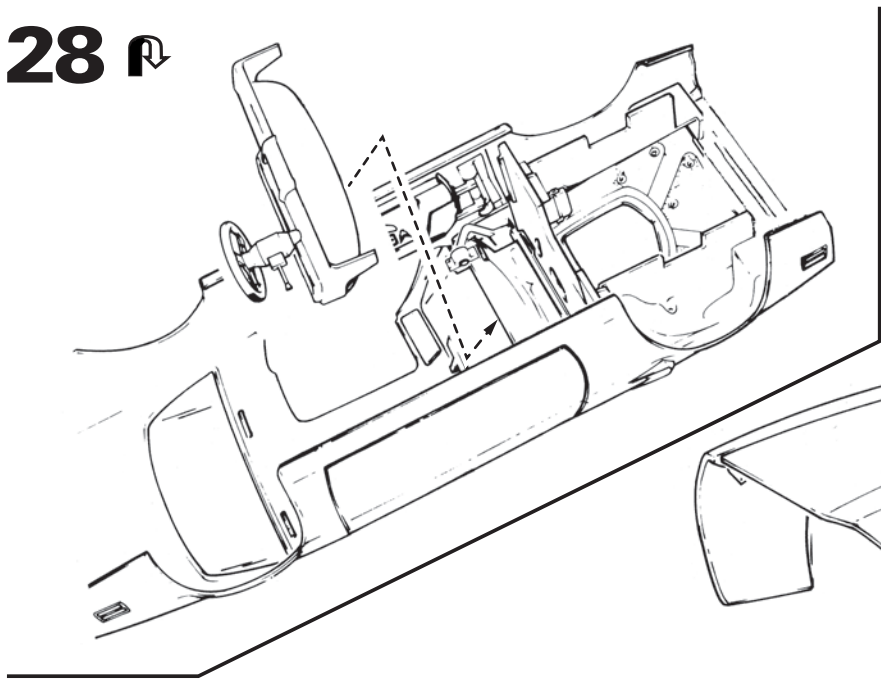

29

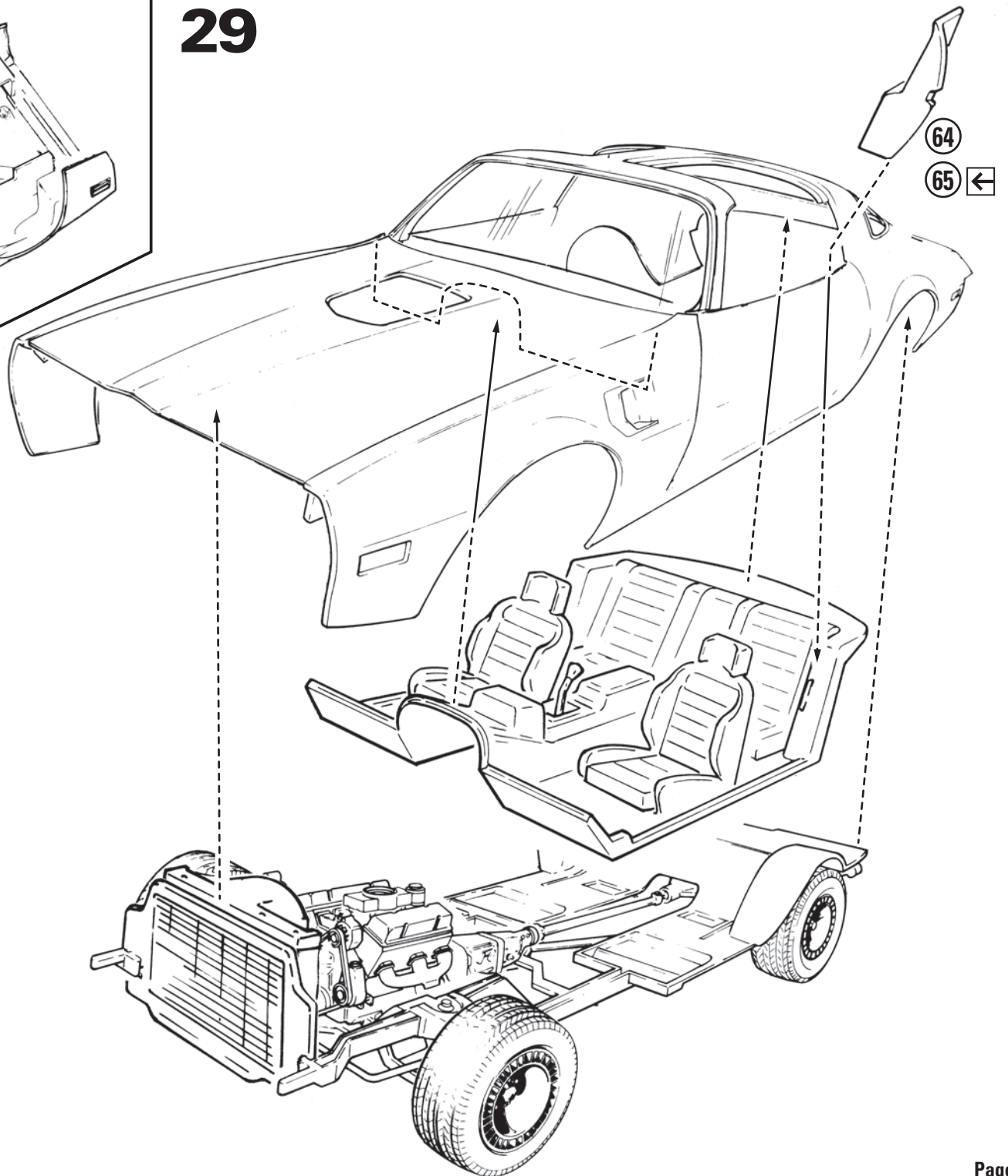

30

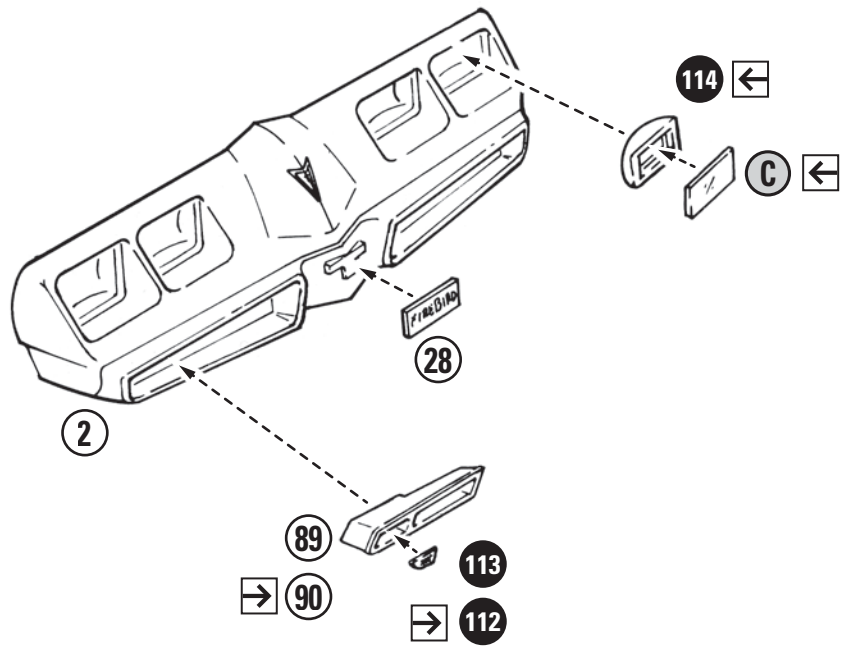

31

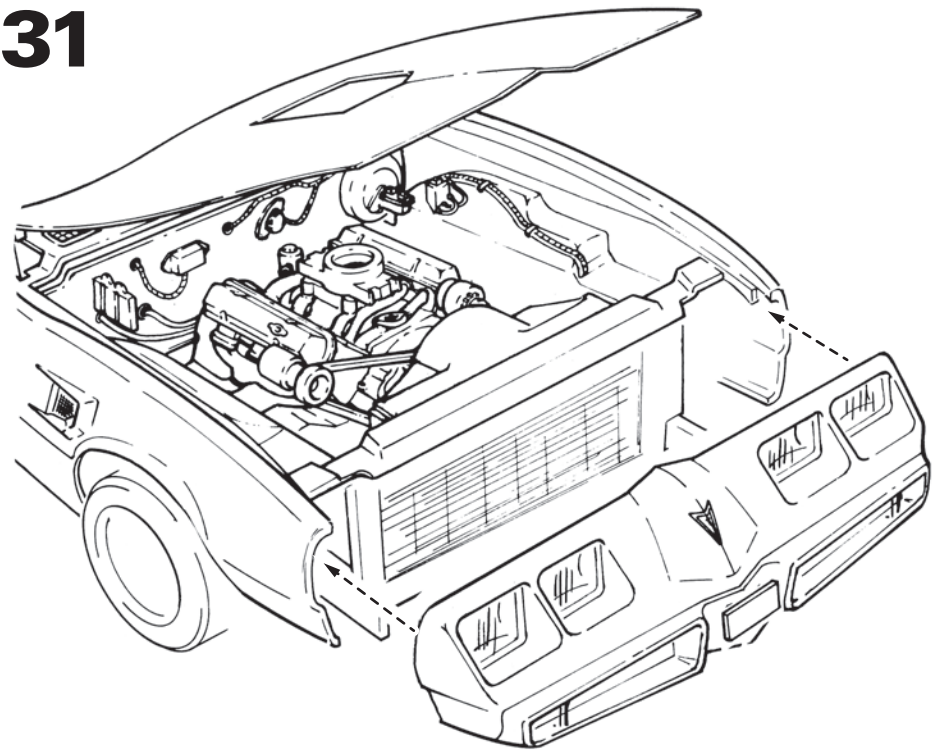

32

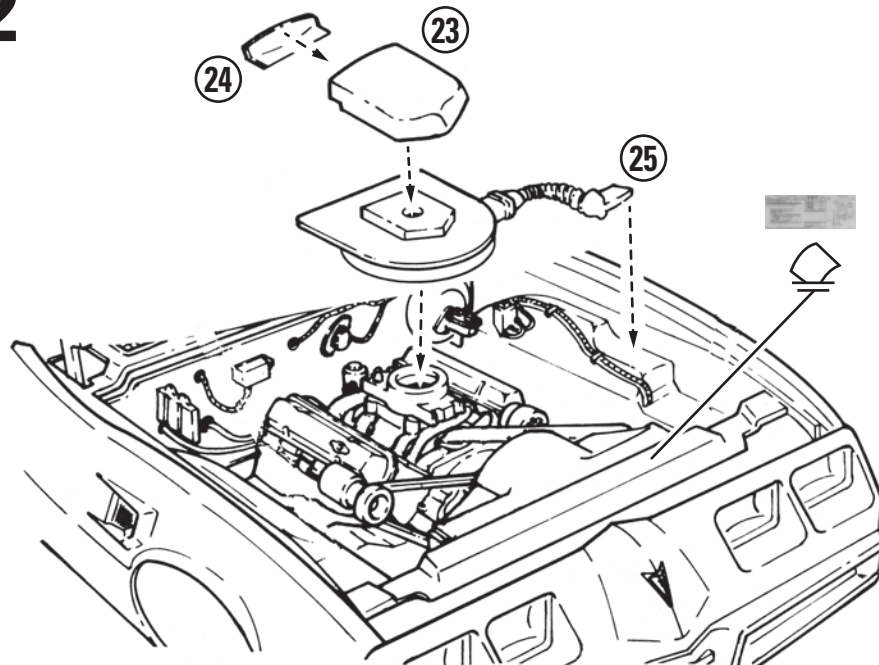

33

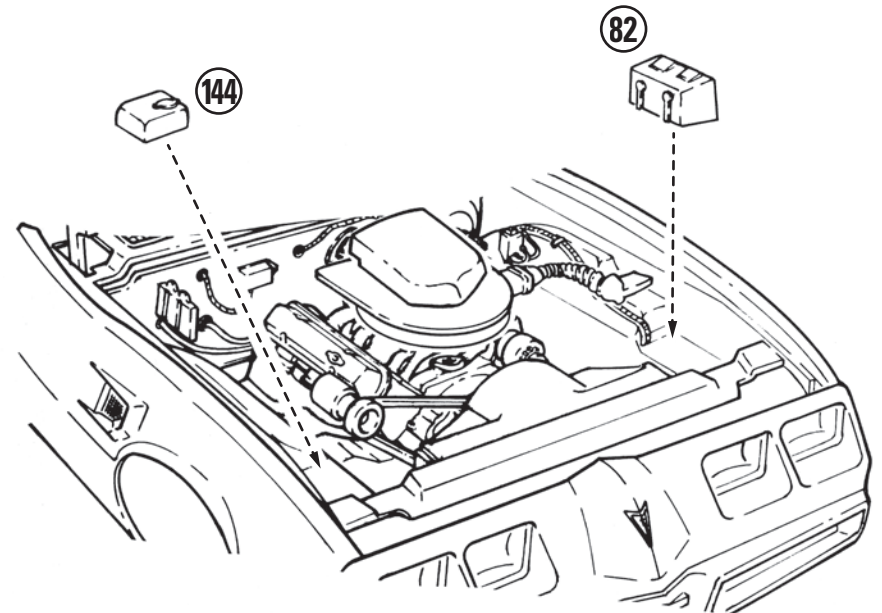

34

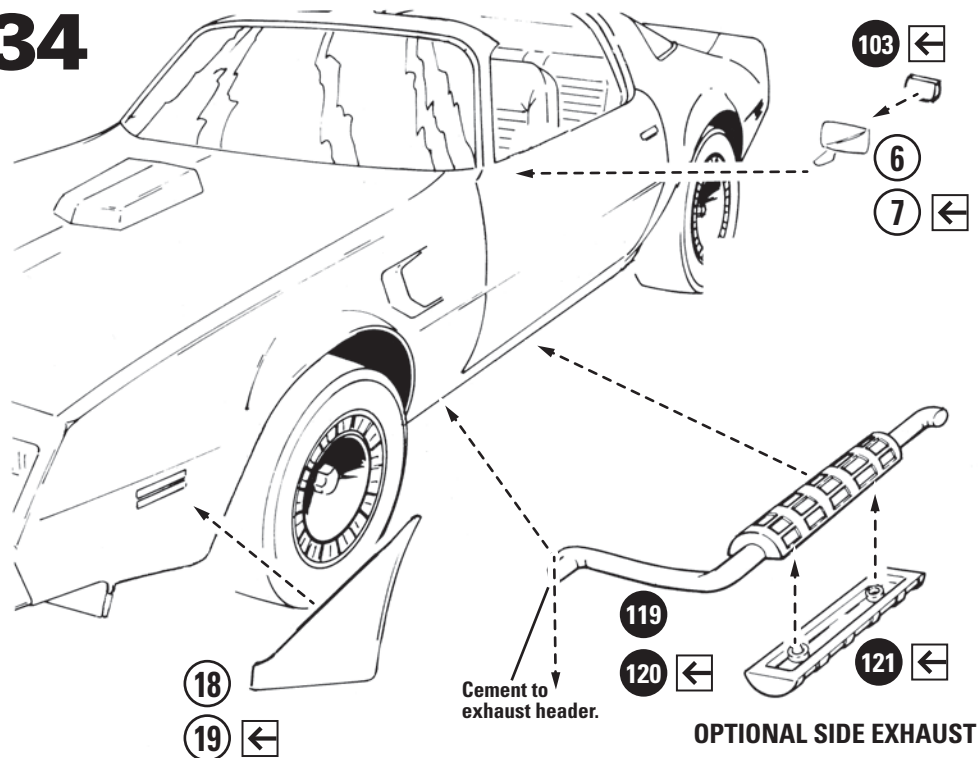

35

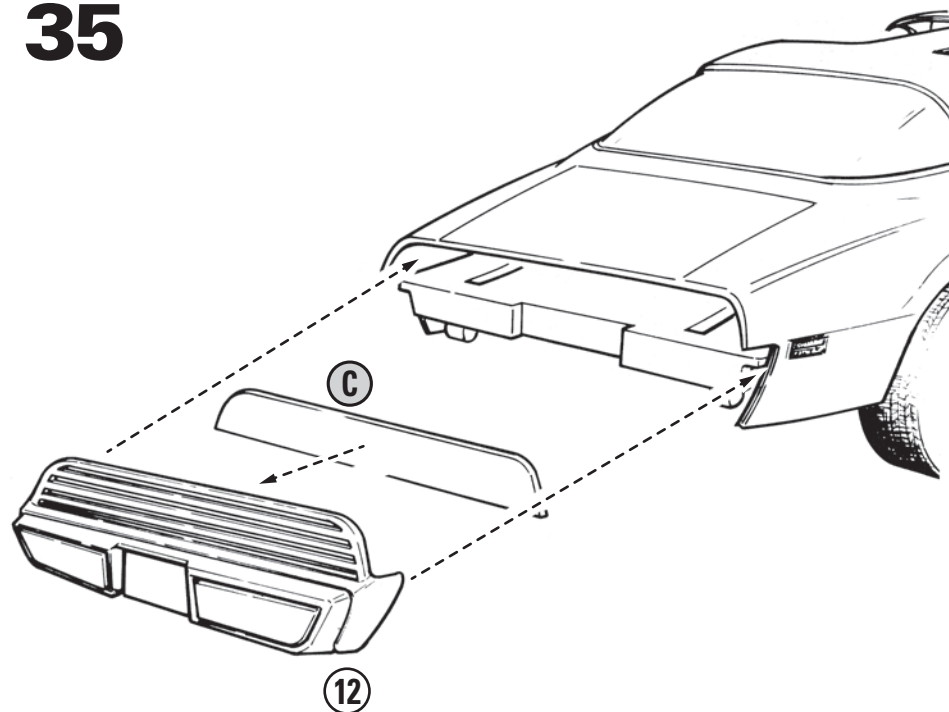

36

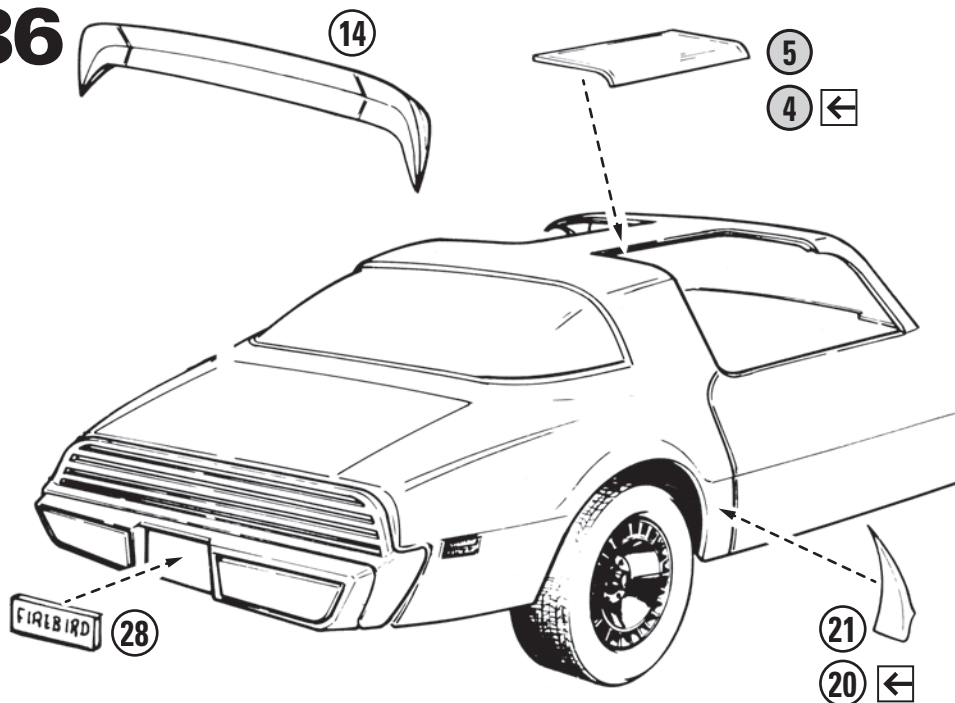

Decal Placement

NOTE: For ease of applying your decals, they are separated on the sheet. For the experienced modeler, you may still use a modelers knife and cut close to the image. When applying decals, be sure to follow the instructions as written.

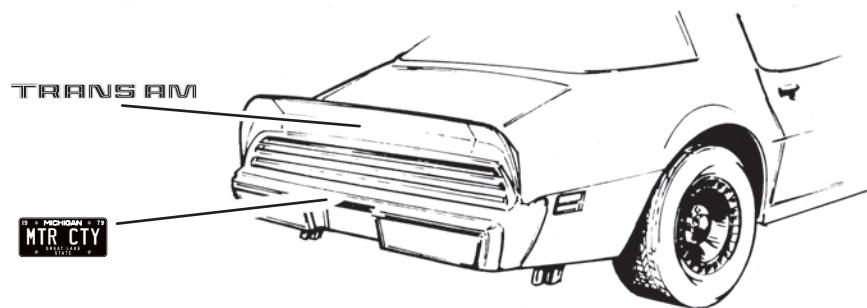

Decal Placement continued



GENERAL MOTORS Trademarks used under license to Round 2, LLC. Goodyear (and wing foot design) is a trademark of The Goodyear Tire & Rubber Company, Akron, Ohio USA used under license by Round 2, LLC. MPC and design and Round 2 and design are trademarks of Round 2, LLC. ©2017 Round 2, LLC, South Bend, IN 46628 USA. Product and packaging designed in the USA. Made in China. All rights reserved.

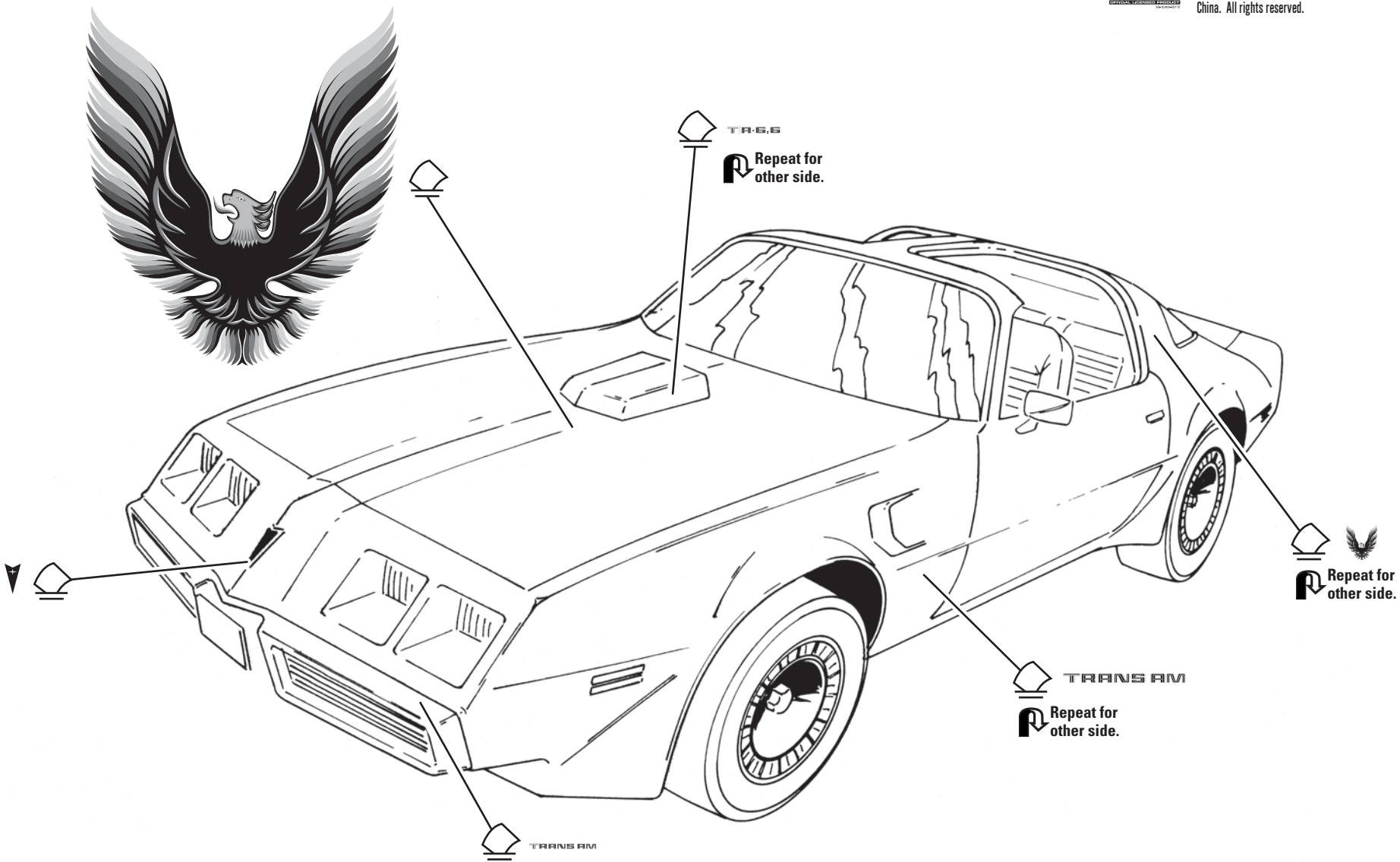

PAINTING

- 1. Use only paint for styrene plastic.
- 2. Allow paint to dry thoroughly, before handling.
- 3. Scrape paint from any area which is to be cemented.

PAINTING HINTS/SUGGESTIONS

A	SILVER	F	INTERIOR
B	FLAT BLACK	G	BODY COLOR
C	GLOSS BLACK	H	YELLOW
D	WHITE	I	ORANGE
E	GREY	J	BLUE