



mpc Presents
GODZILLA
PLANETARY DEFENSE JEEP
As Featured In
**INVASION OF
ASTRO-MONSTER!**
1/25 SCALE PLASTIC ASSEMBLY KIT

Before you begin building, look over the instructions carefully. Following the procedure given, test fit parts together without cementing. This way you will be more familiar with the location of parts when it becomes time to use cement.

For removing small parts from the "runners" it is best to use a modelers knife. Do not attempt to "twist" them off.

The highest quality styrene plastic goes into the making of each MPC model. Only paint and cement for styrene should be used. Before joining parts, trim off excess plastic or "flash." To join parts use cement sparingly. Apply cement to small parts with a toothpick.

You should have no trouble assembling your kit if the instructions are followed properly.

1 ASSEMBLY NUMBERS 101 PART NUMBERS IMPORTANT: READ ALL NOTES AND TEST FIT PARTS BEFORE ASSEMBLING

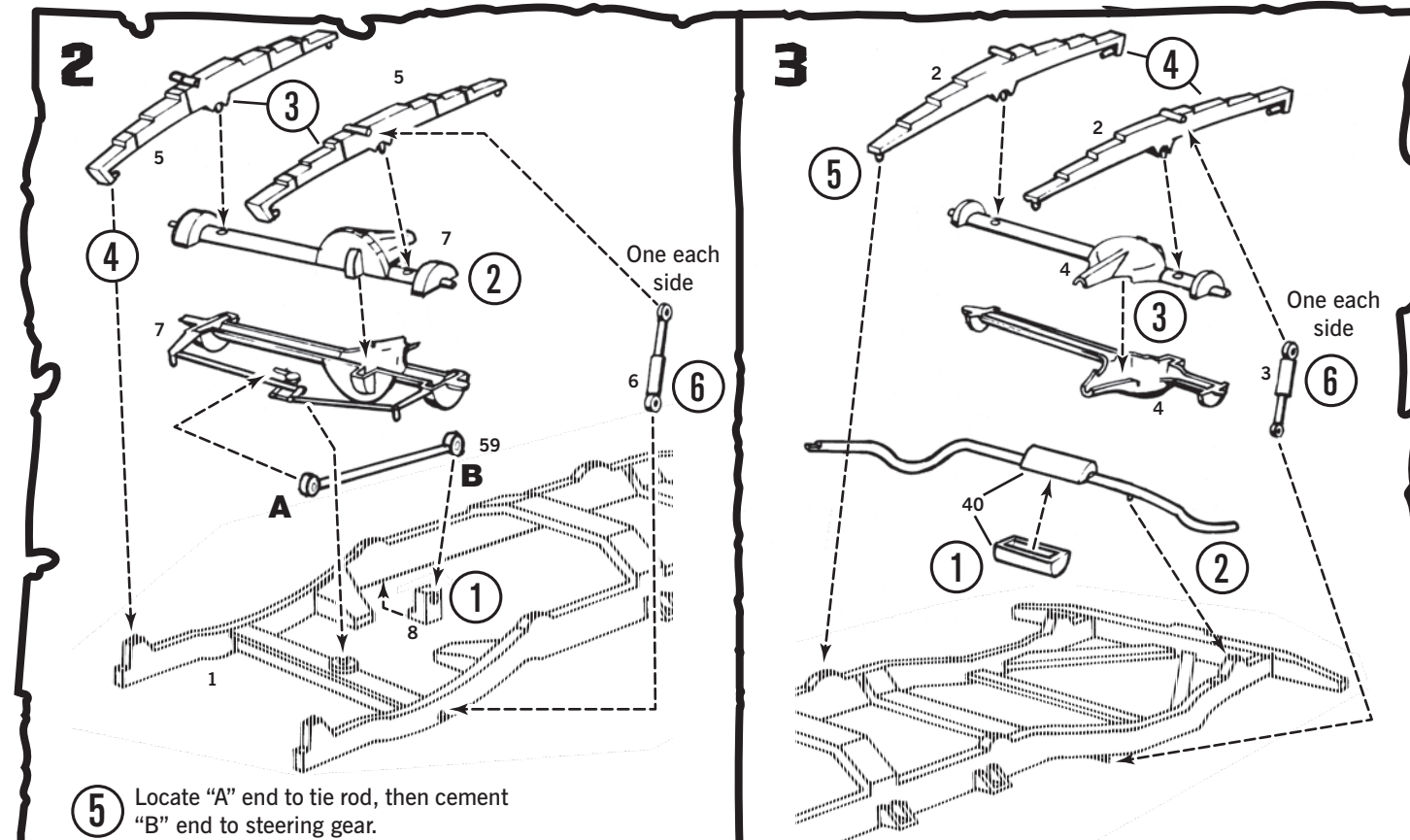
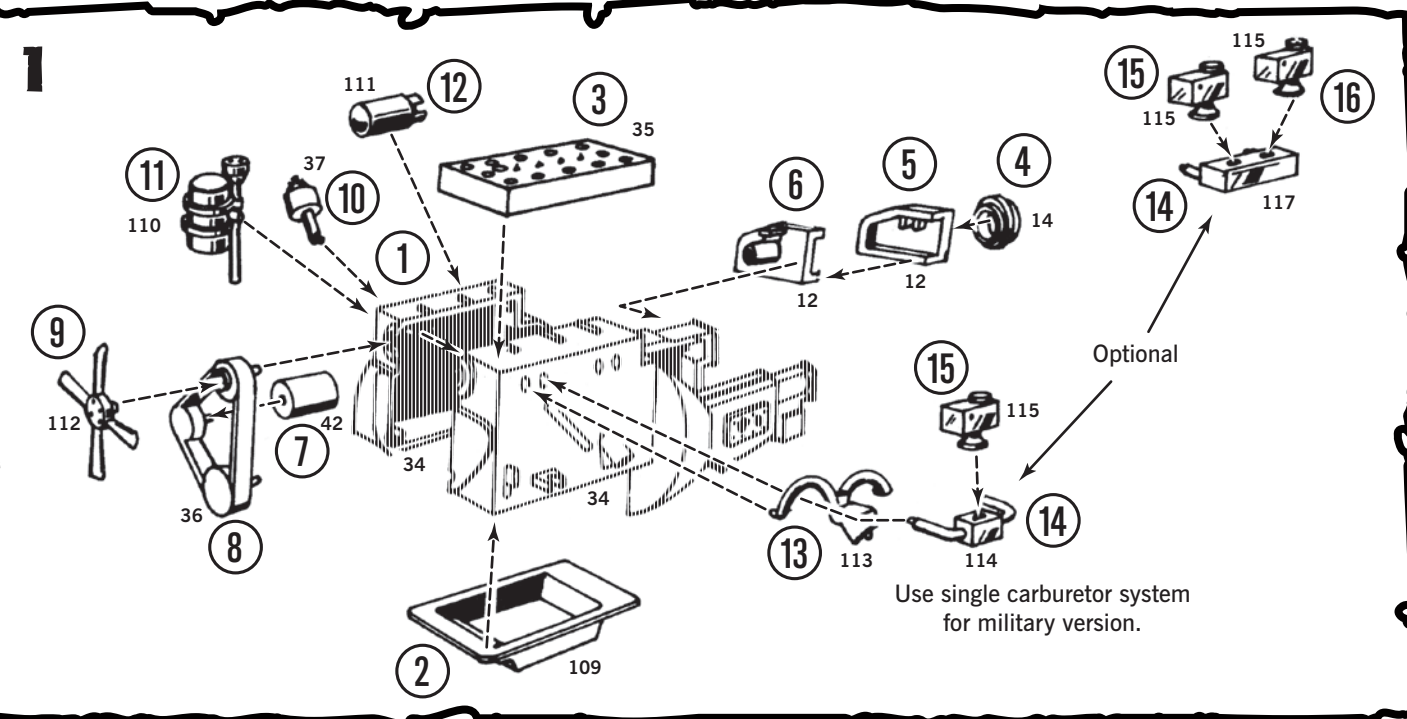

5 Locate "A" end to tie rod, then cement "B" end to steering gear.

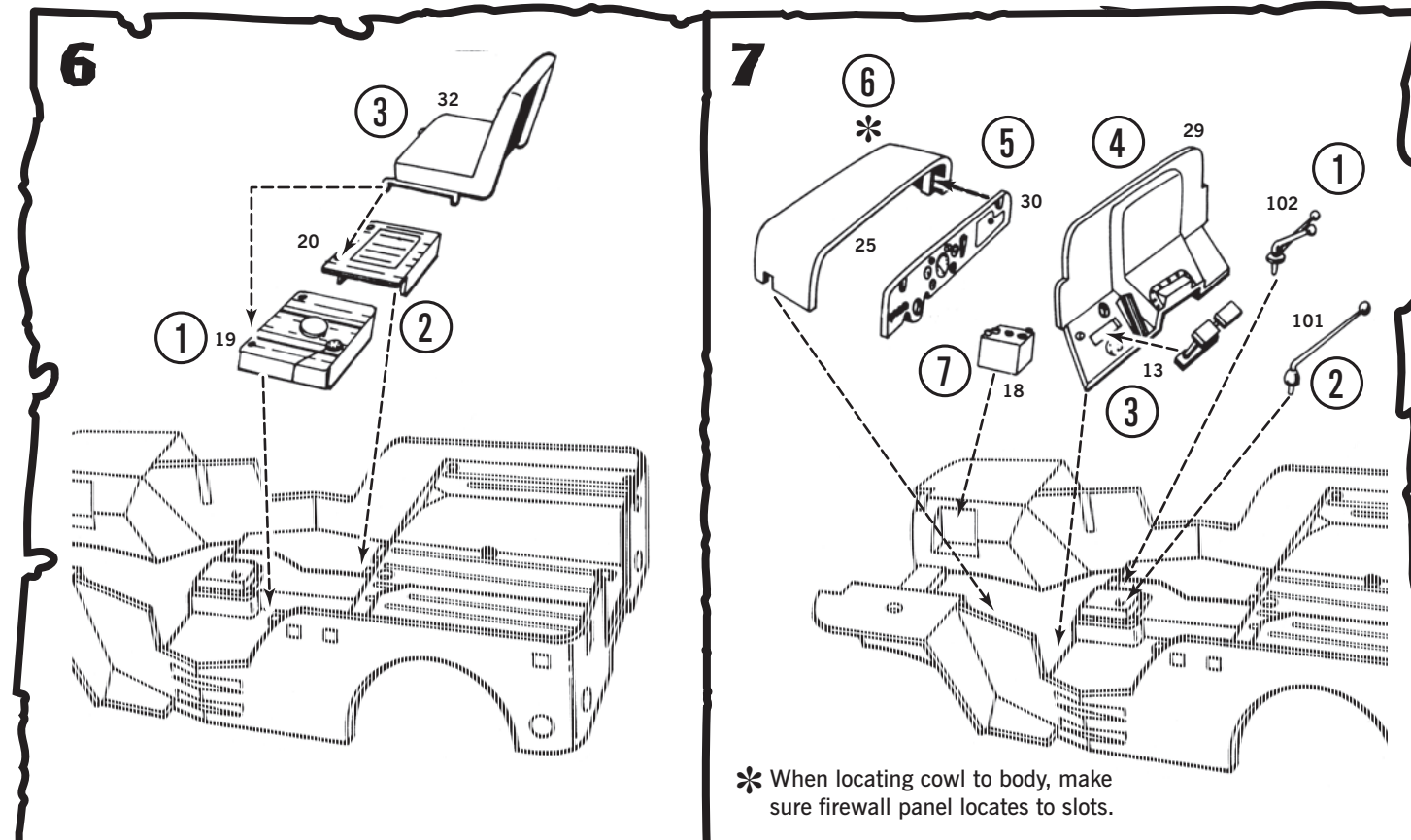
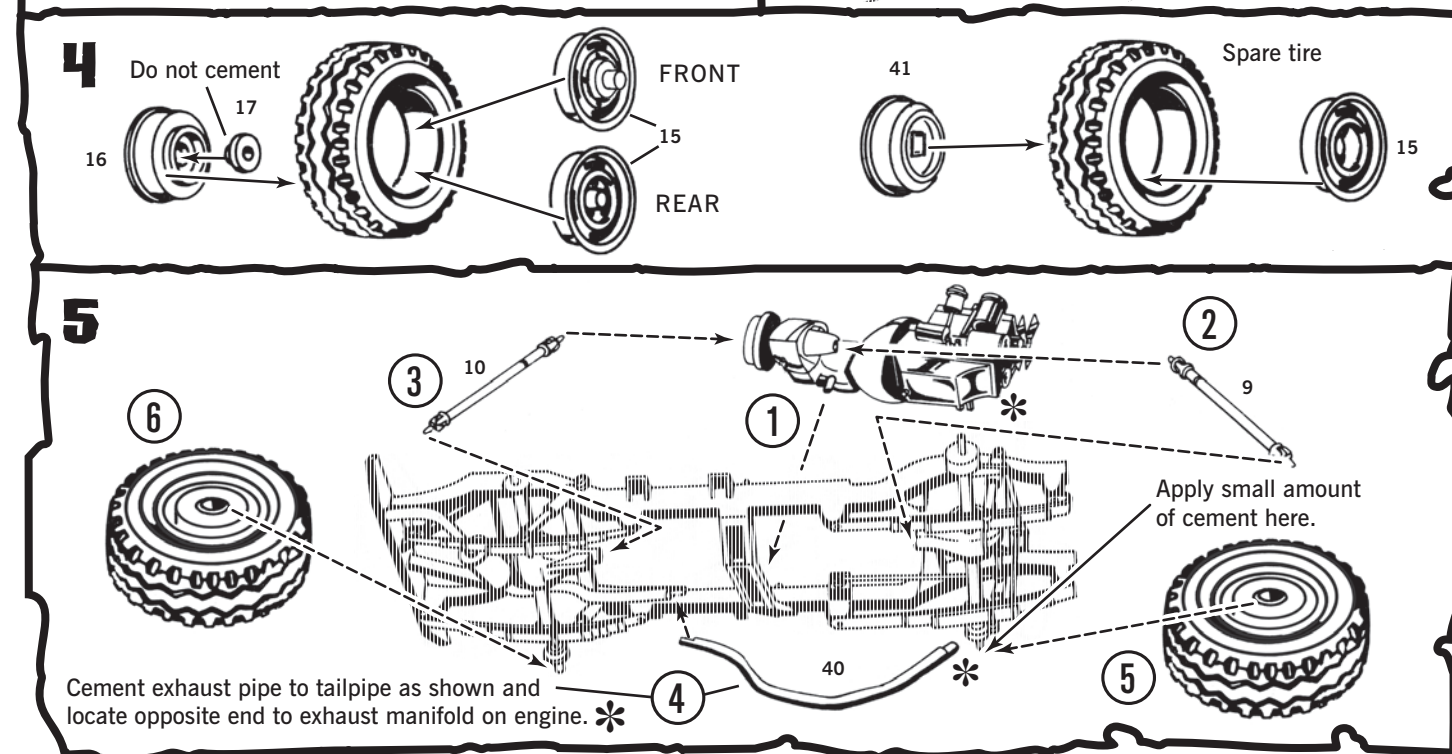

* When locating cowl to body, make sure firewall panel locates to slots.

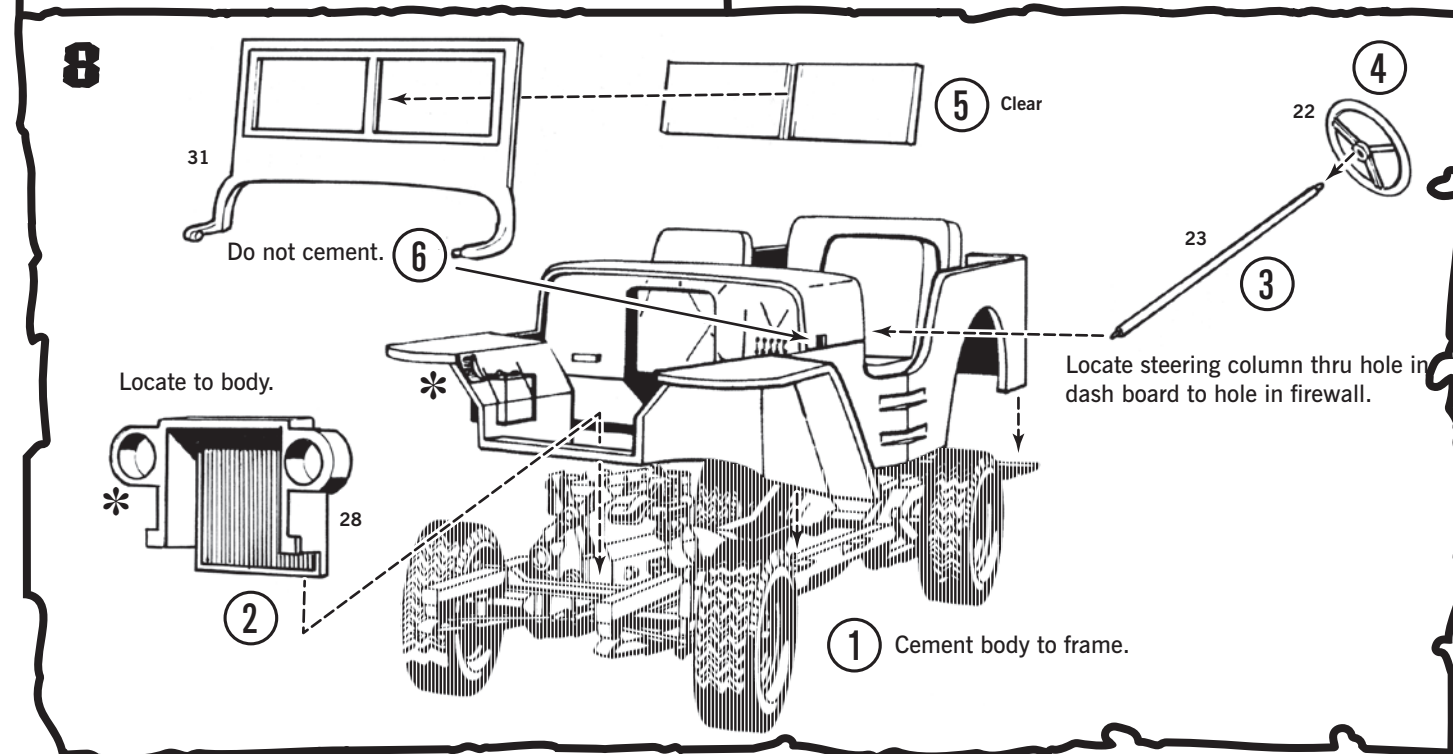

9

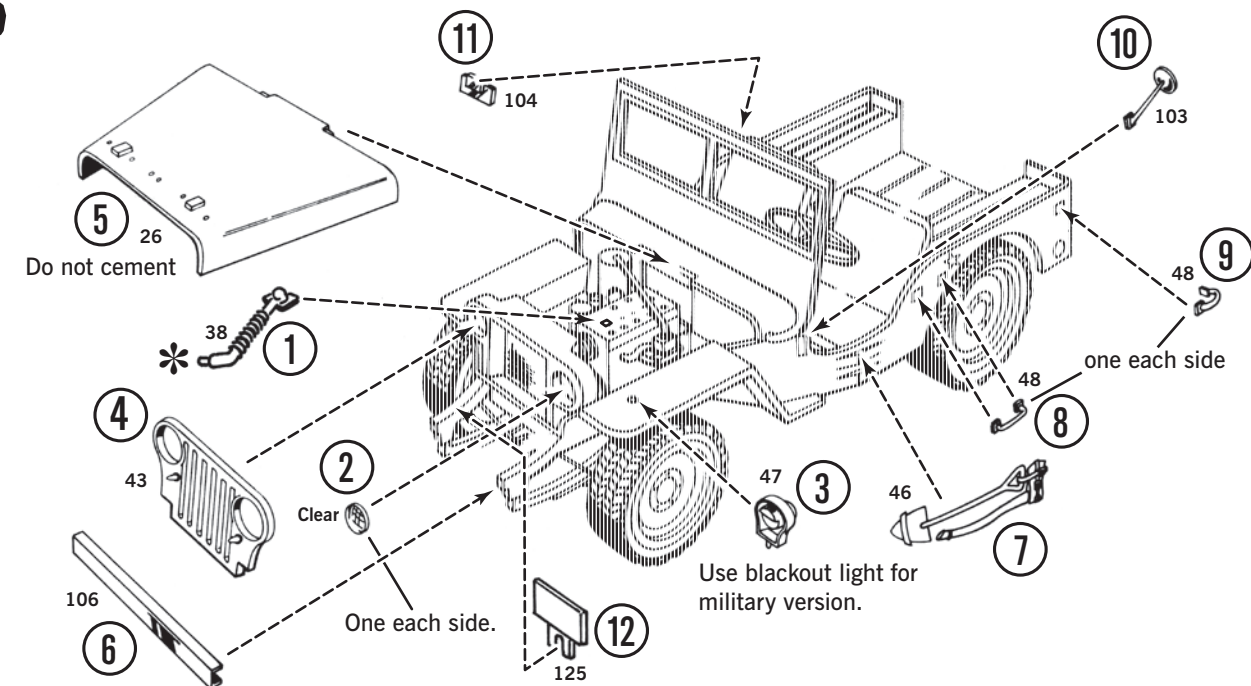

10

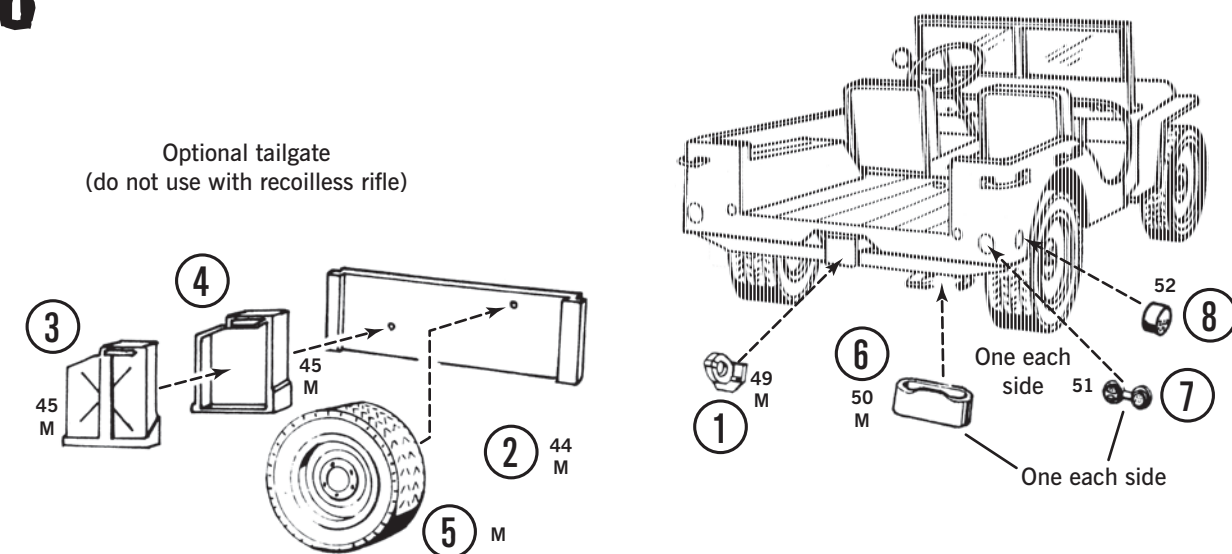

©Toho Co., Ltd. All rights reserved. Jeep and the Jeep grille and related logos, vehicle model names and trade dress are trademarks of FCA US LLC and used under license by Round 2 LLC. © 2019 FCA US LLC. Goodyear (and wing foot design) and Eagle are trademarks of The Goodyear Tire & Rubber Company, Akron, Ohio USA used under license by Round 2, LLC. Round 2 and MPC are registered trademarks of Round 2, LLC. ©2019 Round 2, LLC, South Bend, IN 46628 USA. Product and packaging designed in the USA. Made in China. All rights reserved.

11

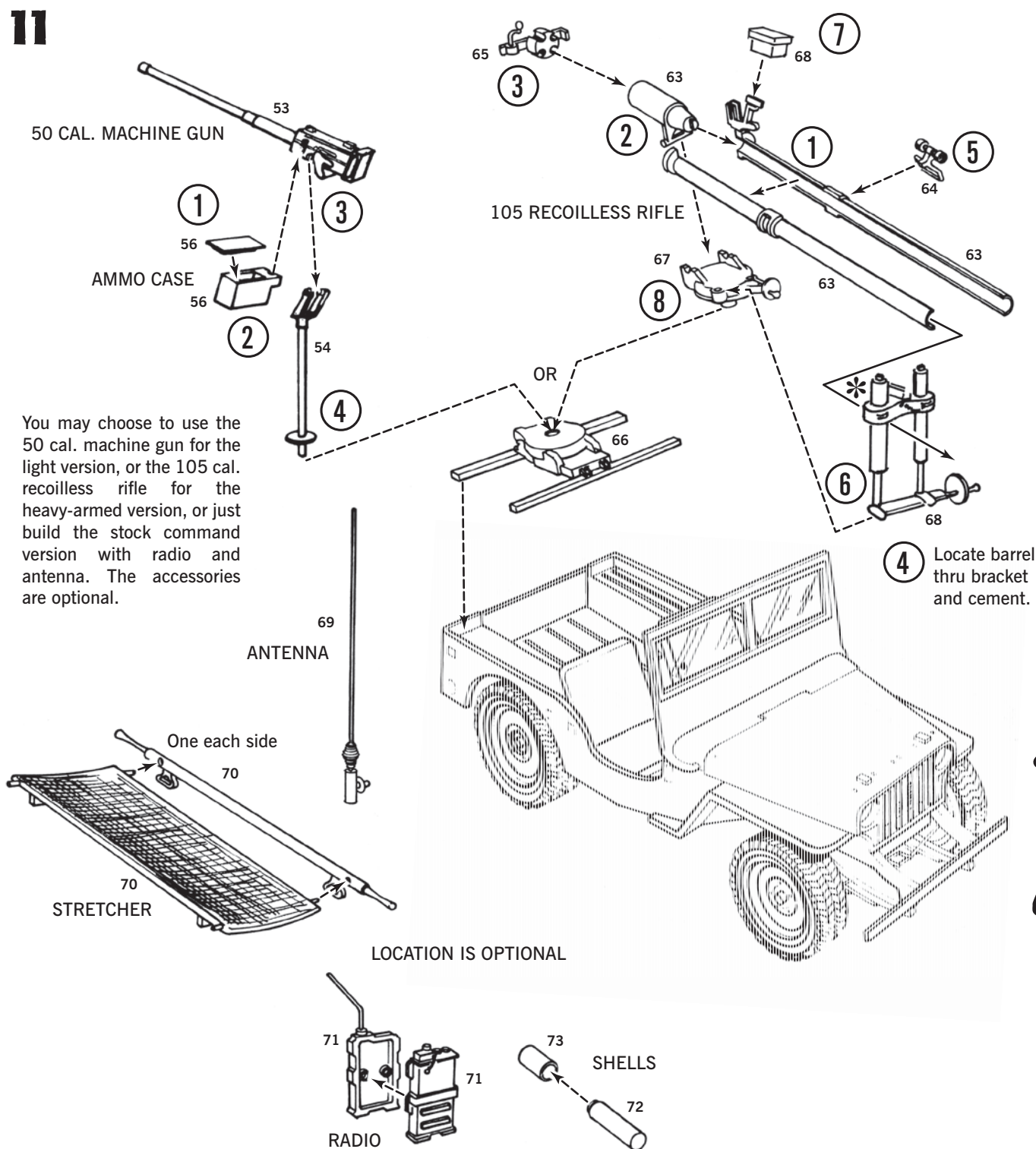

12

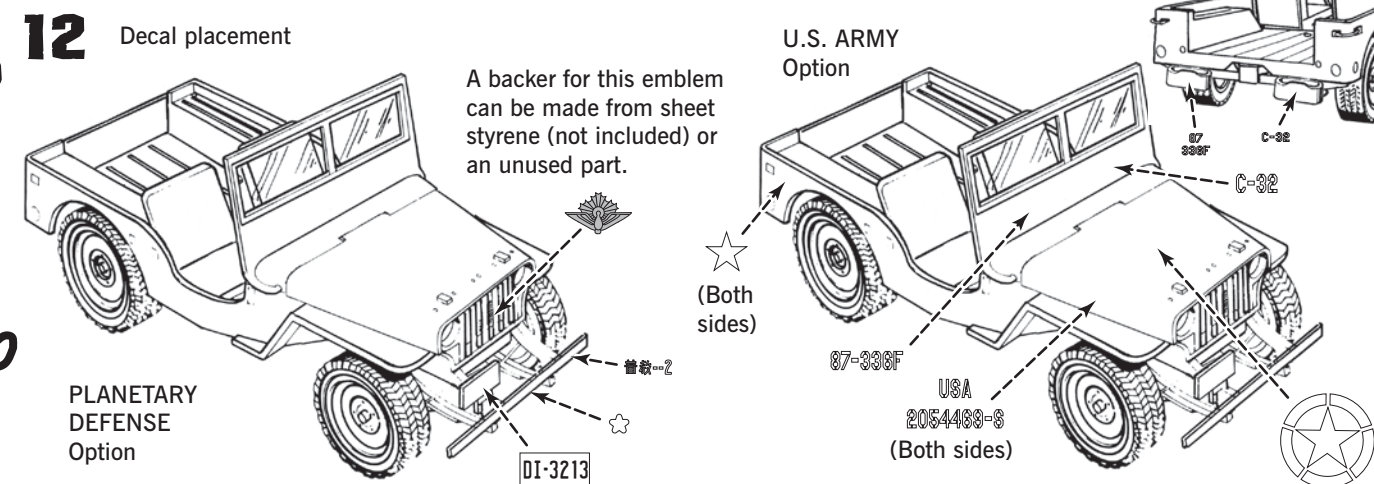

13

