

7

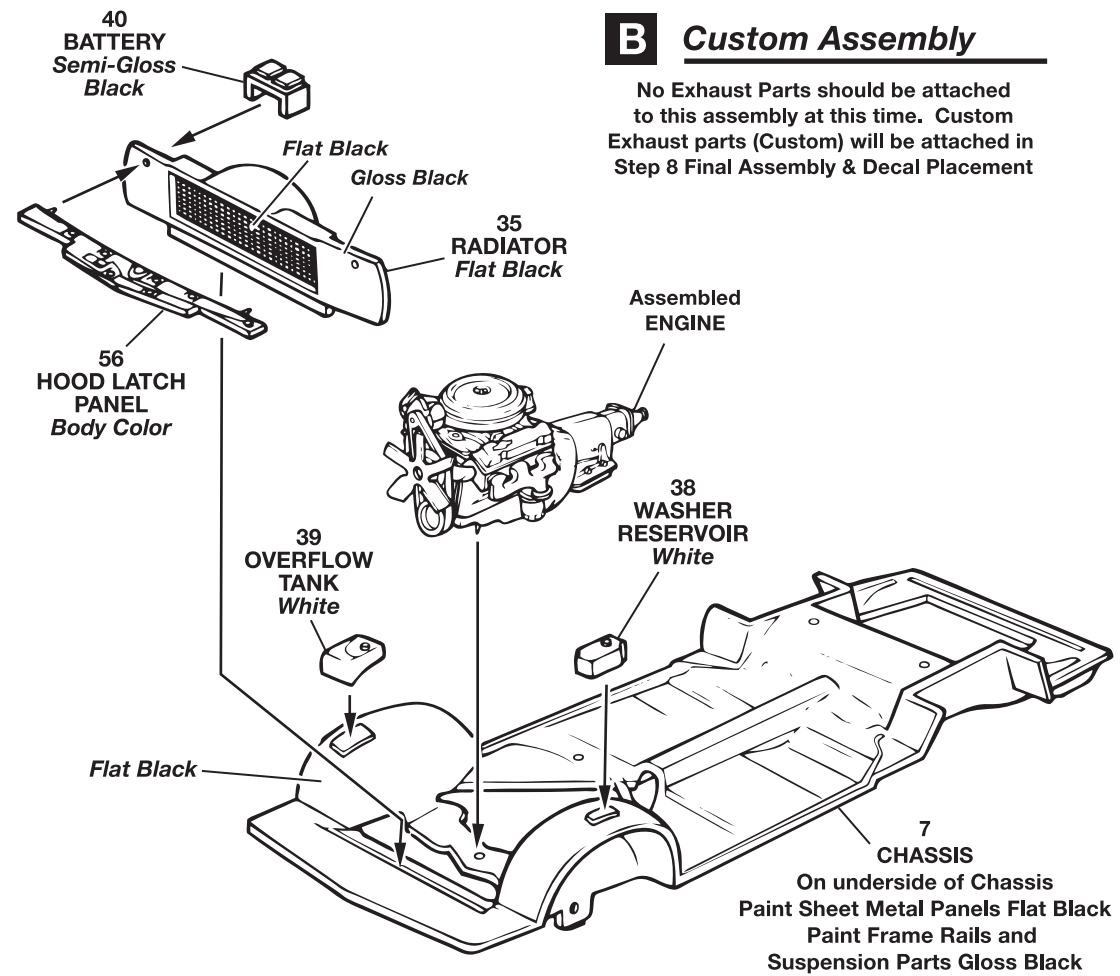

8

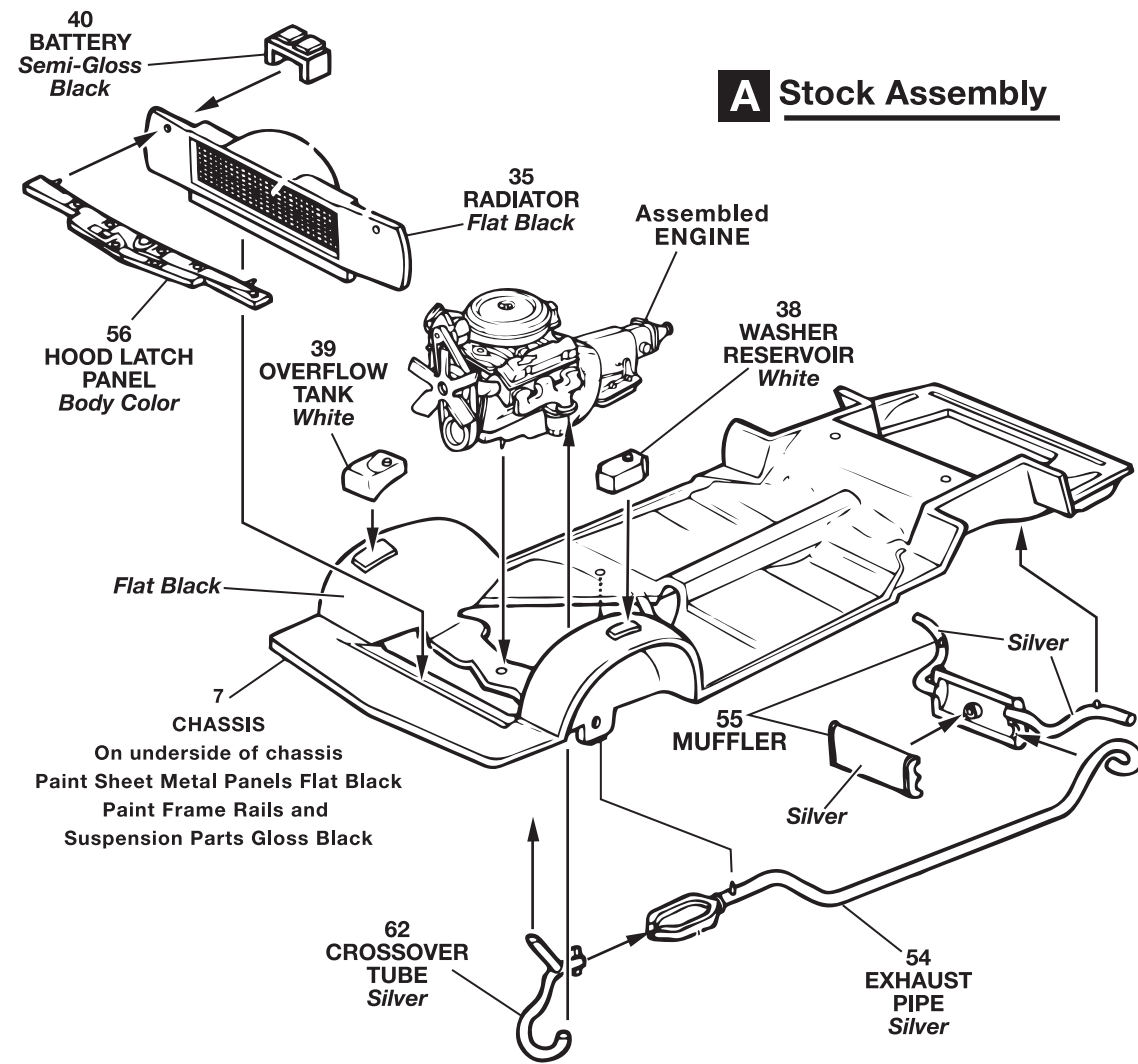
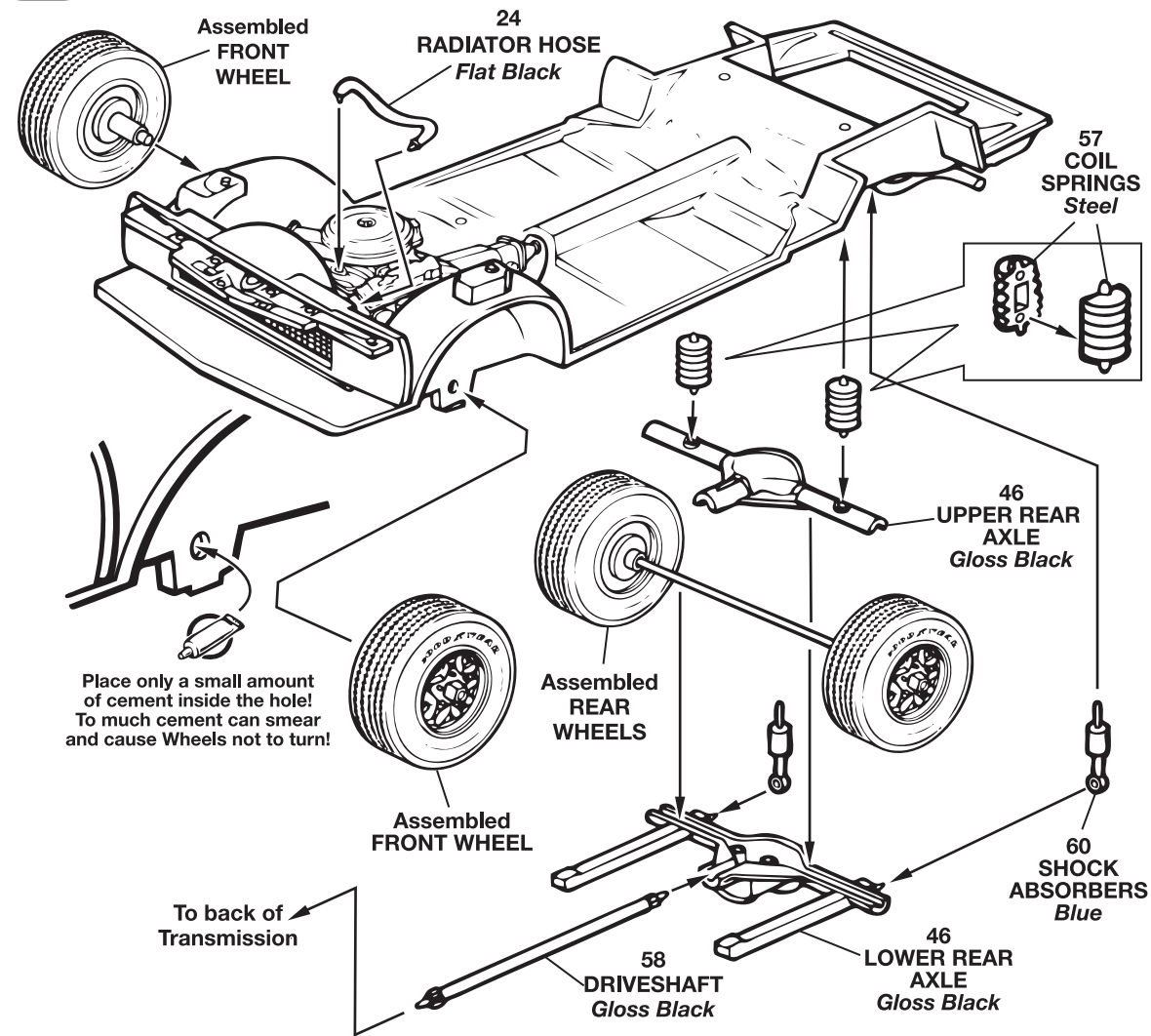

9

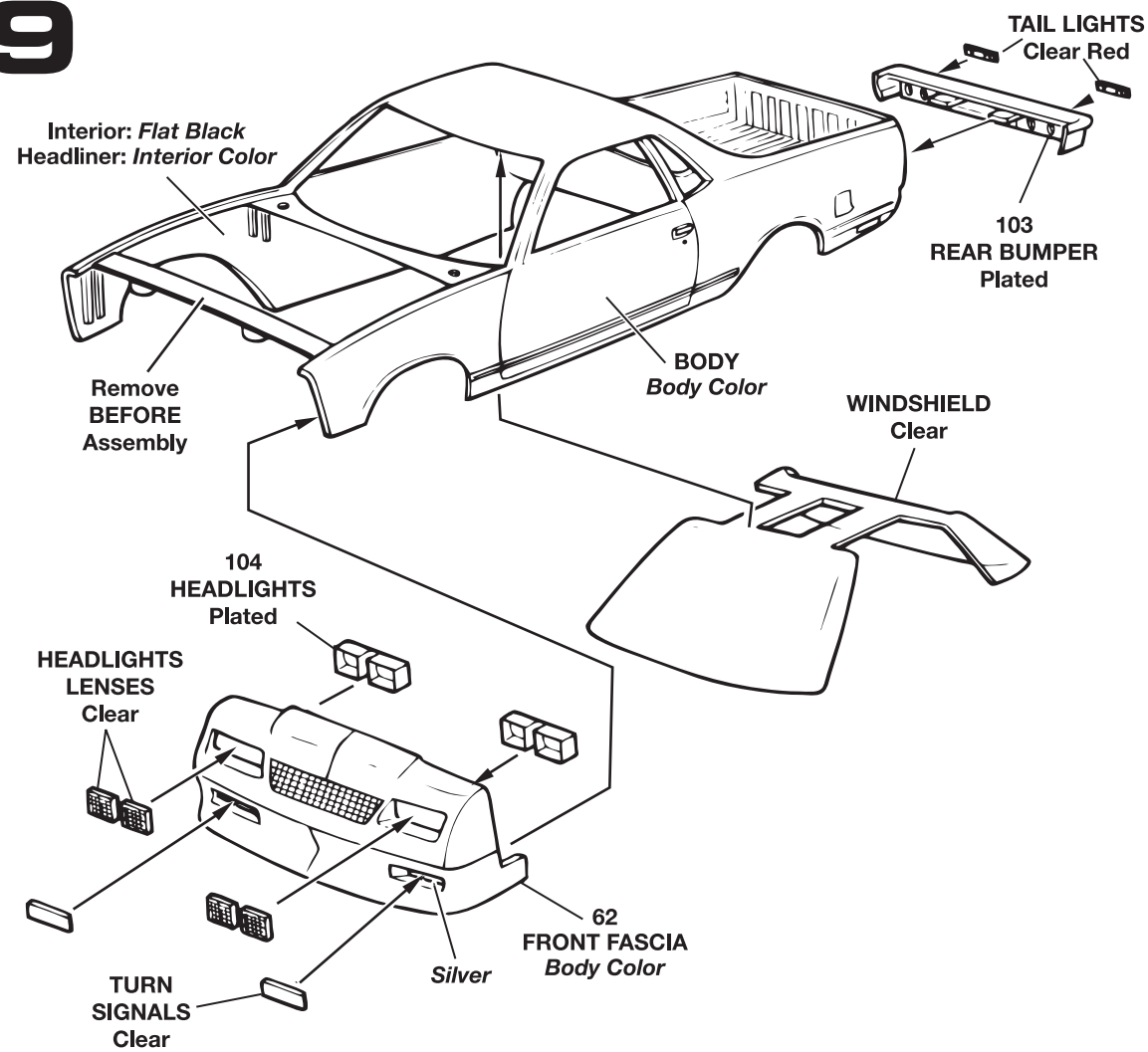

10

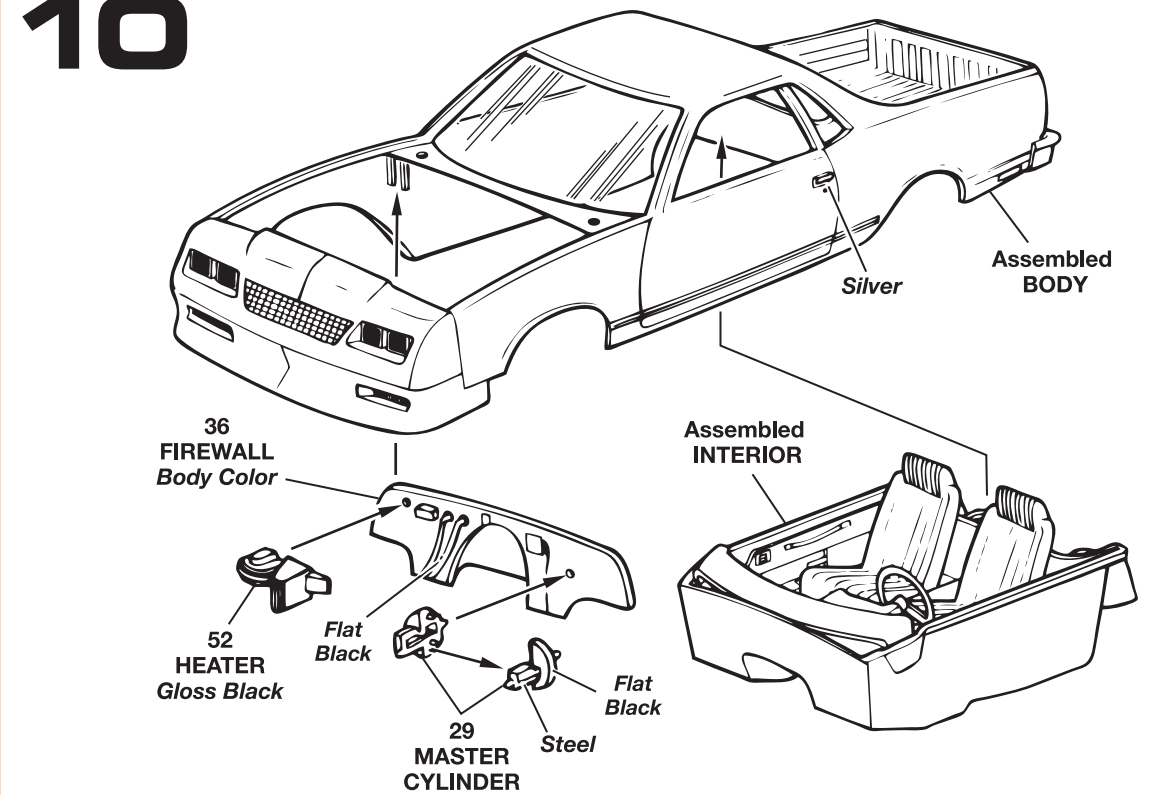

11

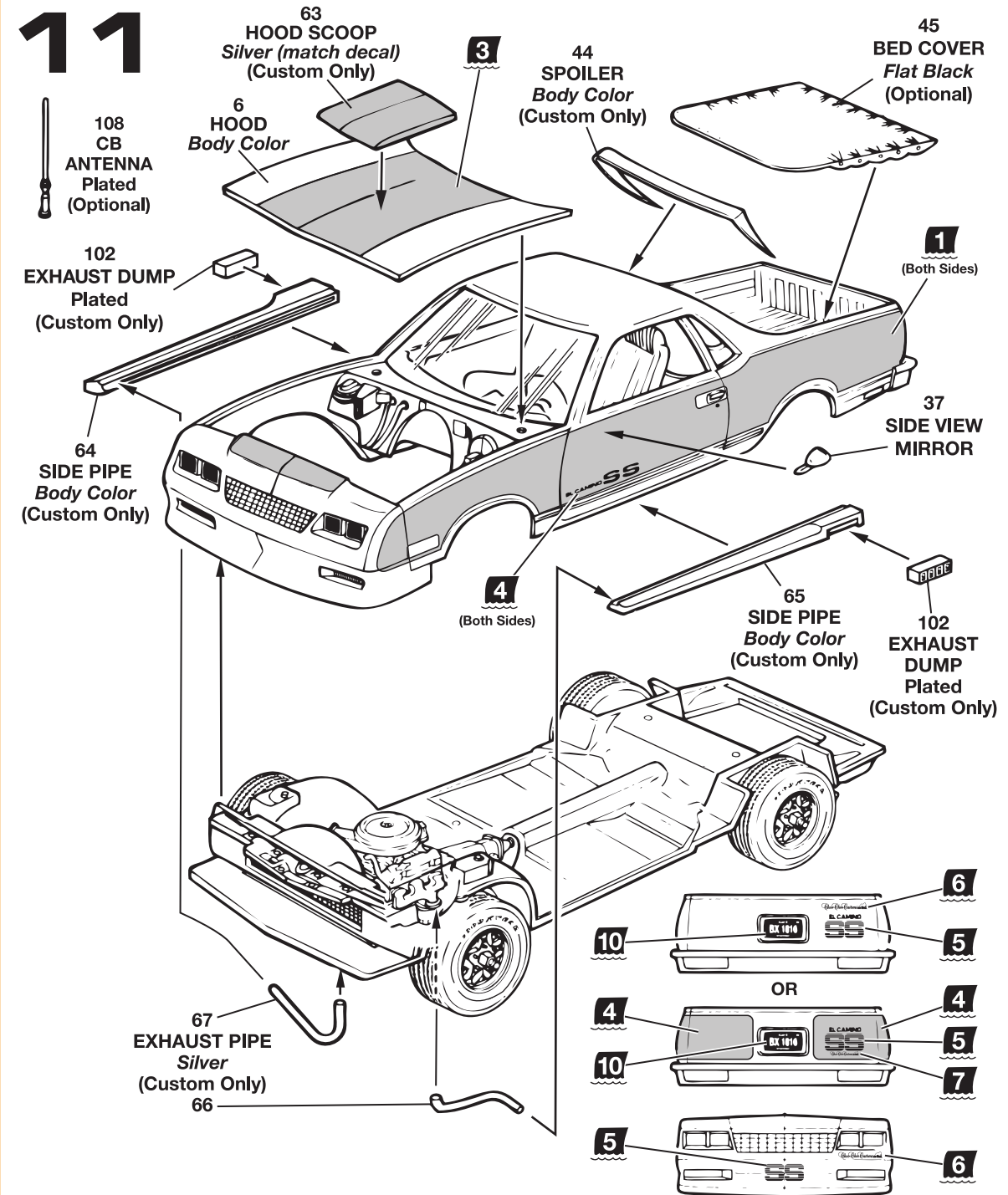

1986 CHEVY
EL CAMINO SS
WITH
TRAIL BIKE

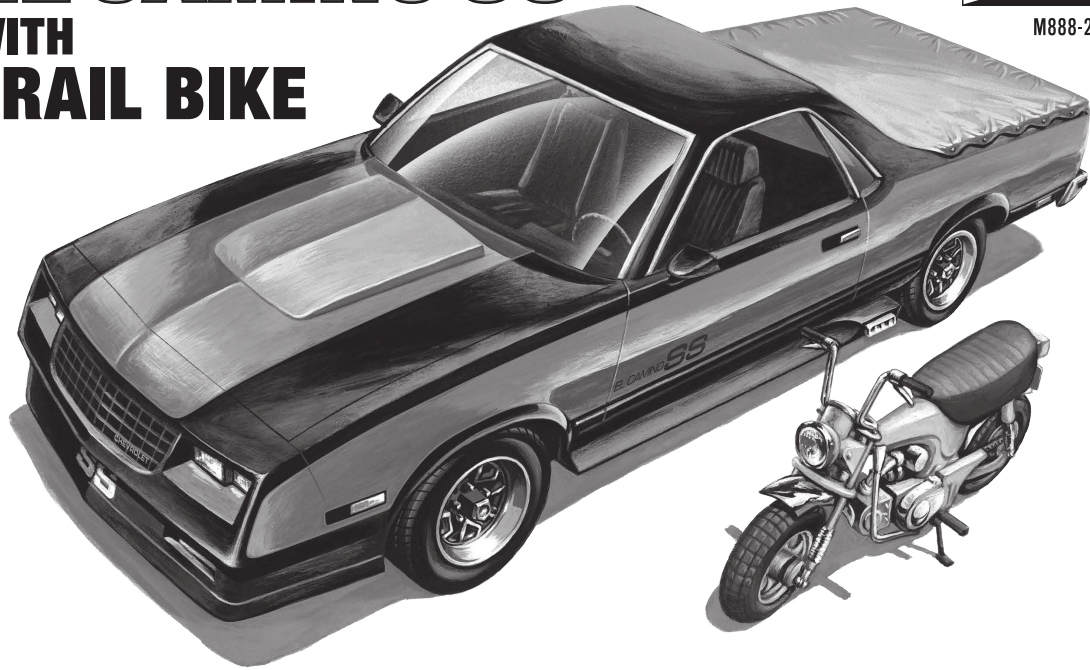

IMPORTANT! READ THESE INSTRUCTIONS FIRST

Before you begin building, look over the instructions carefully. Following the procedure given, test-fit parts together without cementing. This way you will be more familiar with the location of parts when it becomes time to use cement.

For removing small parts from the “runners” it is best to use a modelers knife, do not attempt to “twist” them off.

The highest quality styrene plastic goes into the making of each MPC® model. Only cement and paint designed for styrene plastic should be used. Before joining parts,

trim off excess plastic or “flash.” Scrape plating from chromed parts where they are to be joined with other parts. Be careful not to get cement on exposed areas. To join parts, use cement sparingly. Apply cement to very small parts with a toothpick.

When painting your model it is best to cement all non-chromed accessories to the body and paint the whole unit at one time. You should have no trouble assembling your kit if the instructions are followed properly.

- 7 Part number
- 11 Apply Decal
- ➔ Cement
- Do not cement

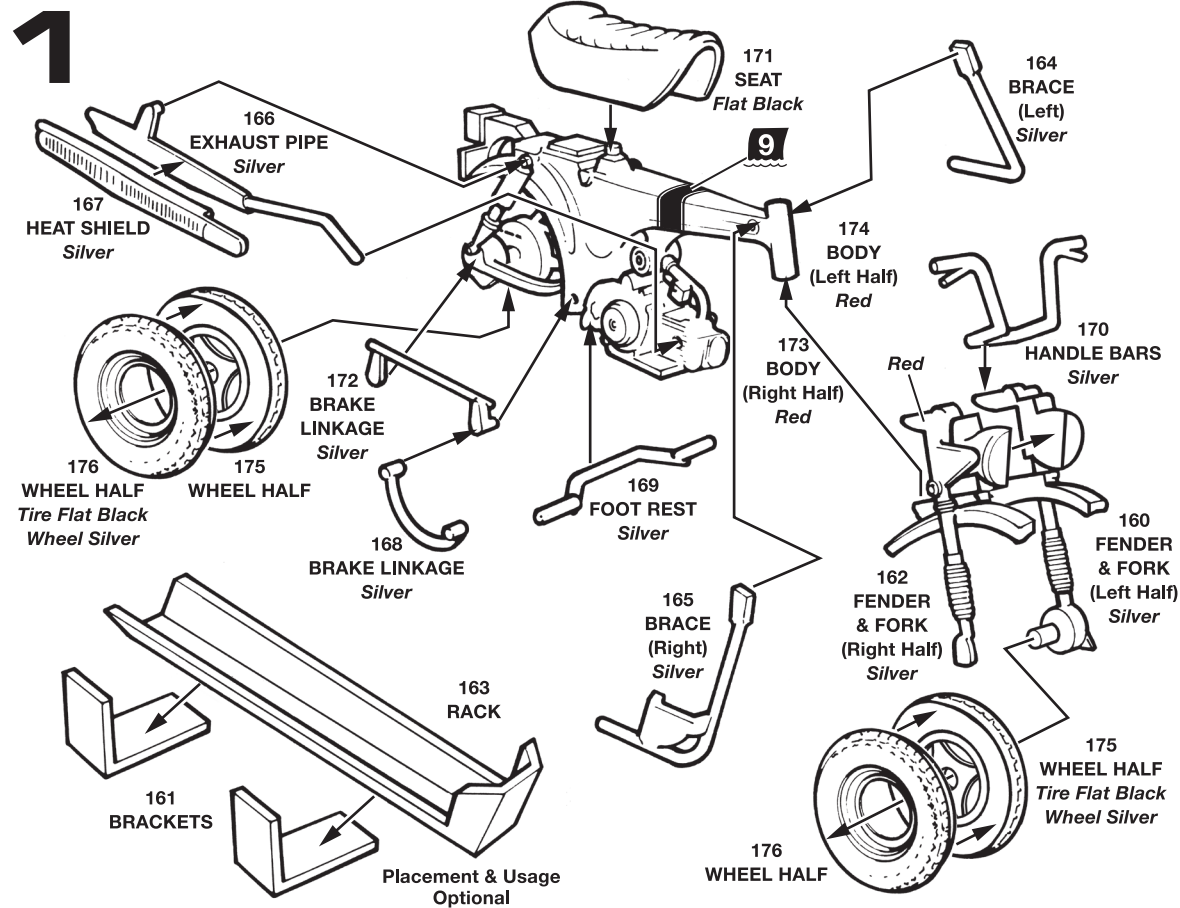

Round 2, LLC.
4073 Meghan Beeler Court
South Bend, IN 46628

International Hobbcraft (UK) Ltd.
10 Temple Back
Bristol BS1 6FL England

round2models.com
collectormodel.com

GENERAL MOTORS Trademarks used under license to Round 2, LLC. Goodyear (and wing foot design) and Eagle are trademarks of The Goodyear Tire & Rubber Company, Akron, Ohio USA used under license by Round 2, LLC. MPC is a registered trademark of Round 2, LLC. ©2018 Round 2, LLC, South Bend, IN 46628 USA. Product and packaging designed in the USA. Made in China. All rights reserved.

2

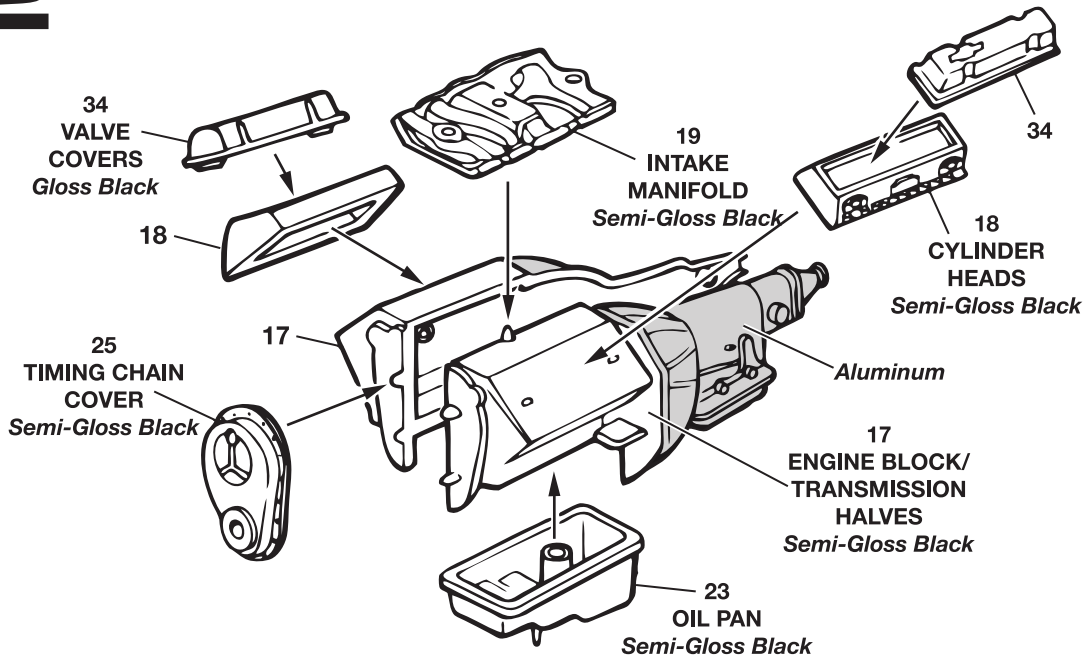

3

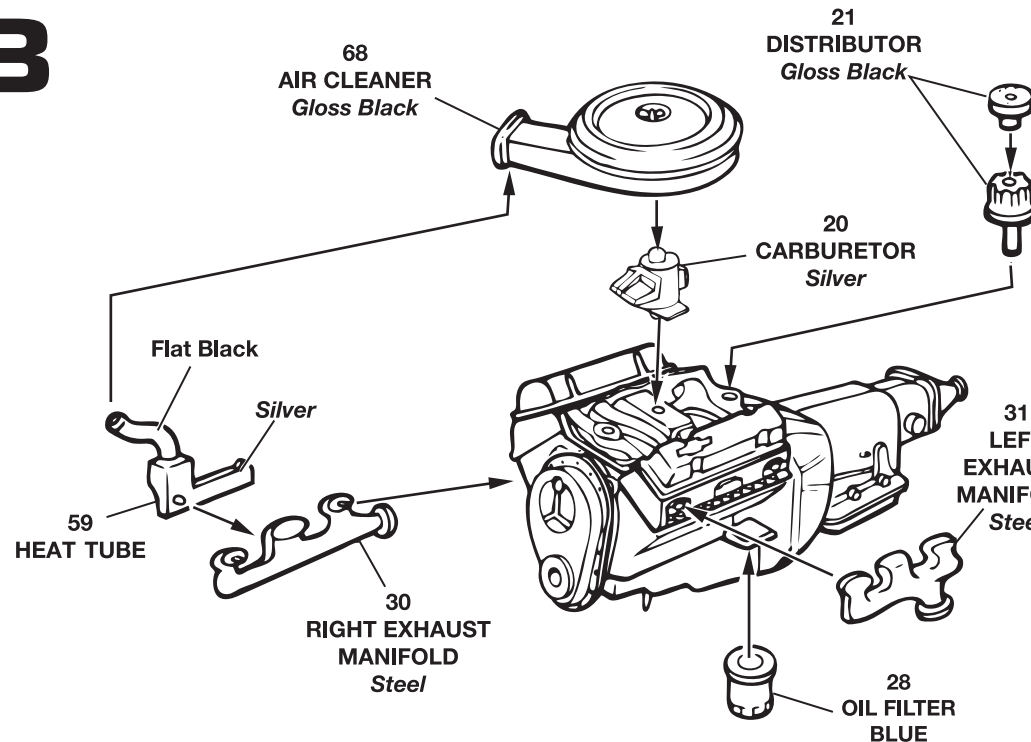

4

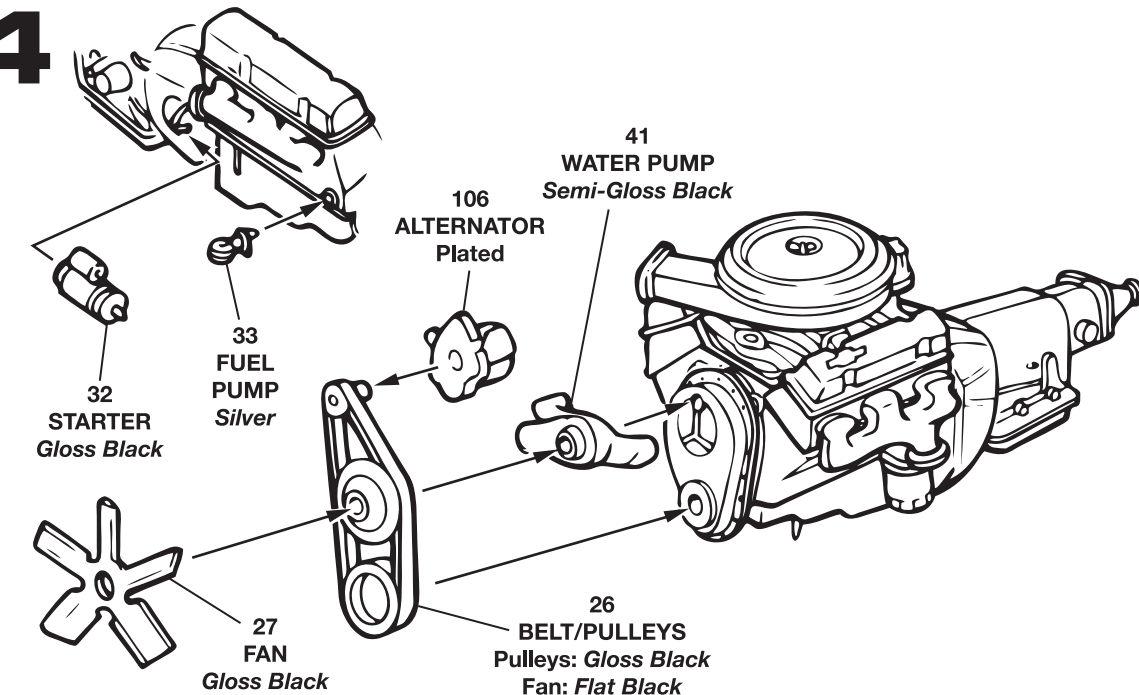

5

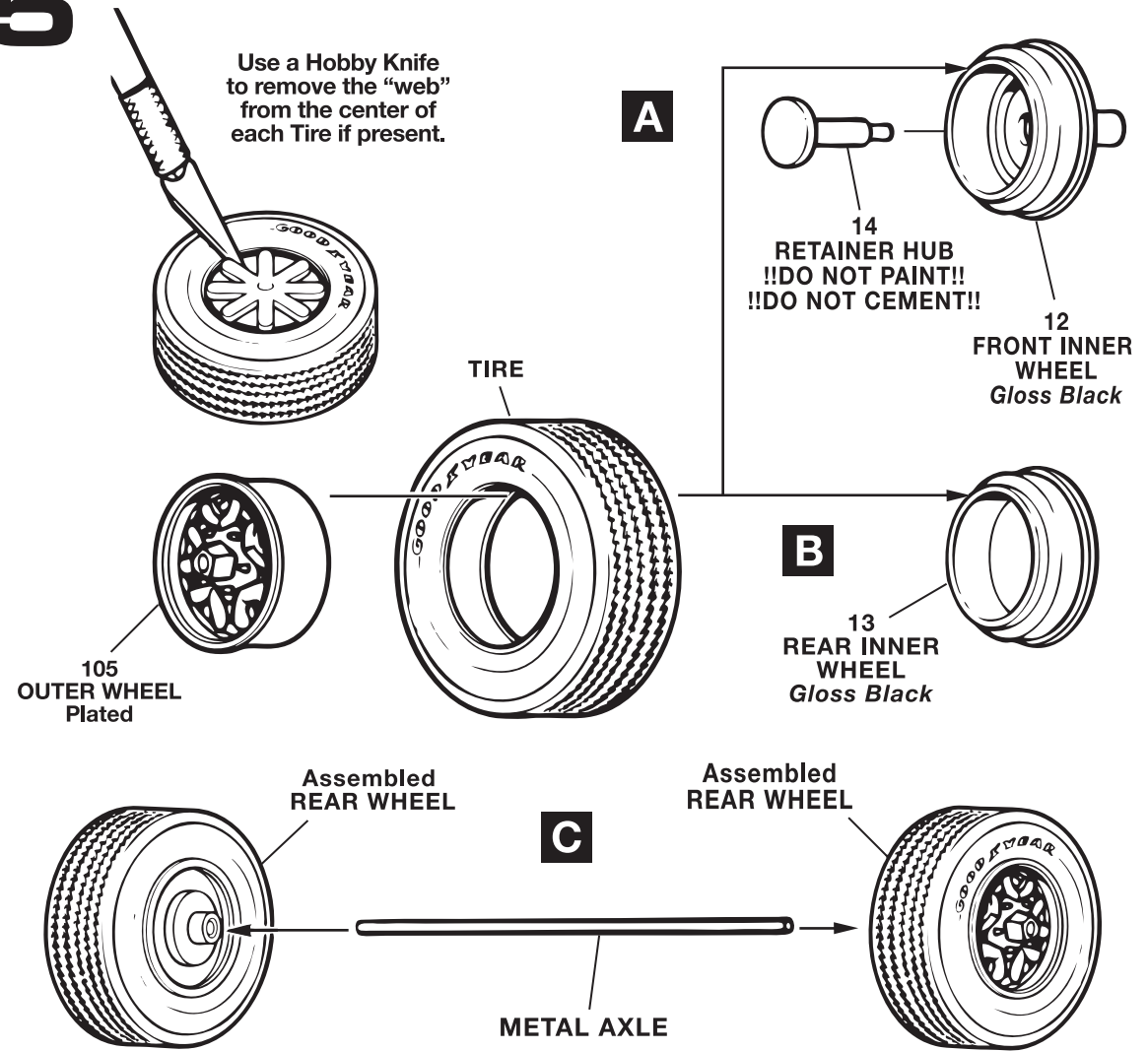

6

