

STING-RAY SEAT WITH SHOCK  
ABSORBING STRUTS.

See **ADVANCED MODELING SEAT OPTION**  
section 17 for details on creating an optional  
Schwinn "S-Stripe" seat using the supplied  
bonus decals!

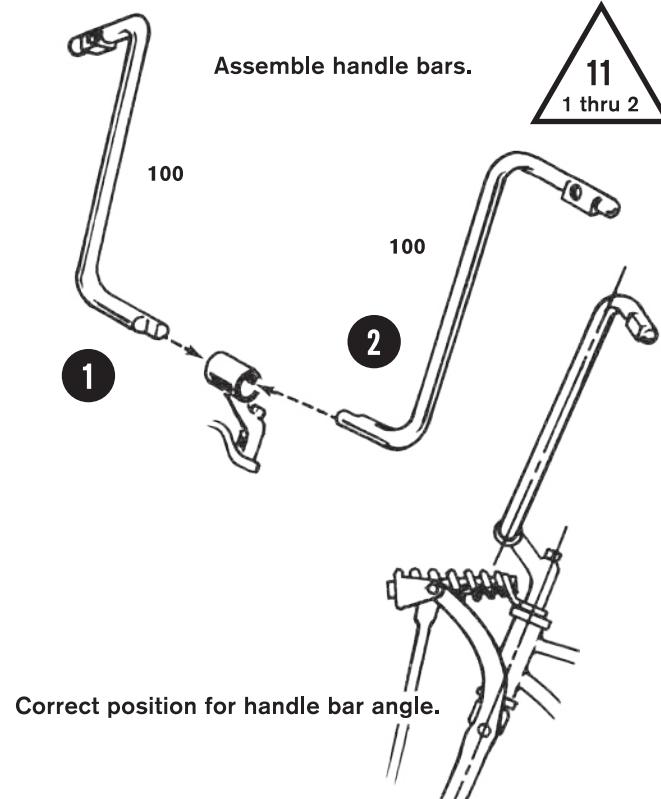
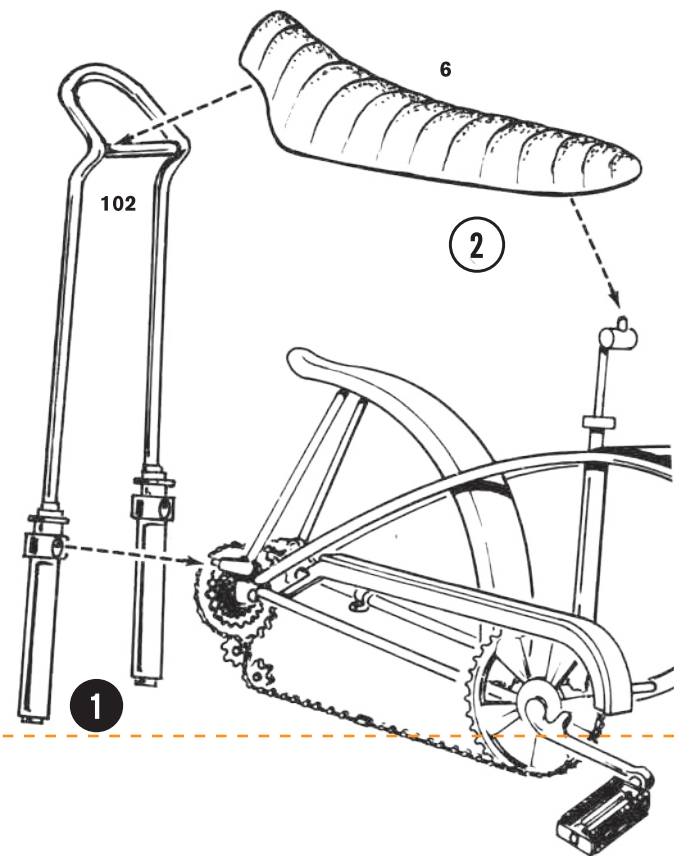

Correct position for handle bar angle.

**OPTION**

10  
1 thru 2 1 thru 4

CUSTOM HIGH RISE SISSY BAR WITH HIGH  
BACK BANANA SEAT.

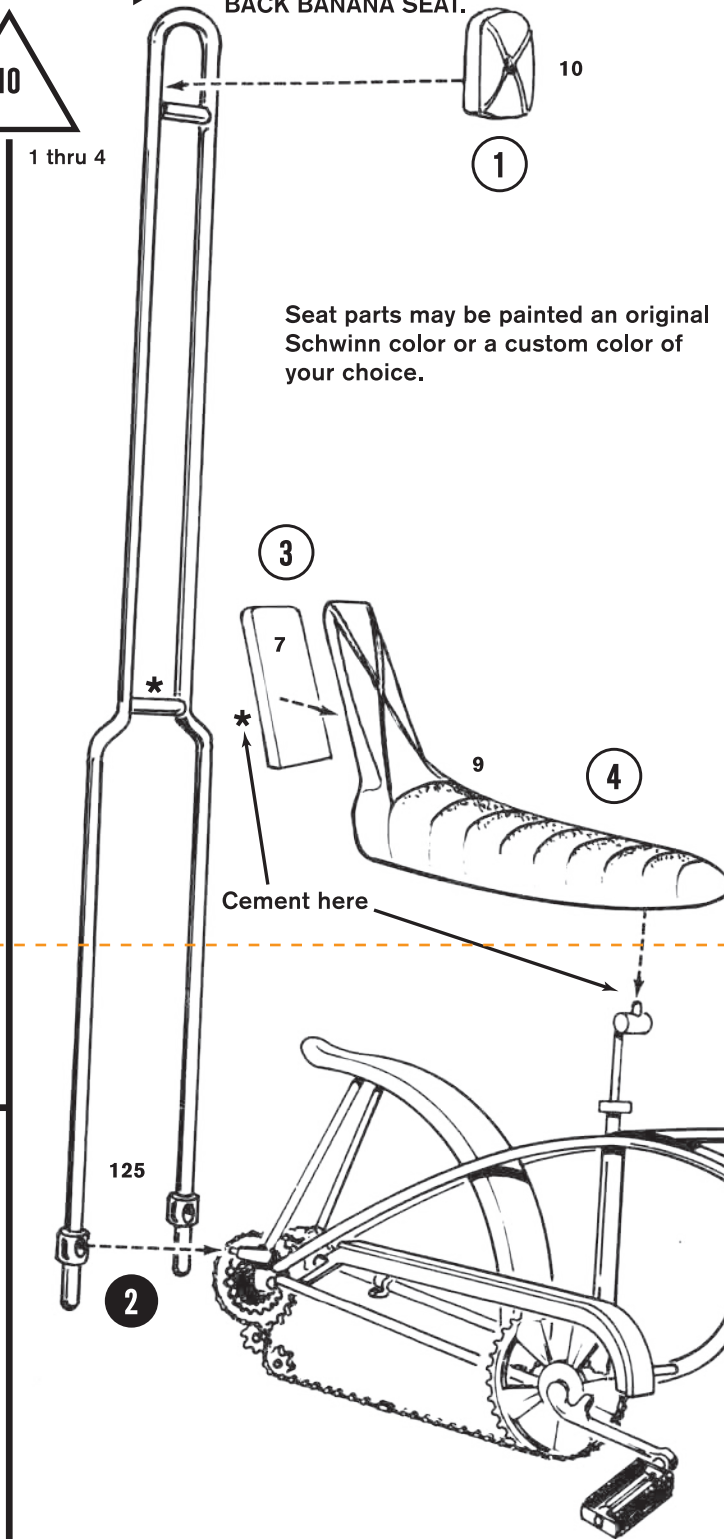

Seat parts may be painted an original  
Schwinn color or a custom color of  
your choice.

Cement here

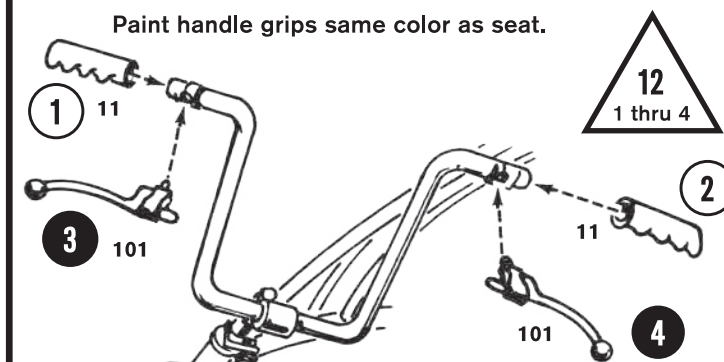

Paint handle grips same color as seat.

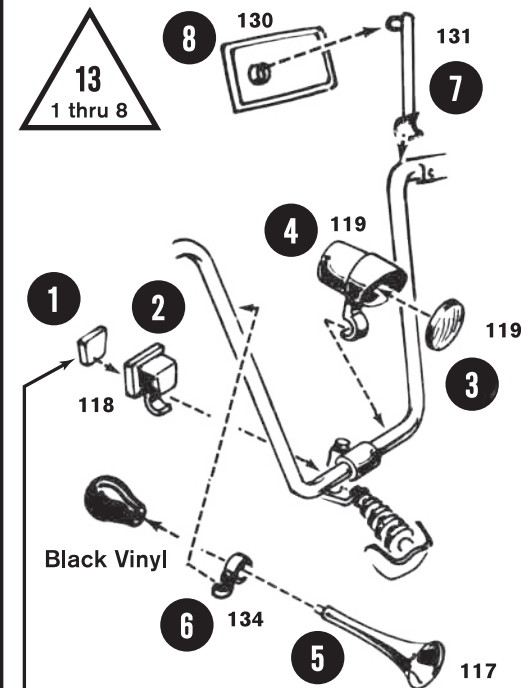

Speedometer may be painted or sanded  
smooth so decal #2 can be used. See STEP 16.

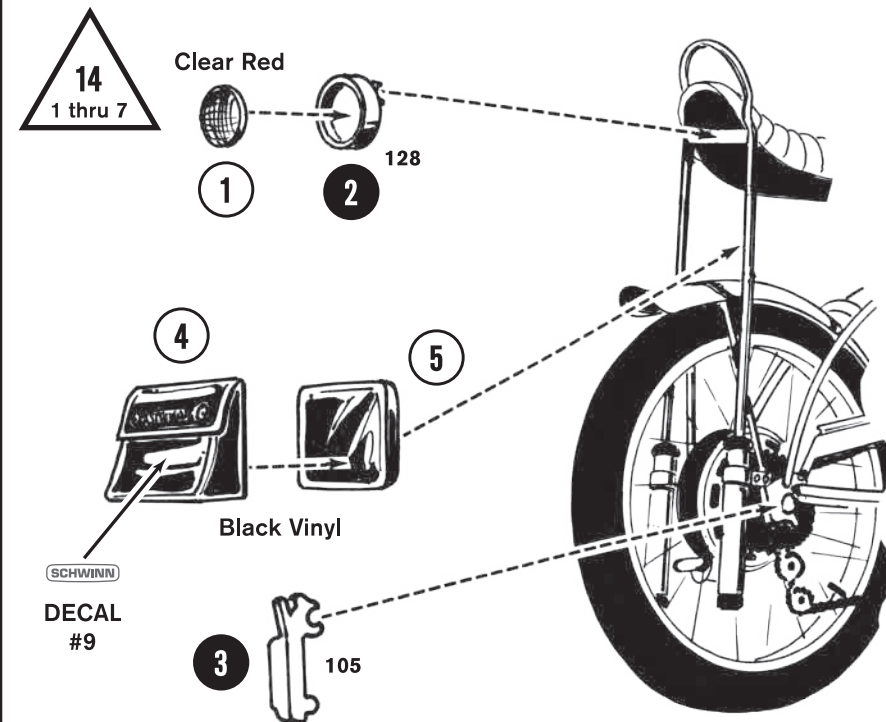

CUT VINYL TUBING TO SIZES SHOWN.

A SPEEDOMETER

B FRONT DRUM BRAKE

C SHIFT CABLE

D REAR DISC BRAKE

CABLE HOOK-UP ASSEMBLY

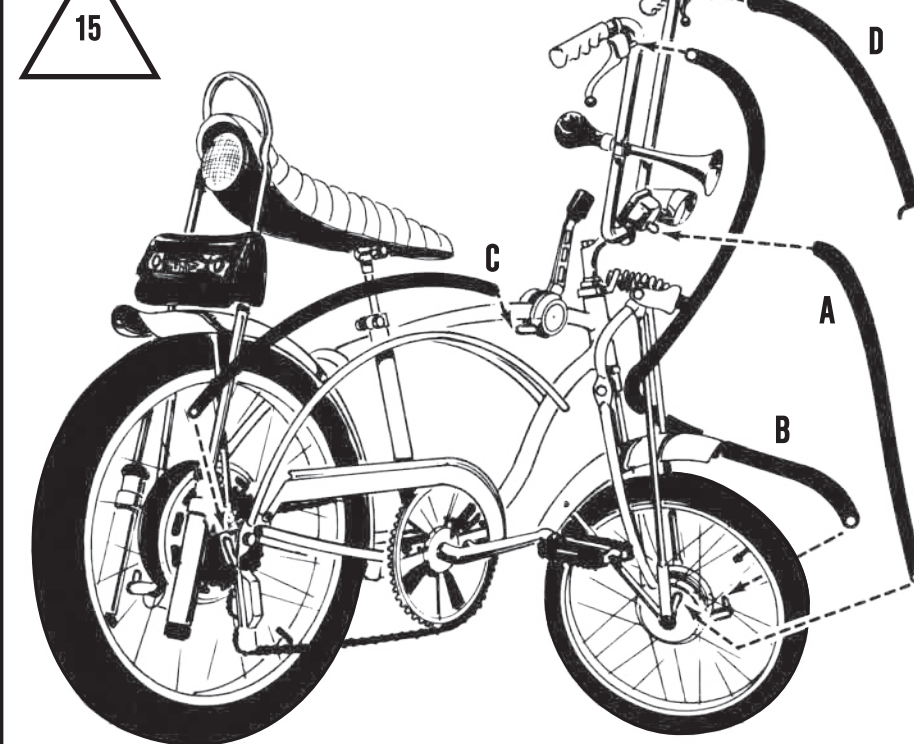

Install vinyl tubing to locating  
pins as shown.

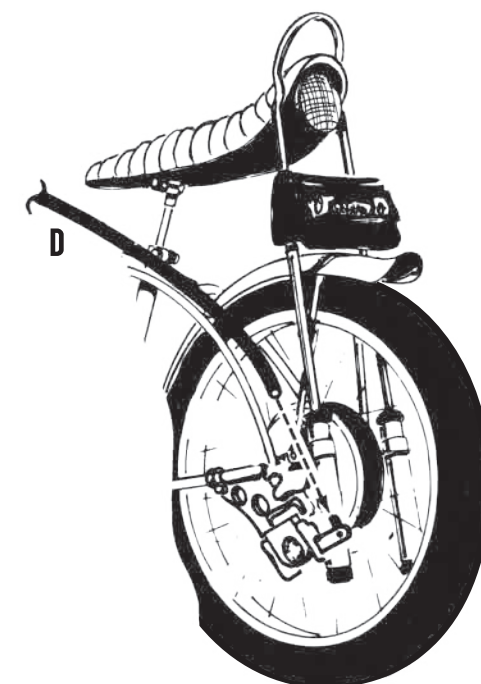

FINISHING DECALS

16  
1 thru 9

**BONUS DECAL OPTION!**

Schwinn chain guard name logos for  
several popular "Krate" colors have been  
included. Install your choice!

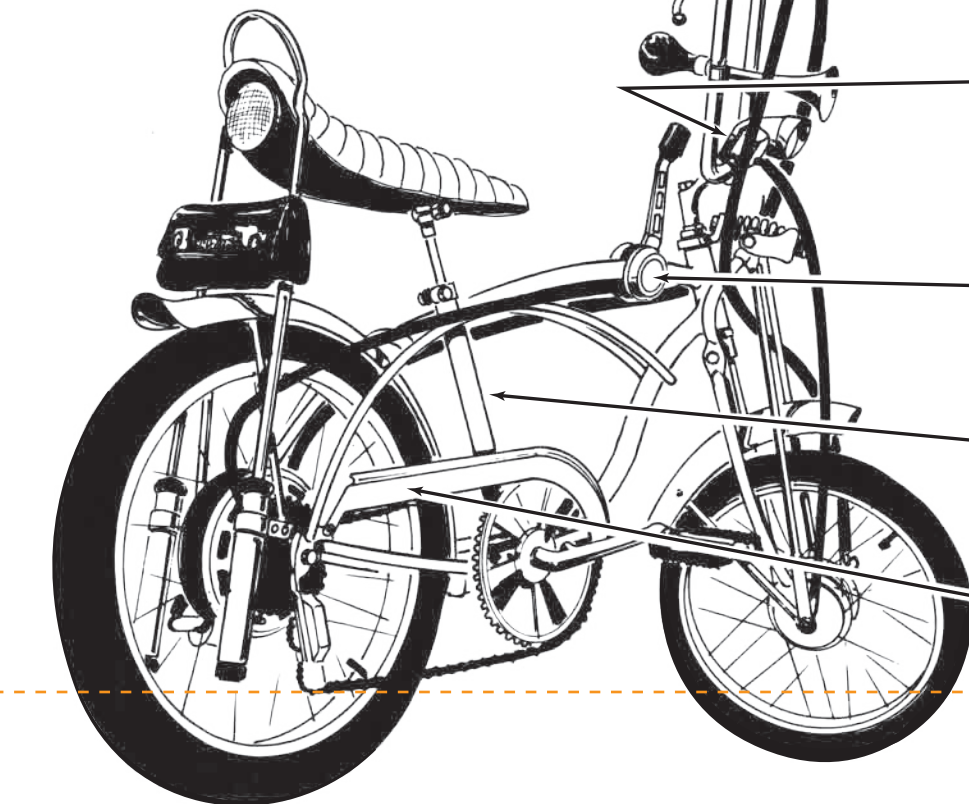

#3

OPTION: Cut out the  
Sting-Ray badge and  
apply it without the  
checkerboard.

#2

#6

#7

#10 **OPTION**

Schwinn *Sting-Ray* "ORANGE KRATE"

Schwinn *Sting-Ray* "APPLE KRATE"

Schwinn *Sting-Ray* "LEMON PEELER"

Schwinn *Sting-Ray* "GREY GHOST"

ADVANCED MODELING OPTION

17

Using modeler's putty, fill the grooves in the standard Sting-Ray seat. Sand smooth to create a uniform  
surface. Paint the seat with a metallic color to simulate the vintage "sparkle" vinyl appearance. Then,  
apply one of the "S-Stripe" decals to add the finishing touch!

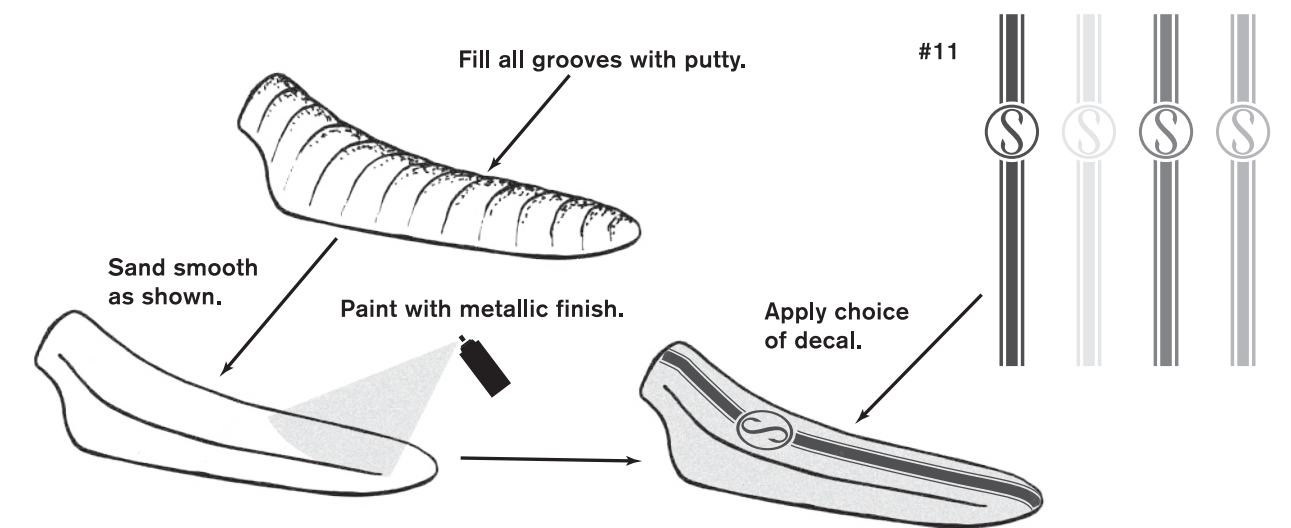

Sand smooth  
as shown.

Paint with metallic finish.

Apply choice  
of decal.

#11



Big 1/8 Scale

AUTHENTIC ASSEMBLY KIT

M

914-200

Schwinn

STING-RAY

READ THIS BEFORE YOU BEGIN

Before you begin building, look over the instructions carefully. Following the procedure given, test fit parts together without cementing. This way you will be more familiar with the location of parts when it becomes time to use cement.

For removing small parts from the “runners” it is best to use a modeler’s knife. Do not attempt to “twist” them off.

The highest quality styrene plastic goes into the making of each MPC model. Only paint and cement for styrene should be used. Before joining parts, trim off excess plastic or “flash.” Scrape plating from chromed parts where they are to be joined to other parts. Be careful not to get cement on exposed areas. To join parts use cement sparingly. Apply cement to small parts with a toothpick.

When painting your model it is best to cement all non-chromed accessories to the body and paint the whole unit at one time.

You should have no trouble assembling your kit if the instructions are followed properly. The parts are numbered in order of assembly.

NON PLATED PARTS

PLATED PARTS

PART NUMBERS

©2019 Pacific Cycle Inc. All rights reserved. Schwinn®, Sting-Ray®, Apple Krate®, Grey Ghost®, Lemon Peeler®, Orange Krate®, and Sting-Ray® are trademarks of Pacific Cycle, used under license. MPC and design and Round 2 and design are registered trademarks of Round 2, LLC. ©2019 Round 2, LLC, South Bend, IN 46628 USA. Product made in USA. Printed in China.

1 thru 6

a

FRONT

121

129

120

129

120

Black Vinyl

Remove center from tires with modeler's knife then locate to rim.

1 thru 6

b

REAR

122

123

124

Black Vinyl

2 thru 6

3

Frame may be painted in this step.

1

2

106

6

4

Paint chain FLAT BLACK.

5

Locate chain and sprocket through frame as shown.

Before cement dries, line up holes indicated by \*

3 thru 5

3

1 thru 5

Do not cement fender brace.

4

104

2

Do not cement.

5

111

1

Locate kickstand to retainer when model is completed.

4 thru 2

4

1 thru 2

103

2

1

Hold frame as shown with fender brace in place, locate fender then cement contact points.

5 thru 2

5

1 thru 2

2

1

Paint rubber cushion on foot pedals FLAT BLACK.

6 thru 2

6

1 thru 2

109

2

1

DECALS #8

7 thru 2

7

1 thru 2

113

1

Do not cement.

DECAL #1

Detail of position.

2

126

See illustration in step 9 for location detail.

8 thru 3

8

1 thru 3

3

Cement here only.

114

115

2

1

Do not cement.

9 thru 7

9

1 thru 7

DECAL OPTION #4 To top of shifter.

108

Do not cement.

4

6

107

DECAL #5

5

5

Contoured to fit on frame.

1

116

Locate inside.

7

127

2

NOTE: Pin locates to hole.

3

112